

# LAKE SURVEY MAP

← Cecil 2 miles 15 14  
22 23

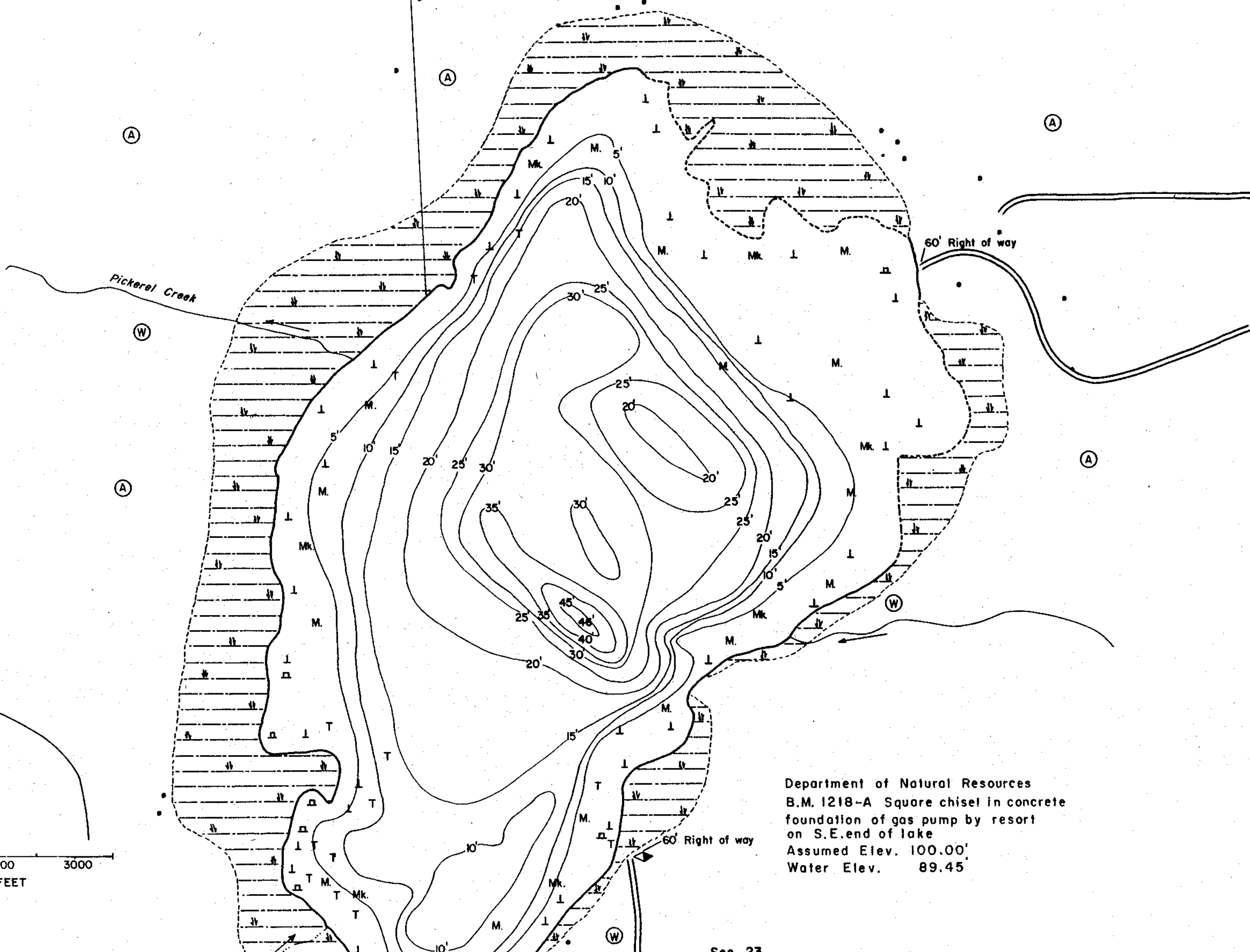
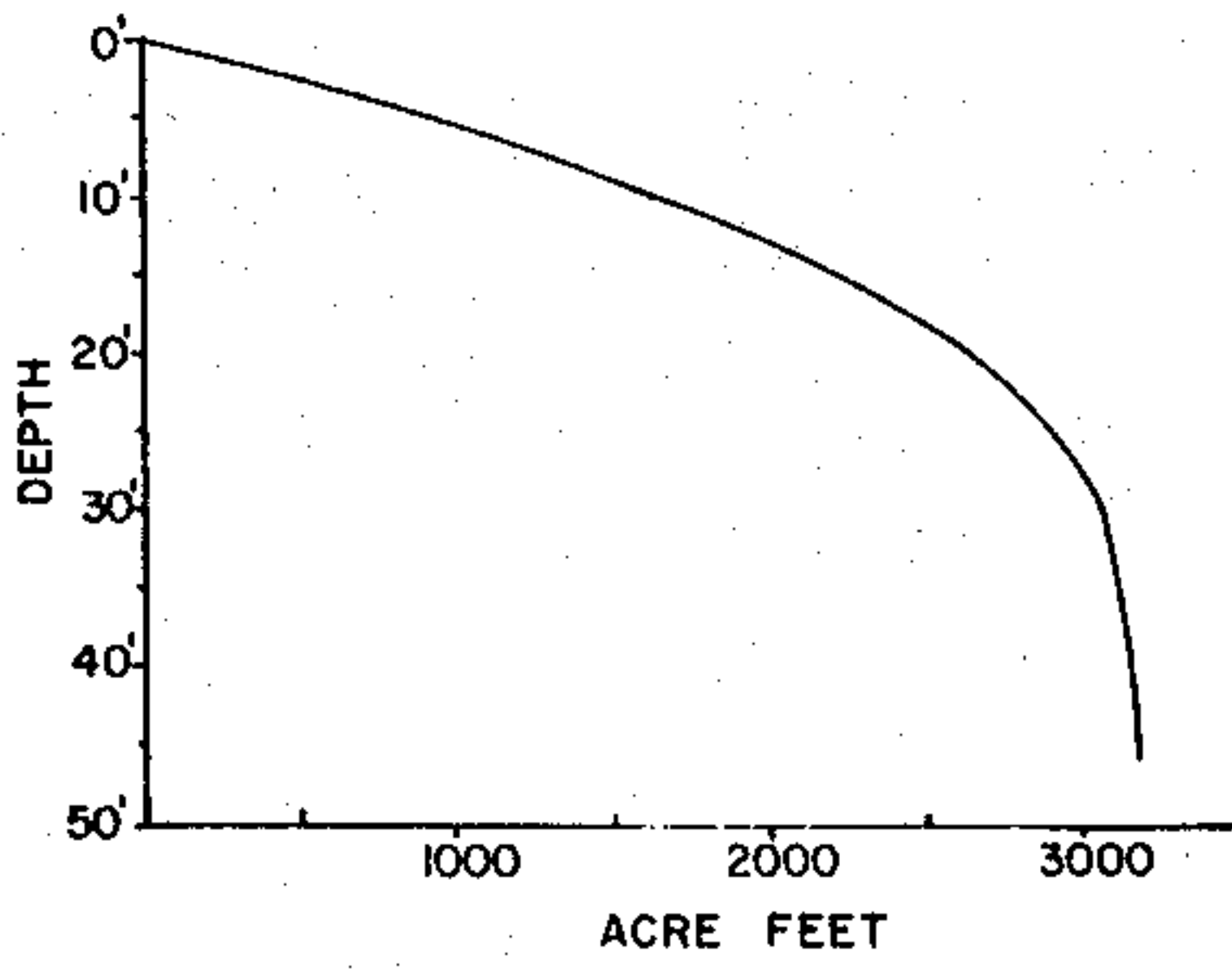

Department of Natural Resources  
B.M. 1218-A Square chisel in concrete  
foundation of gas pump by resort  
on S.E. end of lake  
Assumed Elev. 100.00'  
Water Elev. 89.45'

EQUIPMENT RECORDING SONAR MAPPED JUNE 1967  
MONTH YEAR

- TOPOGRAPHIC SYMBOLS**
- (B) Brush
  - (PW) Partially wooded
  - (W) Wooded
  - (C) Cleared
  - (P) Pastured
  - (A) Agricultural
  - B.M. Bench Mark
  - Dwelling
  - Resort
  - ⊠ Camp
  - ||||| Steep slope
  - ~ Indefinite shoreline
  - Marsh
  - Spring
  - Intermittent stream
  - Permanent inlet
  - Permanent outlet
  - Dam
  - D.N.R. State owned land

- LAKE BOTTOM SYMBOLS**
- P. Peat
  - Mk. Muck
  - C. Clay
  - M. Marl
  - Sd. Sand
  - St. Silt
  - Gr. Gravel
  - R. Rubble
  - Bc. Bedrock
  - B Boulders
  - Stumps & Snags
  - Rock danger to navigation
  - Submergent vegetation
  - Emergent vegetation
  - Floating vegetation
  - Brush shelters

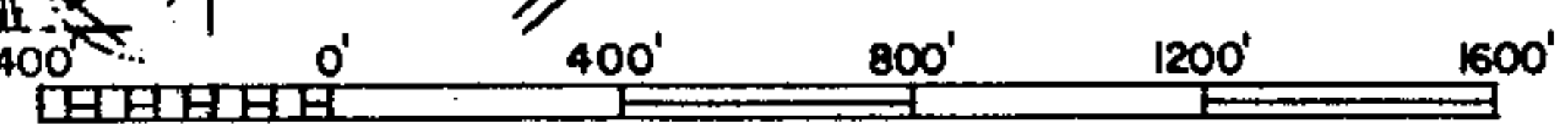

◆ Access    ◆ Access with Parking    ◆ Boat Livery  
Drawn by: C. Holt  
Field work by: P. Michelson

SPECIES OF FISH	ABUNDANCE	
	Abundant	Common
Muskie		
N. Pike	X	
Walleye	X	
L.M. Bass	X	
S.M. Bass		
Panfish	X	
Trout		

WATER AREA 234.1 ACRES  
 UNDER 3 FT. 20.6 %  
 OVER 20 FT. 28.7 %  
 MAX. DEPTH 46 FEET.  
 TOTAL ALK. 165 P.P.M.  
 VOLUME 3165.7 ACRE FT.  
 SHORELINE 2.8 MILES

Source: Wisconsin Department of Natural Resources 608-266-2621  
White Clay Lake – Shawano County, Wisconsin DNR Lake Map  
Date – Jun 1967 - Historical Lake Map - Not for Navigation  
A Public Document - Please Identify the Source when using it.