

LAKE SURVEY MAP

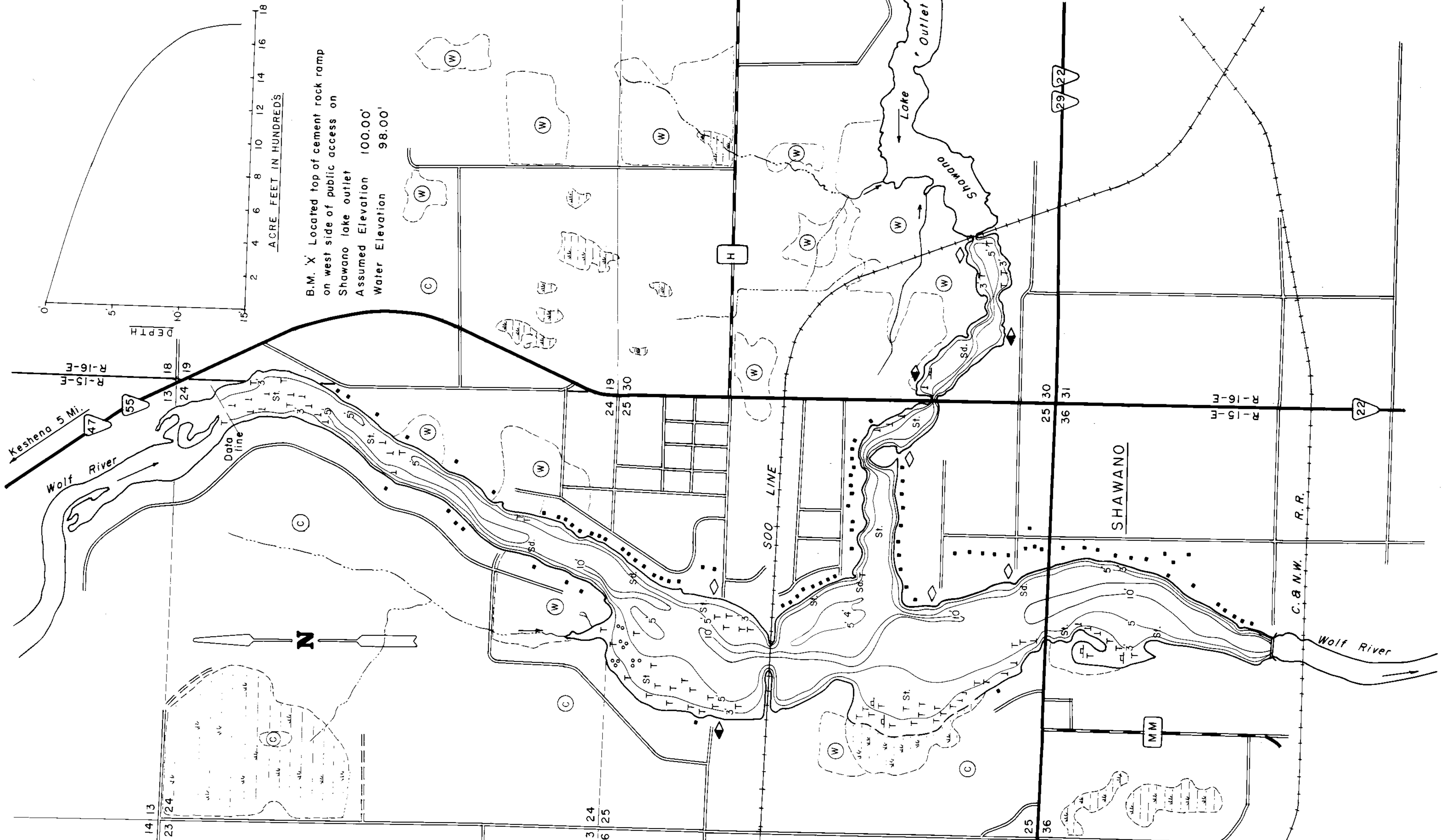

B.M. X Located top of cement rock ramp on west side of public access on Shawano lake outlet
Assumed Elevation 100.00'
Water Elevation 98.00'

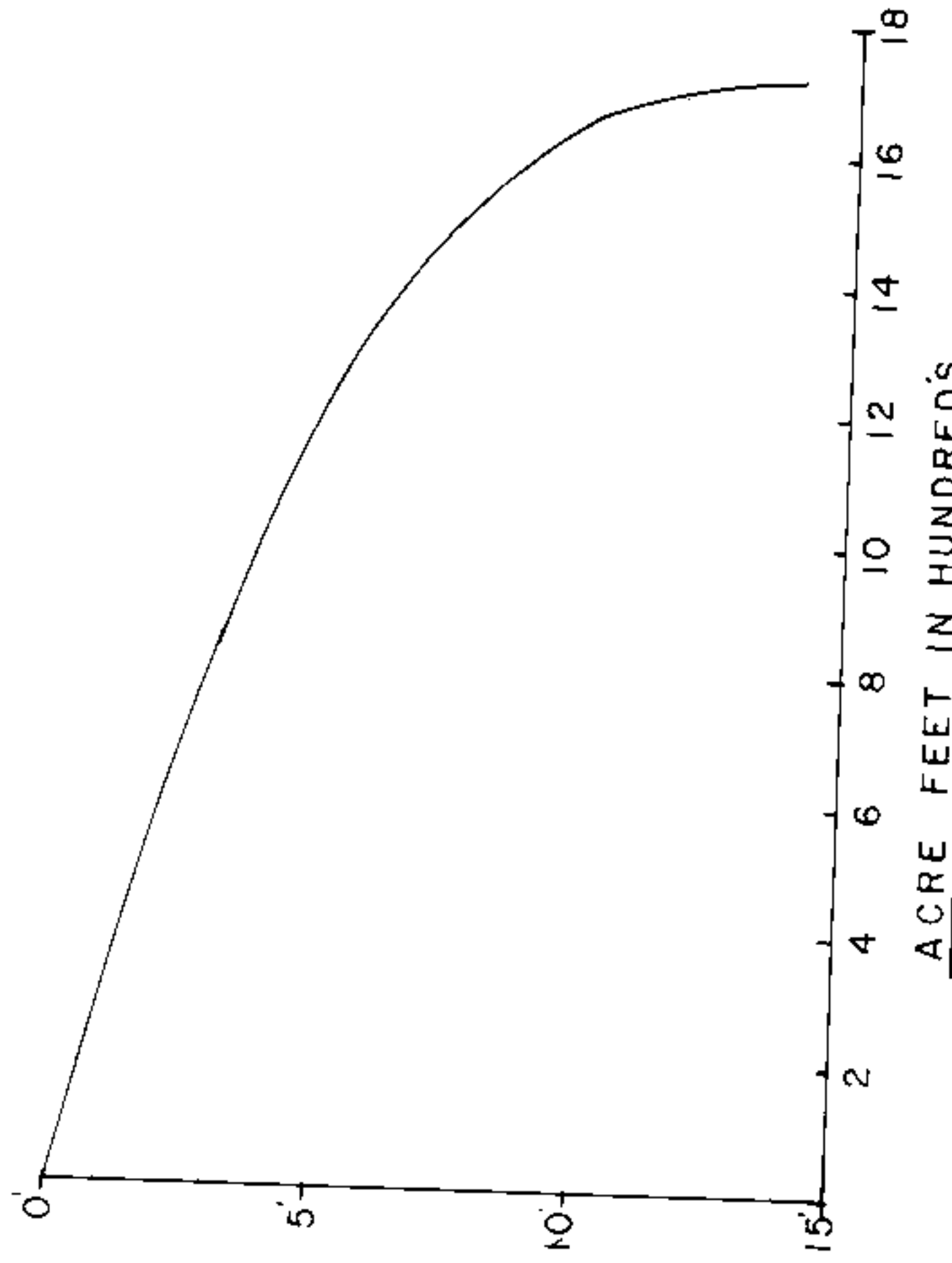

- EQUIPMENT RECORDING SONR MAPPED JULY 1974
MONTH YEAR
LAKE BOTTOM SYMBOLS
- | | | | |
|----------------------------|-------------------------|-------------|---------------------------|
| TOPOGRAPHIC SYMBOLS | | | |
| (B) Brush | Steep slope | P. Peat | B Boulders |
| (PW) Partially wooded | ~ Indefinite shoreline | Mk. Muck | o Stumps & Snags |
| (W) Wooded | Marsh | C. Clay | Rock danger to navigation |
| (C) Cleared | Spring | M. Marl | T Submergent vegetation |
| (P) Pastured | Intermittent stream | Sd. Sand | Emergent vegetation |
| (A) Agricultural | Permanent inlet | St. Silt | Floating vegetation |
| B.M. Bench Mark | Permanent outlet | Gr. Gravel | Brush shelters |
| ■ Dwelling | Dam | R. Rubble | |
| ■ Resort | D.N.R. State owned land | Br. Bedrock | |
| ■ Camp | | | |

SPECIES OF FISH

	Abundant	Common	Present
Muskie			X
N. Pike	X		
Walleye		X	
L.M. Bass	X		
S.M. Bass		X	
Panfish	X		
Trout			

WATER AREA 305 ACRES
 UNDER 3 FT. 18 %
 OVER 20 FT. 0 %
 MAX. DEPTH 14 FEET.
 TOTAL ALK. 86 P.P.M.
 VOLUME 1,715.84 ACRE FT.
 MAIN SHORELINE 8.15 MI.
 ISLAND SHORELINE MI.

Access Access with Parking Boat Livery
 Drawn by: E. Eaton
 Field work by: D. Boese, R. Thurn

Source: Wisconsin Department of Natural Resources 608-266-2621
Wolf River Pond – Shawano County, Wisconsin DNR Lake Map
Date – Jul 1974 - Historical Lake Map - Not for Navigation
A Public Document - Please Identify the Source when using it.