

LAKE SURVEY MAP

TILLEDA POND
LAKE
SHAWANO COUNTY
SEC. 15 T. 27 N. R. 13 E.

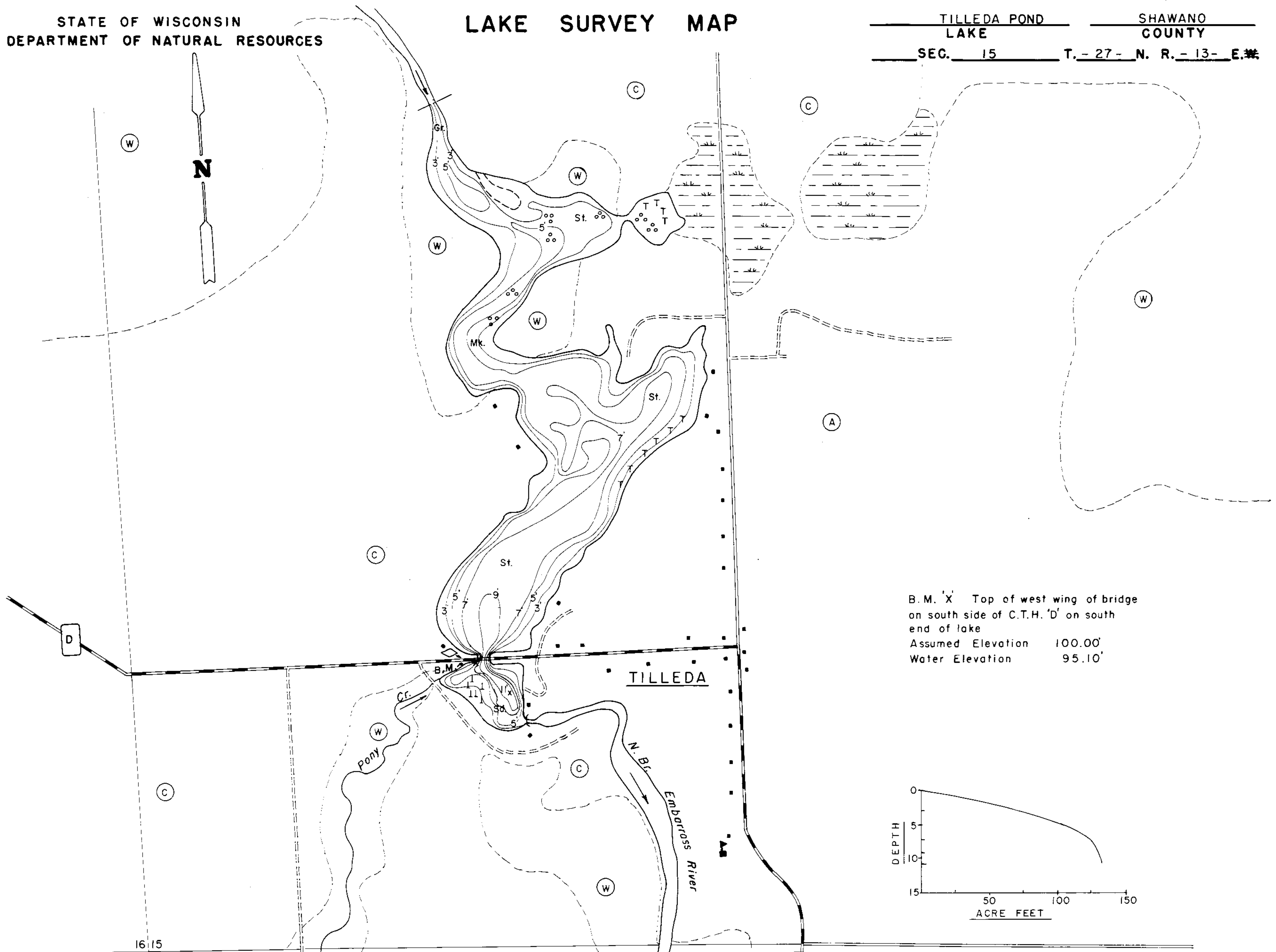

B.M. 'X' Top of west wing of bridge
on south side of C.T.H. 'D' on south
end of lake
Assumed Elevation 100.00'
Water Elevation 95.10'

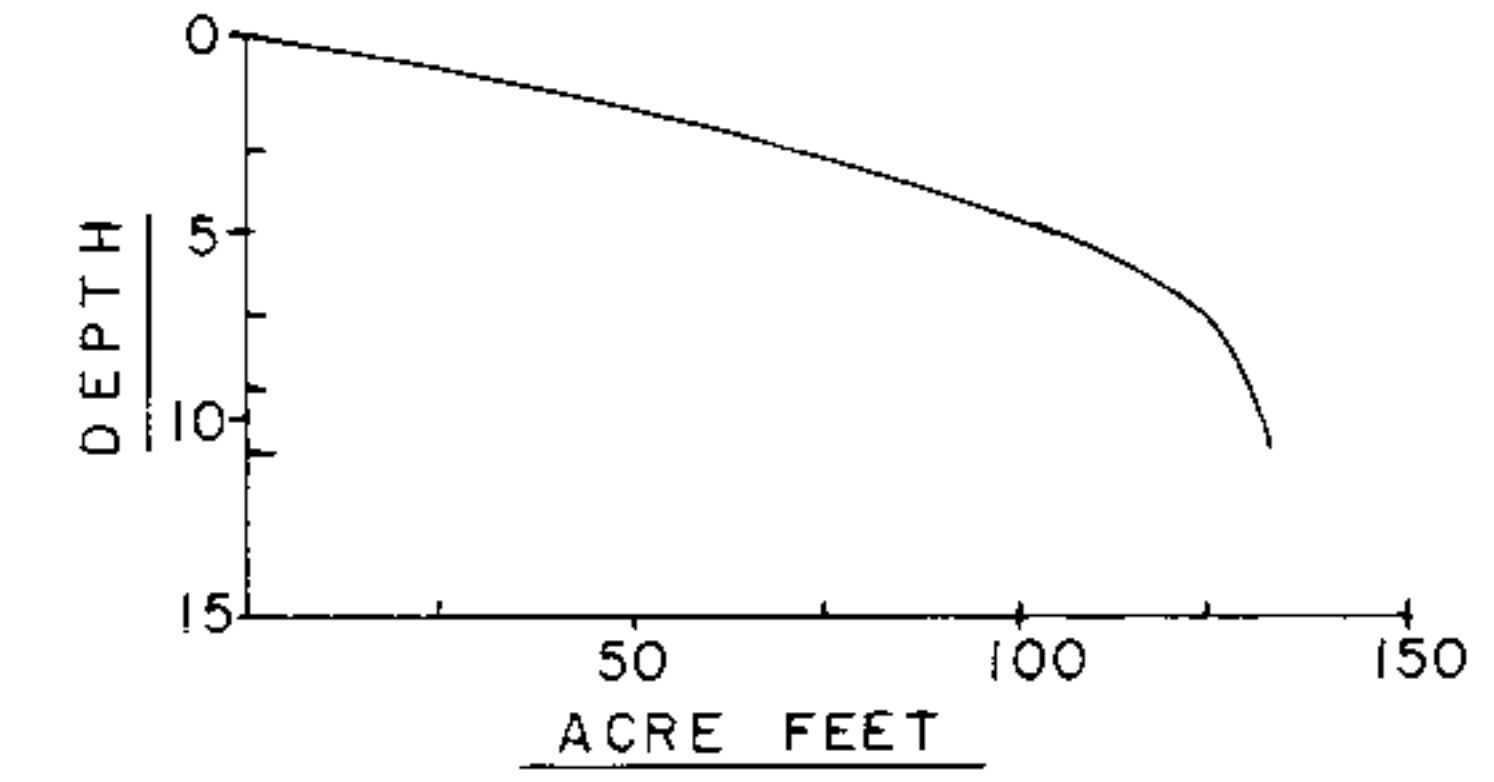

EQUIPMENT RECORDING SONAR MAPPED AUGUST 1972
MONTH YEAR
LAKE BOTTOM SYMBOLS

- | TOPOGRAPHIC SYMBOLS | | LAKE BOTTOM SYMBOLS | |
|-----------------------|-------------------------------|---------------------|-----------------------------|
| (B) Brush | Steep slope | P. Peat | B Boulders |
| (PW) Partially wooded | ----- Indefinite shoreline | Mk. Muck | o Stumps & Snags |
| (W) Wooded | ----- Marsh | C. Clay | o Rock danger to navigation |
| (C) Cleared | o Spring | M. Marl | T Submergent vegetation |
| (P) Pastured | ----- Intermittent stream | Sd. Sand | l Emergent vegetation |
| (A) Agricultural | ----- Permanent inlet | St. Silt | h Floating vegetation |
| B.M. Bench Mark | ----- Permanent outlet | Gr. Gravel | h Brush shelters |
| ■ Dwelling | ----- Dam | R. Rubble | |
| □ Resort | ----- D.N.R. State owned land | Bc. Bedrock | |
| □ Camp | | | |

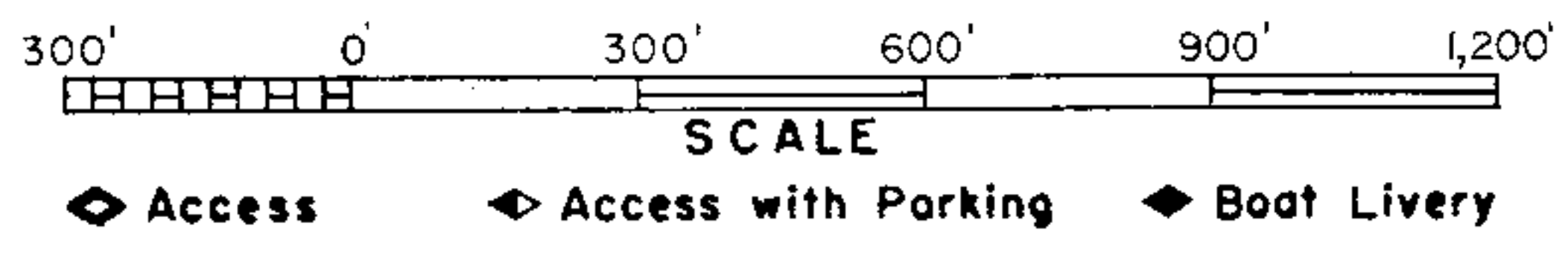

Drawn by: E. Eaton
Field work by: D. Boese, M. Schrage

SPECIES OF FISH	Abundance		
	Abundant	Common	Present
Muskie			
N. Pike			
Walleye			
L.M. Bass			X
S.M. Bass			X
Panfish			X
Trout			X

WATER AREA 27.8 ACRES
 UNDER 3 FT. 25 %
 OVER 20 FT. 0 %
 MAX. DEPTH 11 FEET.
 TOTAL ALK. 103 P.P.M.
 VOLUME 132.5 ACRE FT.
 SHORELINE 1.99 MILES

Source: Wisconsin Department of Natural Resources 608-266-2621
Tilleda Pond – Shawano County, Wisconsin DNR Lake Map
Date – Aug 1972 - Historical Lake Map - Not for Navigation
A Public Document - Please Identify the Source when using it.