

LAKE LONG
 SECTION 21-22
 TOWNSHIP T. 25. N
 RANGE R. 13. E
 TOWN DU PONT
 COUNTY WAUPACA

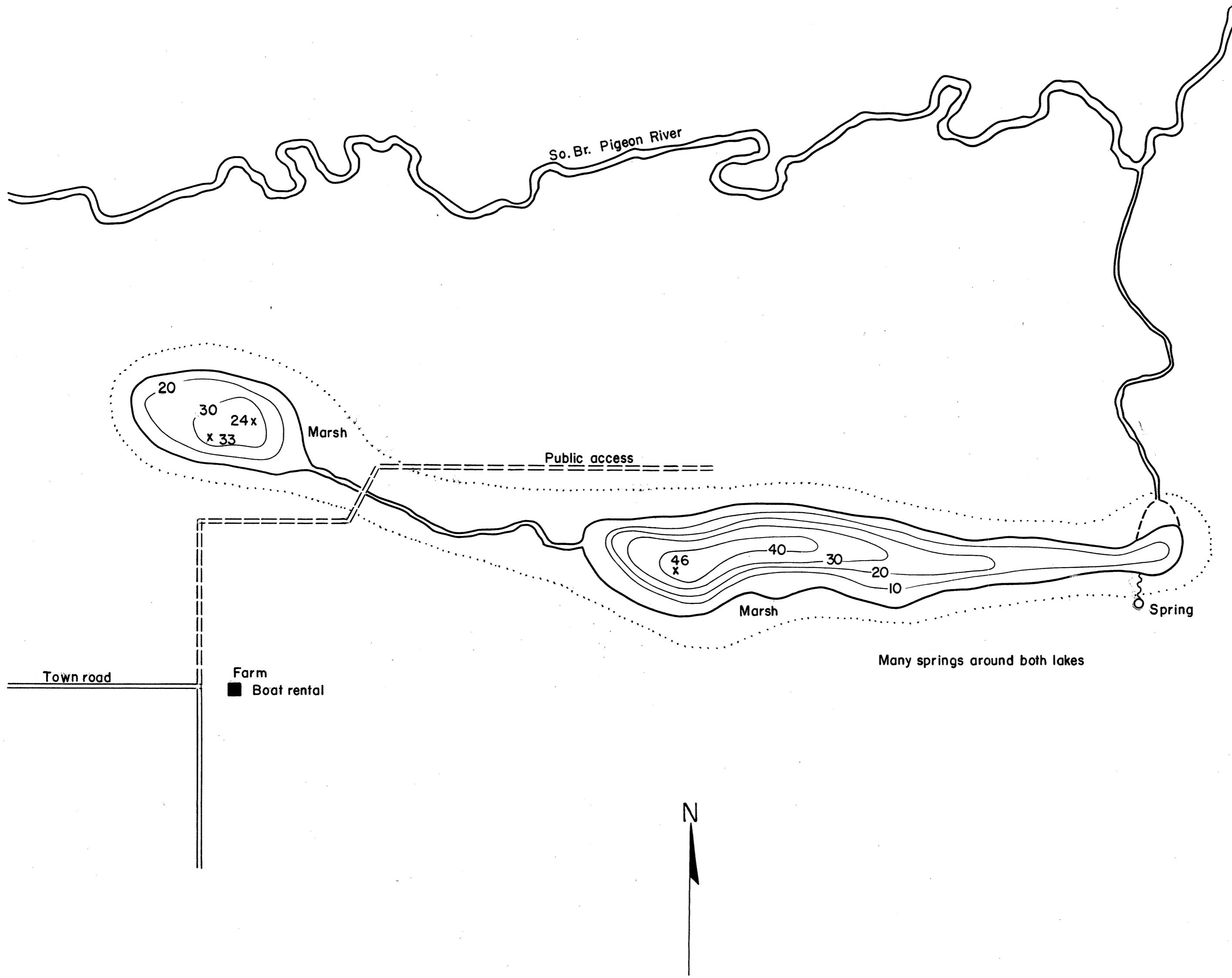

Many springs around both lakes

Lake mapped 8/15/56

AREA 9 Acres East lake
3 " West "
 TOTAL SHORELINE 1.05 Miles
 MAX. DEPTH 46 Feet
 SCALE: 20" = 1 Mile

Source: Wisconsin Department of Natural Resources 608-266-2621
Long Lake – Waupaca County, Wisconsin DNR Lake Map
Date – Aug 1956 - Historical Lake Map - Not for Navigation
A Public Document - Please Identify the Source when using it.