

WISCONSIN CONSERVATION DEPARTMENT
 BIOLOGY DIVISION
 LAKE AND STREAM IMPROVEMENT SECTION

LAKE SURVEY MAP

LAKE CINCOE
 SECTION 33
 TOWNSHIP 22 N
 RANGE 4 E
 TOWN OF MUKWA
 COUNTY WAUPACA

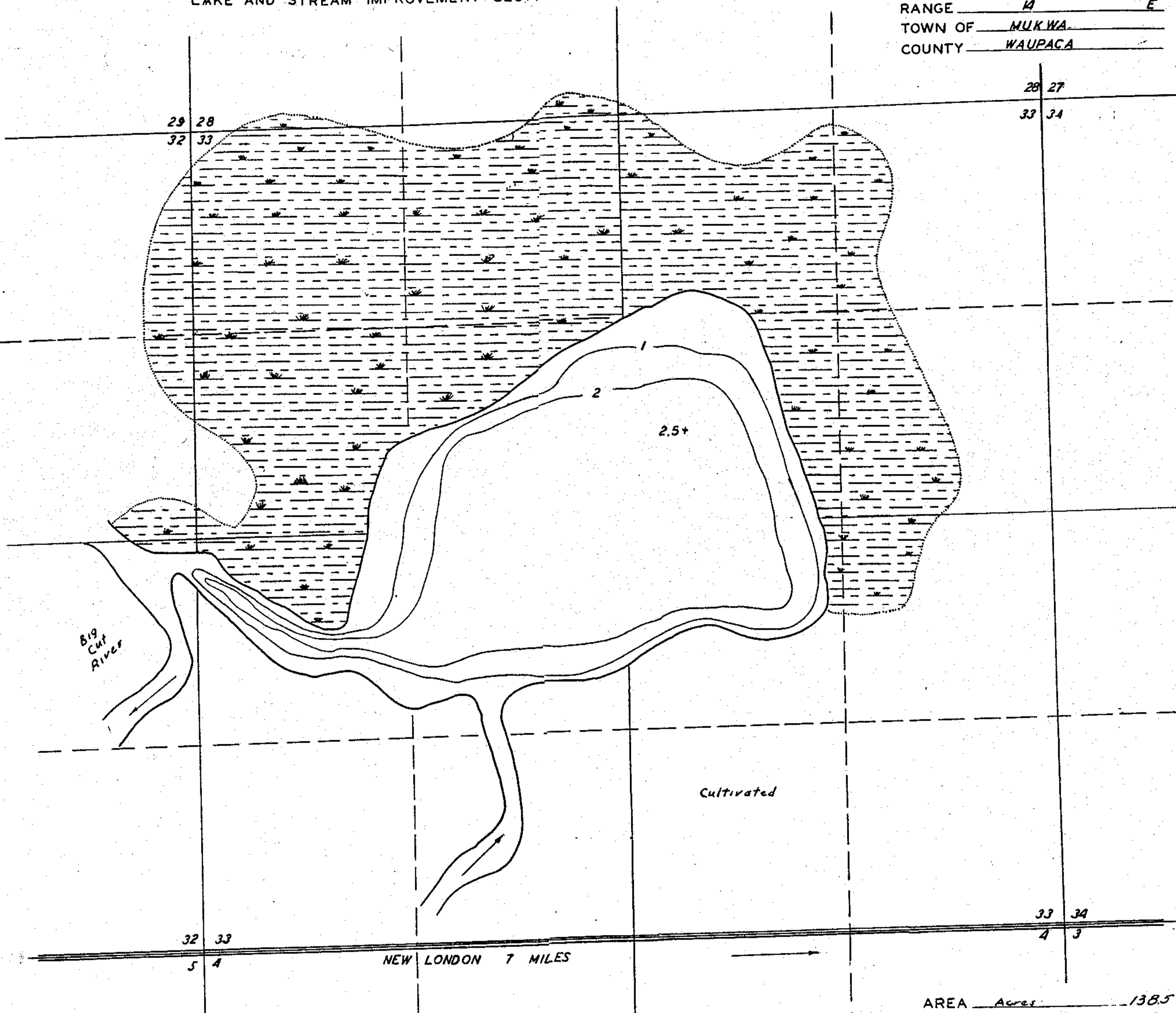

AREA Acres 138.5
 TOTAL SHORELINE: 3.3 MILES
 MAX. DEPTH: 25

NO SCALE ZEROX REDUCED

Checked
 W.P.S.
 E.M.K.
 7/23/41

DATE JANUARY 23 1941
 COMPILED BY _____
 TRACED BY P.P.B. CCC
 SOURCE OF INFORMATION WOLF RIVER SURVEY CORP. OF ENGINEERING
U.S. ARMY OCT. 10, 1931
 SOUNDINGS _____
 DATES OF MAP REVISION _____
 WORK AGENCY _____

LAKE IMPROVEMENT RECORD

TYPE	DATE	_____	_____	_____
⊕ BRUSH REFUGES	_____	_____	_____	_____
fw SAPLING TANGLES	_____	_____	_____	_____
□ SPAWNING BOXES	_____	_____	_____	_____
* MINNOW SPAWNERS	_____	_____	_____	_____
TOTAL	_____	_____	_____	_____

- LEGEND
- ⊕ WEED BEDS
 - * ROCKY SHOALS
 - Sd SAND
 - Cl CLAY
 - Gr GRAVEL
 - Mx MUCK
 - DWELLING
 - ABANDONED DWELLING
 - RESORT

Source: Wisconsin Department of Natural Resources 608-266-2621
Cincoe Lake – Waupaca County, Wisconsin DNR Lake Map
Date – Jan 1941 - Historical Lake Map - Not for Navigation
A Public Document - Please Identify the Source when using it.