

LAKE SURVEY MAP

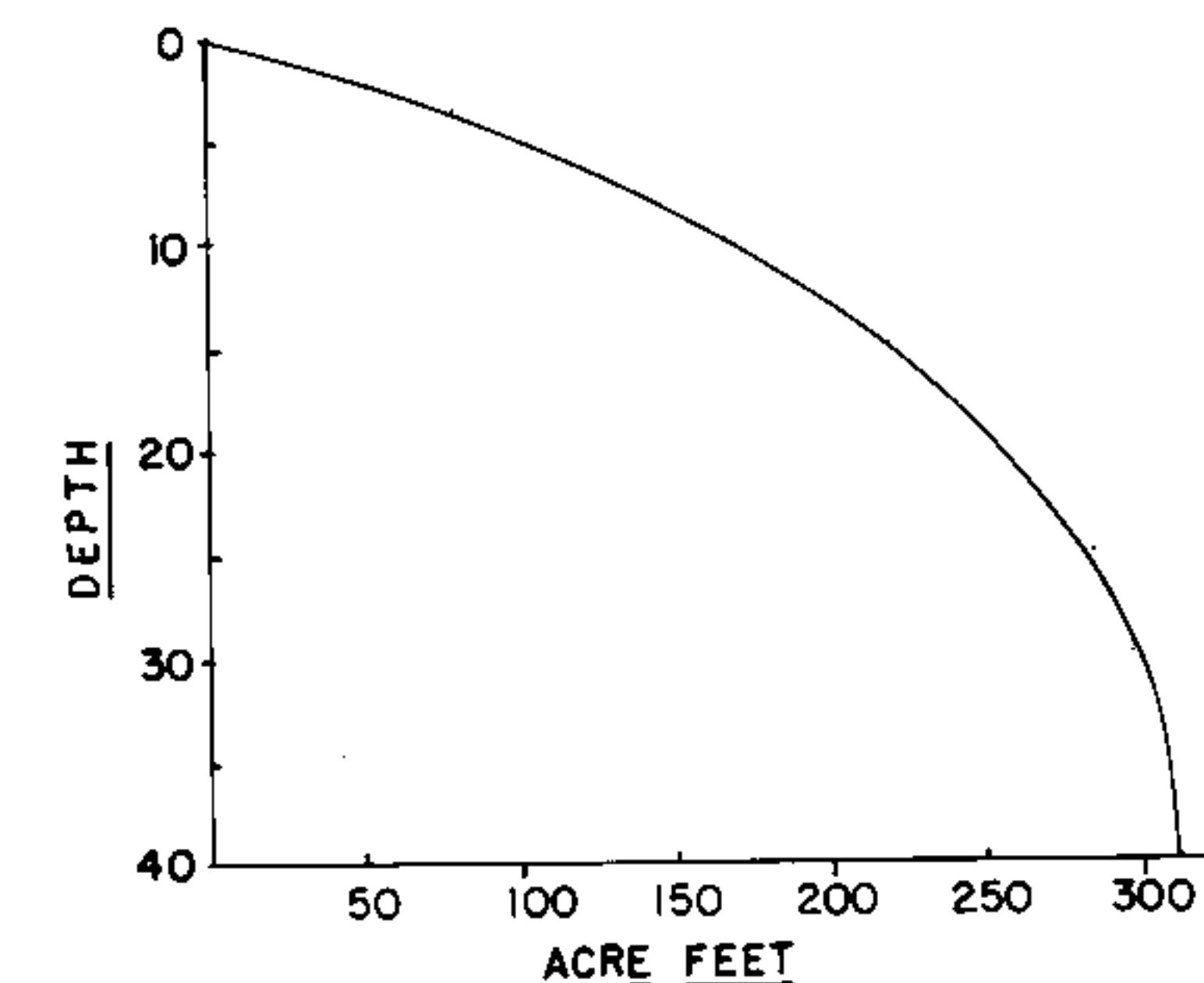
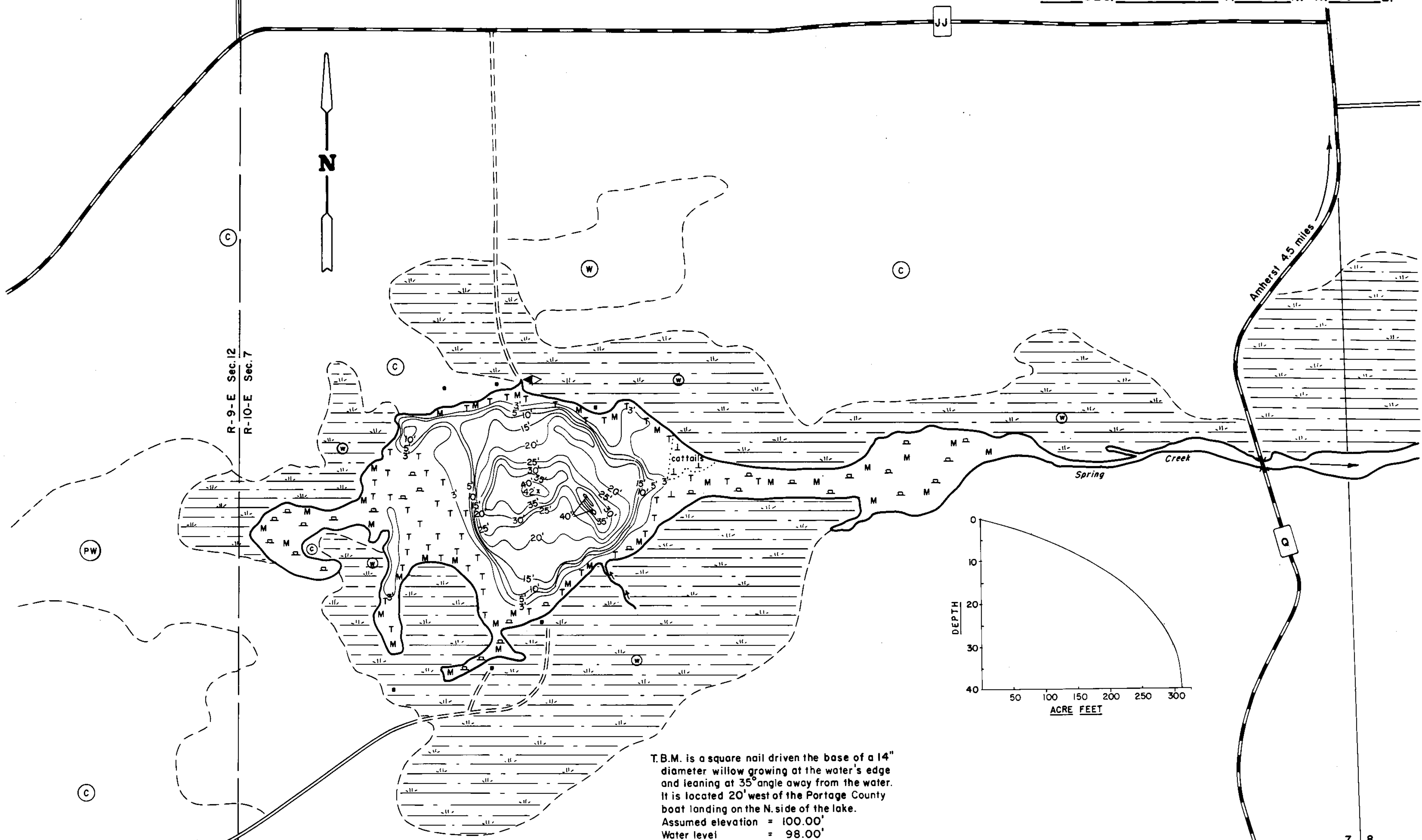

T.B.M. is a square nail driven the base of a 14" diameter willow growing at the water's edge and leaning at 35° angle away from the water. It is located 20' west of the Portage County boat landing on the N. side of the lake.
Assumed elevation = 100.00'
Water level = 98.00'

EQUIPMENT RECORDING SONAR MAPPED SEPT. 1978

TOPOGRAPHIC SYMBOLS		MONTH	YEAR	LAKE BOTTOM SYMBOLS	
(B) Brush	Steep slope	P. Peat	B Boulders	⊙ Stumps & Snags	
(PW) Partially wooded	- - - Indefinite shoreline	Mk. Muck	⊙ Rock danger to navigation	T Submergent vegetation	
(W) Wooded	Marsh	C. Clay	⊥ Emergent vegetation	⊥ Floating vegetation	
(C) Cleared	Spring	M. Marl	⊥ Brush shelters		
(P) Pastured	Intermittent stream	Sd. Sand			
(A) Agricultural	Permanent inlet	St. Silt			
B.M. Bench Mark	Permanent outlet	Gr. Gravel			
■ Dwelling	Dam	R. Rubble			
□ Resort	D.N.R. State owned land	Br. Bedrock			
□ Camp					



◆ Access ◀ Access with Parking ◆ Boat Livery

Drawn by: R. Williams
Field work by: K. Arnold & D. Bauer

SPECIES OF FISH	Abundance	
	Abundant	Common
Muskie		
N. Pike		
Walleye		
L.M. Bass	X	
S.M. Bass	X	
Panfish	X	
Trout	X	

WATER AREA 37.0 ACRES
UNDER 3 FT. 56 %
OVER 20 FT. 17 %
MAX. DEPTH 42 FEET.
TOTAL ALK. 184 P.P.M.
VOLUME 311.19 ACRE FT.
MAIN SHORELINE 1.06 MI.
ISLAND SHORELINE 0 MI.

Source: Wisconsin Department of Natural Resources 608-266-2621
Spring Lake – Portage County, Wisconsin DNR Lake Map
Date – Sep 1978 - Historical Lake Map - Not for Navigation
A Public Document - Please Identify the Source when using it.