

LAKE SURVEY MAP

LAKE DEAN FORM F
 SECTION 13
 TOWNSHIP 21 N
 RANGE 10 E
 TOWN OF BELMONT
 COUNTY PORTAGE

WISCONSIN CONSERVATION DEPARTMENT
 BIOLOGY DIVISION
 LAKE AND STREAM IMPROVEMENT SECTION

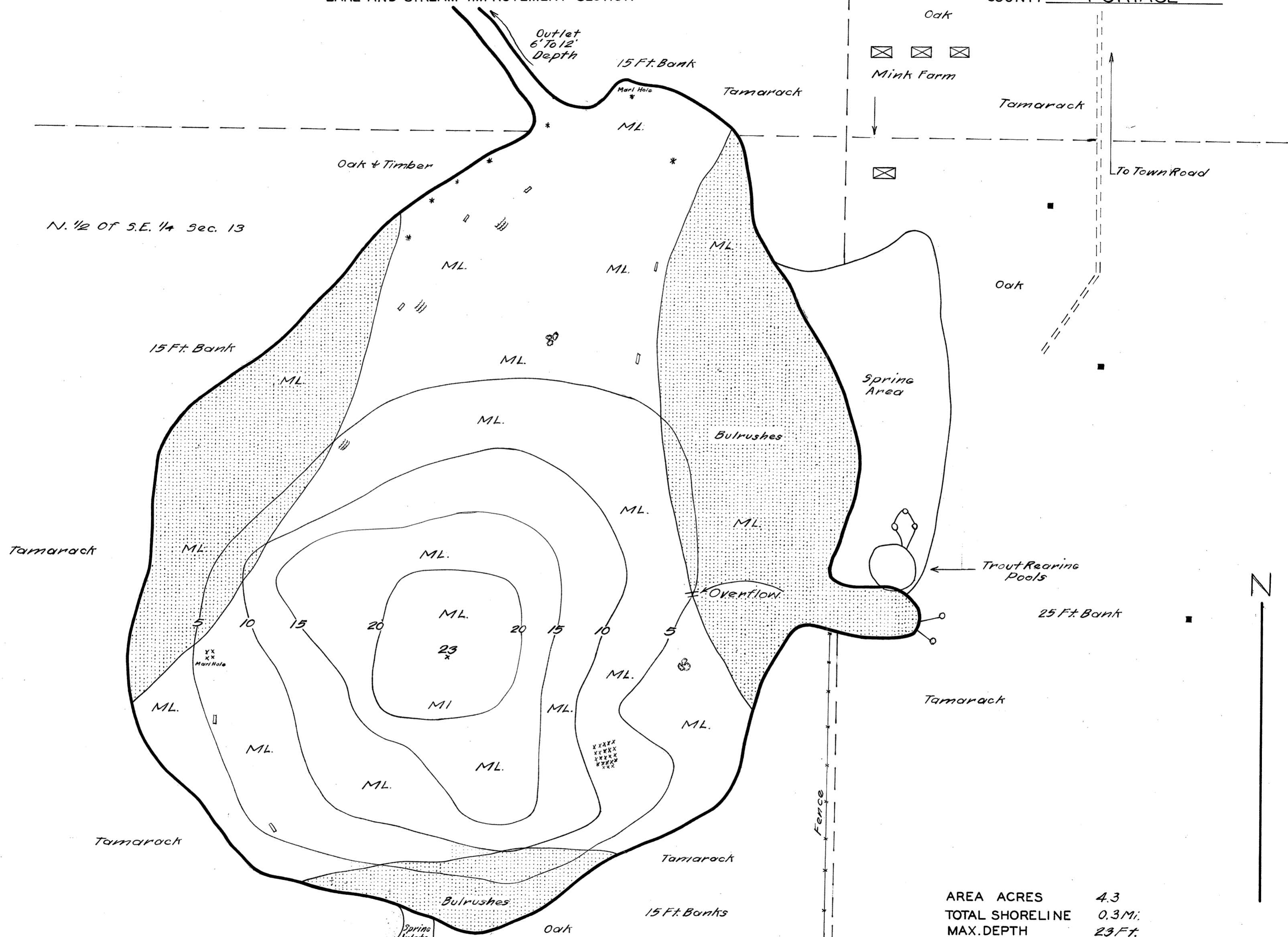

AREA ACRES 4.3
 TOTAL SHORELINE 0.3 Mi.
 MAX. DEPTH 23 Ft.

SCALE 1 inch Equals 50 Ft.
 0 10 50 100 150 200 Ft.

DATE June 25 1941
 COMPILED BY _____
 TRACED BY W.T.Z. (W.P.A.)
 SOURCE OF INFORMATION W.P.A. Lake Survey Project
 SOUNDINGS 100 Ft. Intervals
 DATES OF MAP REVISION _____
 WORK AGENCY W. P. A.

LAKE IMPROVEMENT RECORD	
TYPE	DATE
BRUSH REFUGES	<u>15</u>
SAPLING TANGLES	<u>15</u>
SPAWNING BOXES	<u>15</u>
MINNOW SPAWNERS	<u>35</u>
STUMPS	<u>23</u>
TOTAL	<u>103</u>

LEGEND

- WEED BEDS
- ROCKY SHOALS
- Sd* SAND
- Cl* CLAY
- Gr.* GRAVEL
- Mk.* MUCK
- DWELLING
- ABANDONED DWELLING
- RESORT

Checked
W.P.S.
E.M.H.
8/20/41

Source: Wisconsin Department of Natural Resources 608-266-2621
Dean Lake – Portage County, Wisconsin DNR Lake Map
Date – Jun 1941 - Historical Lake Map - Not for Navigation
A Public Document - Please Identify the Source when using it.