

# LAKE SURVEY MAP

WISCONSIN CONSERVATION DEPARTMENT  
BIOLOGY DIVISION  
LAKE AND STREAM IMPROVEMENT SECTION

LAKE KRANKRUD, Hintz FORM FI-117  
SECTION 20 21  
TOWNSHIP 24 N  
RANGE 10 E  
TOWN OF NEW HOPE  
COUNTY PORTAGE

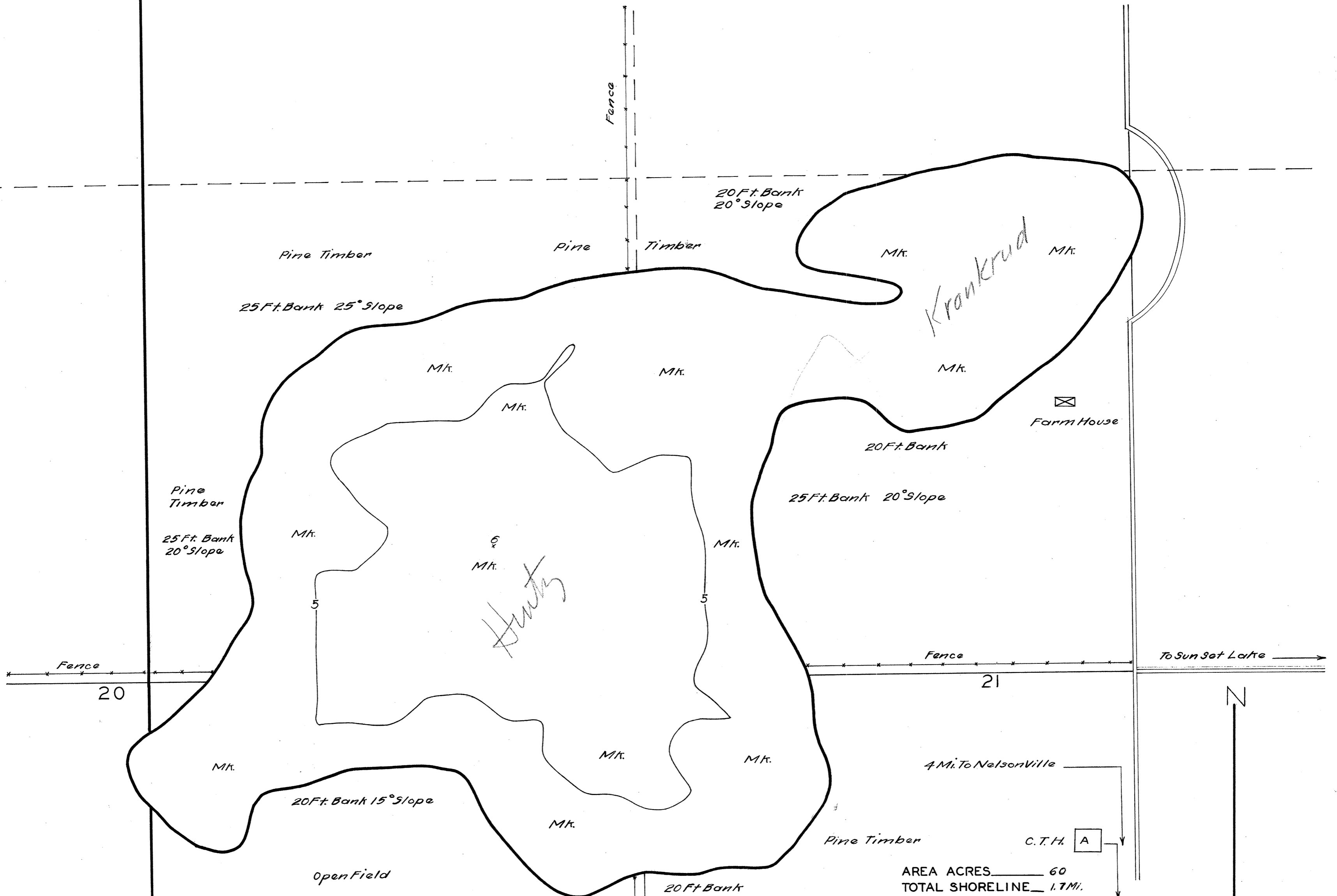

DATE June 27 1941  
COMPILED BY \_\_\_\_\_  
TRACED BY W.T.Z. (W.P.A.)  
SOURCE OF INFORMATION \_\_\_\_\_  
W.P.A. Lake Survey Project  
SOUNDINGS 100 Ft. intervals  
DATES OF MAP REVISION \_\_\_\_\_  
WORK AGENCY W. P. A.

LAKE IMPROVEMENT RECORD				
TYPE	DATE	_____	_____	_____
o BRUSH REFUGES	_____	_____	_____	_____
l SAPLING TANGLES	_____	_____	_____	_____
d SPAWNING BOXES	_____	_____	_____	_____
* MINNOW SPAWNERS	_____	_____	_____	_____
TOTAL _____				

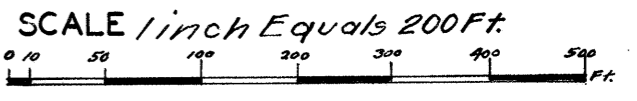

- LEGEND**
- WEED BEDS
  - ROCKY SHOALS
  - Sd. SAND
  - Cl. CLAY
  - Gr. GRAVEL
  - Mk. MUCK
  - DWELLING
  - ABANDONED DWELLING
  - RESORT

Checked  
W.P.A.  
E.M.K.  
6-30-41

Source: Wisconsin Department of Natural Resources 608-266-2621  
Hintz Lake and Krankrud Lake – Portage County, Wisconsin DNR Lake Maps  
Date – Jun 1941 - Historical Lake Map - Not for Navigation  
A Public Document - Please Identify the Source when using it.