

McCall Lake
4.4 Acres
0.34 Mi. Shoreline
37 Ft. Deep

Amey Pond
59.2 Acres
1.61 Mi. Shoreline

B.M. 'X' Top of cement wall
upstream side of dam
Assumed elevation 100.00'
Water level 98.80'

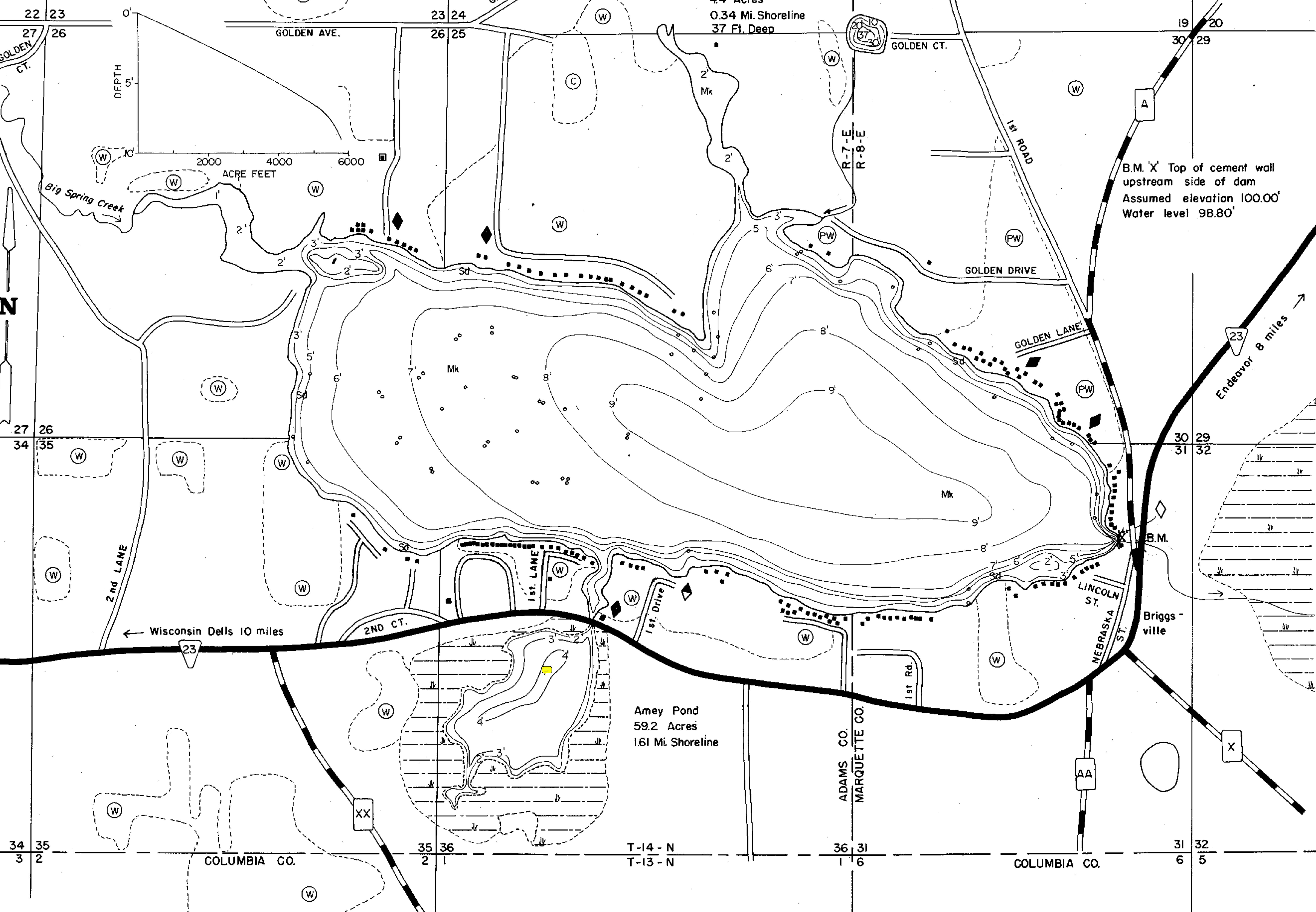

EQUIPMENT RECORDING SONAR MAPPED JUNE 1970
MONTH YEAR
LAKE BOTTOM SYMBOLS

- TOPOGRAPHIC SYMBOLS**
- (B) Brush
 - (PW) Partially wooded
 - (W) Wooded
 - (C) Cleared
 - (P) Pastured
 - (A) Agricultural
 - B.M. Bench Mark
 - Dwelling
 - Resort
 - Camp
 - ||||| Steep slope
 - - - Indefinite shoreline
 - Marsh
 - Spring
 - Intermittent stream
 - Permanent inlet
 - Permanent outlet
 - Dam
 - D.N.R. State owned land

- P. Peat
- Mk. Muck
- C. Clay
- M. Marl
- Sd. Sand
- St. Silt
- Gr. Gravel
- R. Rubble
- Br. Bedrock
- B Boulders
- Stumps & Snags
- Rock danger to navigation
- T Submergent vegetation
- Emergent vegetation
- Floating vegetation
- Brush shelters



Access Access with Parking Boat Livery
Drawn by: C. Holt
Field work by: M. Schrage, G. Werdin

SPECIES OF FISH	ABUNDANCE		
	Abundant	Common	Present
Muskie			X
N. Pike	X		
Walleye	X		
L.M. Bass	X		
S.M. Bass			X
Panfish	X		
Trout			

WATER AREA 855.6 ACRES
UNDER 3 FT. 8 %
OVER 20 FT. 0 %
MAX. DEPTH 9 FEET.
TOTAL ALK. 146.0 P.P.M.
VOLUME 5783.7 ACRE FT.
SHORELINE 7.53 MILES

Source: Wisconsin Department of Natural Resources 608-266-2621
Amey Pond – Adams County, Wisconsin DNR on Lake Mason Lake Map
Date – Jun 1970 - Historical Lake Map - Not for Navigation
A Public Document - Please Identify the Source when using it.