

LAKE SURVEY MAP

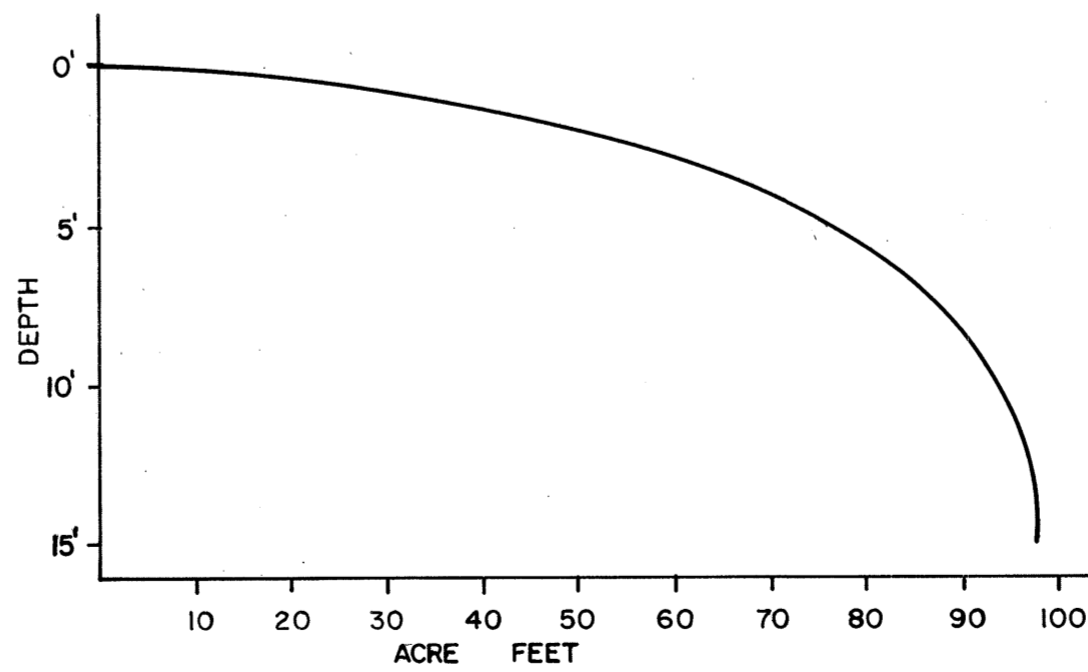
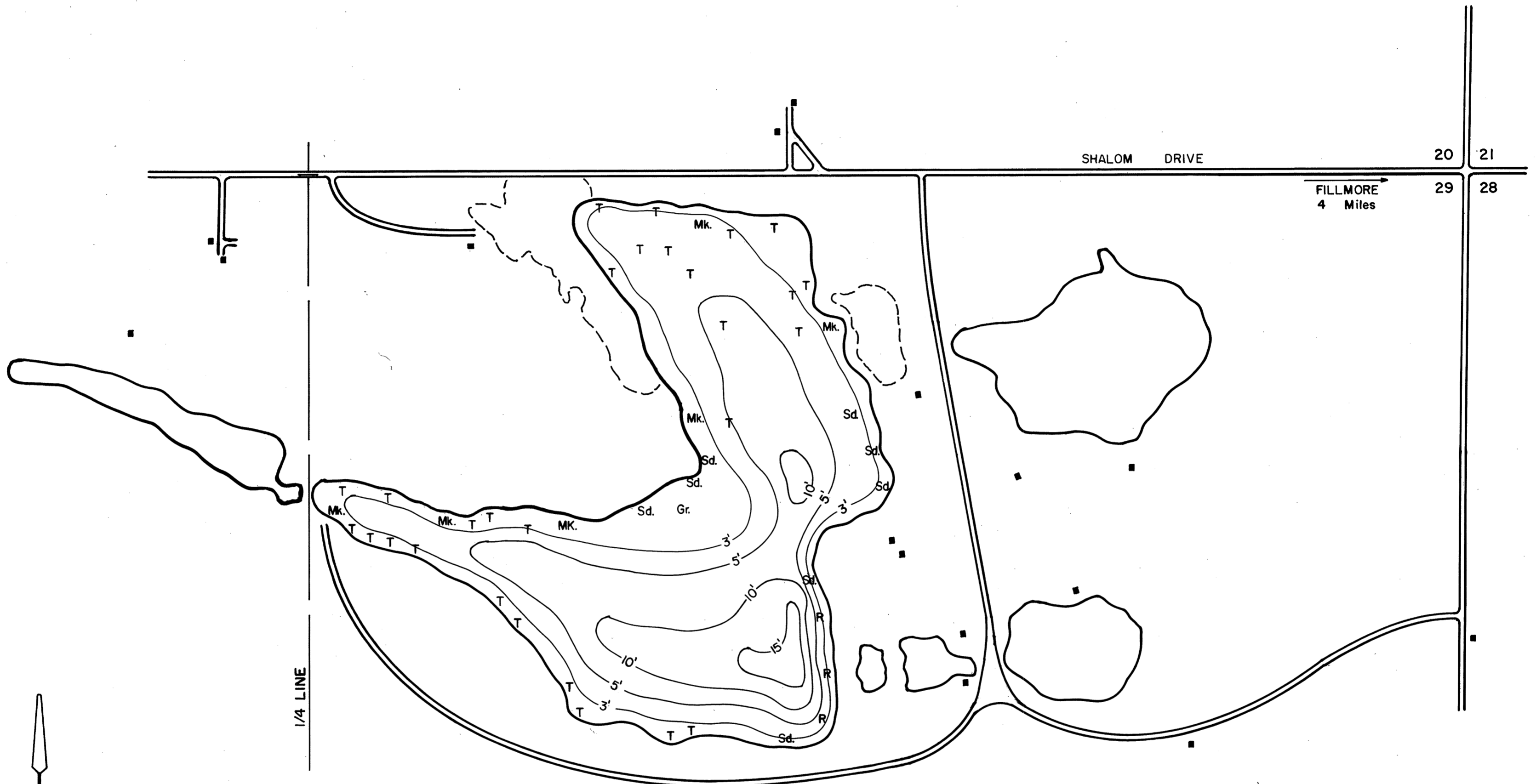

Access Access with Parking Boat Livery

Drawn by: R.A. Burnkrant
Field work by: G. Werdin & P. Zinke

EQUIPMENT RECORDING SONAR MAPPED MAY 1969

- TOPOGRAPHIC SYMBOLS**
- (B) Brush
 - (PW) Partially wooded
 - (W) Wooded
 - (C) Cleared
 - (P) Pastured
 - (A) Agricultural
 - B.M. Bench Mark
 - Dwelling
 - Resort
 - Camp

- LAKE BOTTOM SYMBOLS**
- P. Peat
 - Mk. Muck
 - C. Clay
 - M. Marl
 - Sd. Sand
 - St. Silt
 - Gr. Gravel
 - R. Rubble
 - Br. Bedrock
 - B Boulders
 - ⊙ Stumps & Snags
 - ⊙ Rock danger to navigation
 - T Submergent vegetation
 - ⊥ Emergent vegetation
 - ⊥ Floating vegetation
 - ⊕ Brush shelters

SPECIES OF FISH	Abundant		Common		Present	
	Abundant	Common	Present	Abundant	Common	Present
Muskie						
N. Pike						
Walleye						
L.M. Bass						
S.M. Bass					X	
Panfish			X			
Trout						

WATER AREA 18.2 ACRES
 UNDER 3 FT. 28 %
 OVER 20 FT. 0 %
 MAX. DEPTH 15 FEET.
 TOTAL ALK. 186 P.P.M.
 VOLUME 95.8 ACRE FT.
 SHORELINE .95 MILES

Source: Wisconsin Department of Natural Resources 608-266-2621
Ehne Lake – Washington County, Wisconsin DNR Lake Map
Date – May 1969 - Historical Lake Map - Not for Navigation
A Public Document - Please Identify the Source when using it.