

LAKE SURVEY MAP

WISCONSIN CONSERVATION DEPARTMENT
BIOLOGY DIVISION
LAKE AND STREAM IMPROVEMENT SECTION

LAKE CLEAR
SECTION 23
TOWNSHIP 31 N
RANGE 8 W
TOWN OF CLEVELAND
COUNTY CHIPPEWA

FORM FH17

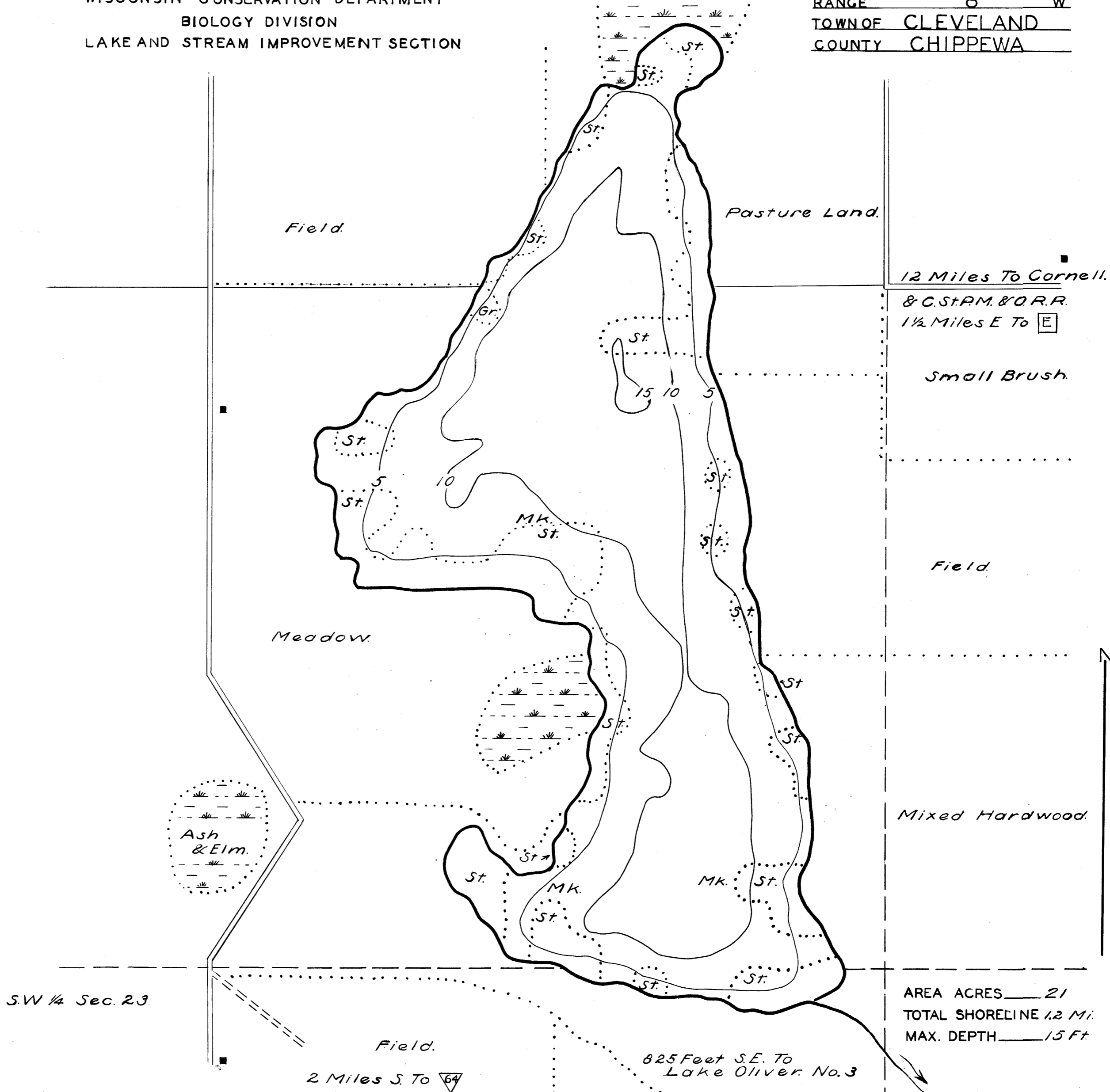

AREA ACRES 21
TOTAL SHORELINE 1.2 Mi.
MAX. DEPTH 15 Ft.

S.W. 1/4 Sec. 23

Field.
2 Miles S To 64

825 Feet S.E. To
Lake Oliver No. 3

DATE April 7 1941
 COMPILED BY _____
 TRACED BY R.A.N.L.M. (WPA)
 SOURCE OF INFORMATION
WPA Lake Survey Project
 SOUNDINGS At 66 Ft Intervals
 DATES OF MAP REVISION _____
 WORK AGENCY W. P. A.

LAKE IMPROVEMENT RECORD

TYPE	DATE	_____	_____	_____	_____
⊕ BRUSH REFUGES	_____	_____	_____	_____	_____
~ SAPLING TANGLES	_____	_____	_____	_____	_____
□ SPAWNING BOXES	_____	_____	_____	_____	_____
* MINNOW SPAWNERS	_____	_____	_____	_____	_____
TOTAL	_____	_____	_____	_____	_____

SCALE 1 inch Equals 165.
0 50 100 200 300 400 500

LEGEND

⊕	WEED BEDS
~	ROCKY SHOALS
Sd.	SAND
Cl.	CLAY
Gr.	GRAVEL
Mk.	MUCK
■	DWELLING
□	ABANDONED DWELLING
■	RESORT
St.	SILT

Source: Wisconsin Department of Natural Resources 608-266-2621
Clear Lake – Chippewa County, Wisconsin DNR Lake Map
Date – Apr 1941 - Historical Lake Map - Not for Navigation
A Public Document - Please Identify the Source when using it.