

The purpose of this form is to track the abundance of the Water-milfoil weevil (*Euhrychiopsis lecontei*) and the amount of weevil damage in individual beds of EWM in Wisconsin lakes.

Use one datasheet for each EWM bed surveyed. When collecting stems for weevil counts, collect the TOP 50 centimeters (20 inches). Collect 10 stems/site for a total of 30 stems/bed.

**Notice:** Information on this voluntary form is collected under ss. 33.02 and 281.11, Wis. Stats. Personally identifiable information collected on this form will be incorporated into the DNR Surface Water Integrated Monitoring System (SWIMS) Database. Personally identifiable information collected on this form will be incorporated into the DNR aquatic invasive species database. It is not intended to be used for any other purposes, but may be made available to requesters under Wisconsin's Open Records laws, ss. 19.32 - 19.39, Wis. Stats.

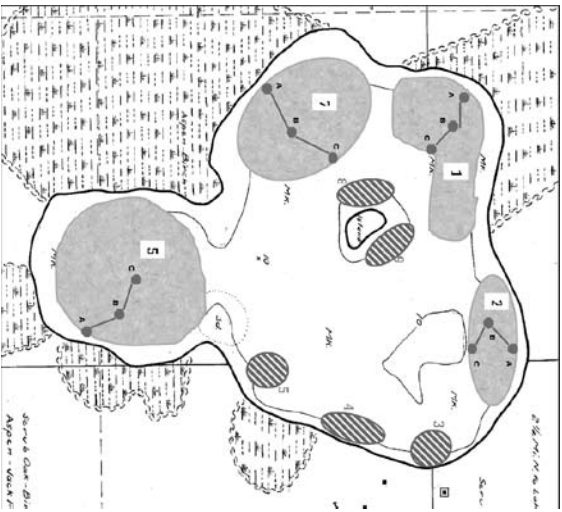

Primary Data Collector			
Name	Phone Number	Email	
Monitoring Location			
Waterbody Name	Township Name	County	
Latitude of center of EWM bed (optional)	Longitude of center of EWM bed (optional)		
Date and Time of Monitoring			
Monitoring Date	Start Time	End Time	
EWM Bed Habitat Information			
Shoreline Vegetation Type: <input type="checkbox"/> Natural Herbaceous (non-woody plants) <input type="checkbox"/> Natural Woody Shrubs <input type="checkbox"/> Trees <input type="checkbox"/> Manicured Lawn			
Distance of Natural Shoreline Buffer from Lakeshore to Manicured Lawn (If there is any rip-rap along the shoreline, record this as 0 ft of buffer) <input type="checkbox"/> 0 feet <input type="checkbox"/> 1-10 feet <input type="checkbox"/> 10-20 feet <input type="checkbox"/> 20+ feet			
Site Habitat Characteristics			
	Site A	Site B	Site C
Surface Water Temperature inside bed (optional)	° F	° F	° F
Surface Dissolved Oxygen inside bed (optional)	mg/L	mg/L	mg/L
Substrate (muck, sand, gravel, boulders)			
Water Depth at Site	feet	feet	feet
Substrate (muck, sand, gravel, boulders)			
Site EWM Characteristics			
EWM Rake Density (see "rake density" on pg 2)			
Stems Algae-Covered (none, present, abundant)			
Weevil Damage Count (number of pin-holes, pupa chambers and broken stems)			
Number of Weevil Eggs for 10 Stems			
Number of Weevil Larvae for 10 Stems			
Number of Weevil Pupae for 10 Stems			
Number of Weevil Adults for 10 Stems			
<b>Total Number of Weevils</b>			
Comments			
For DNR or UW-Ext Lakes Staff to fill out			
Have you entered the results of the voucher in SWIMS? <input type="checkbox"/> Yes <input type="checkbox"/> No			
Name of person or museum who identified the voucher specimen			
Was the specimen confirmed as....?			
<i>Euhrychiopsis lecontei</i> ? <input type="checkbox"/> Yes <input type="checkbox"/> No	<i>Phytobius</i> species? <input type="checkbox"/> Yes <input type="checkbox"/> No		
DNR or UW-Ext Lakes Staff: Please enter this report in SWIMS under the Weevil project for the appropriate county. Then, keep the paper copy for your records.			

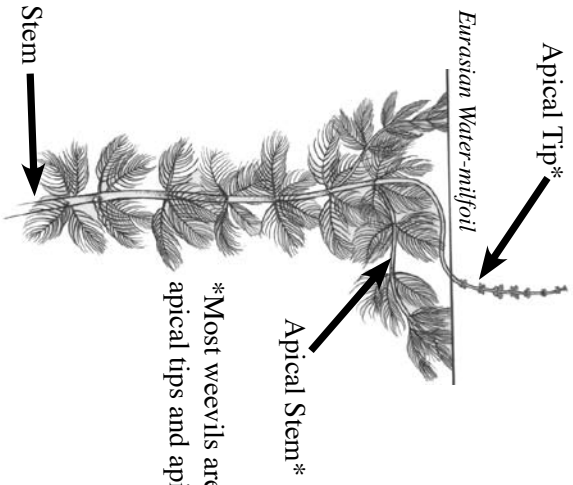

EWM beds - 4 largest of 9, with sites A, B, C in each bed.



\*Most weevils are found on the apical tips and apical stems

RATING	COVERAGE	DESCRIPTION
1		A few plants on rake head
2		Rake head is about 1/2 full Can easily see top of rake head
3		Overflowing Cannot see top of rake head

**Contact Info:**  
 Laura Herman  
 CLMN Educator, UW- Extension Lakes  
 107 Sutliff AVE  
 Rhineland, WI 54501  
 (715) 365- 8998 Rhineland  
 laura.herman@uwsp.edu