

CITY: MKE DIV/GROUP: IM DB: MG LD: CK MADISON-KIPP Z:\GISPROJECTS\ENV\MadisonKipp\Map2016-02\Fig1\_BikePath\_ProposedExcav\_20160216.mxd

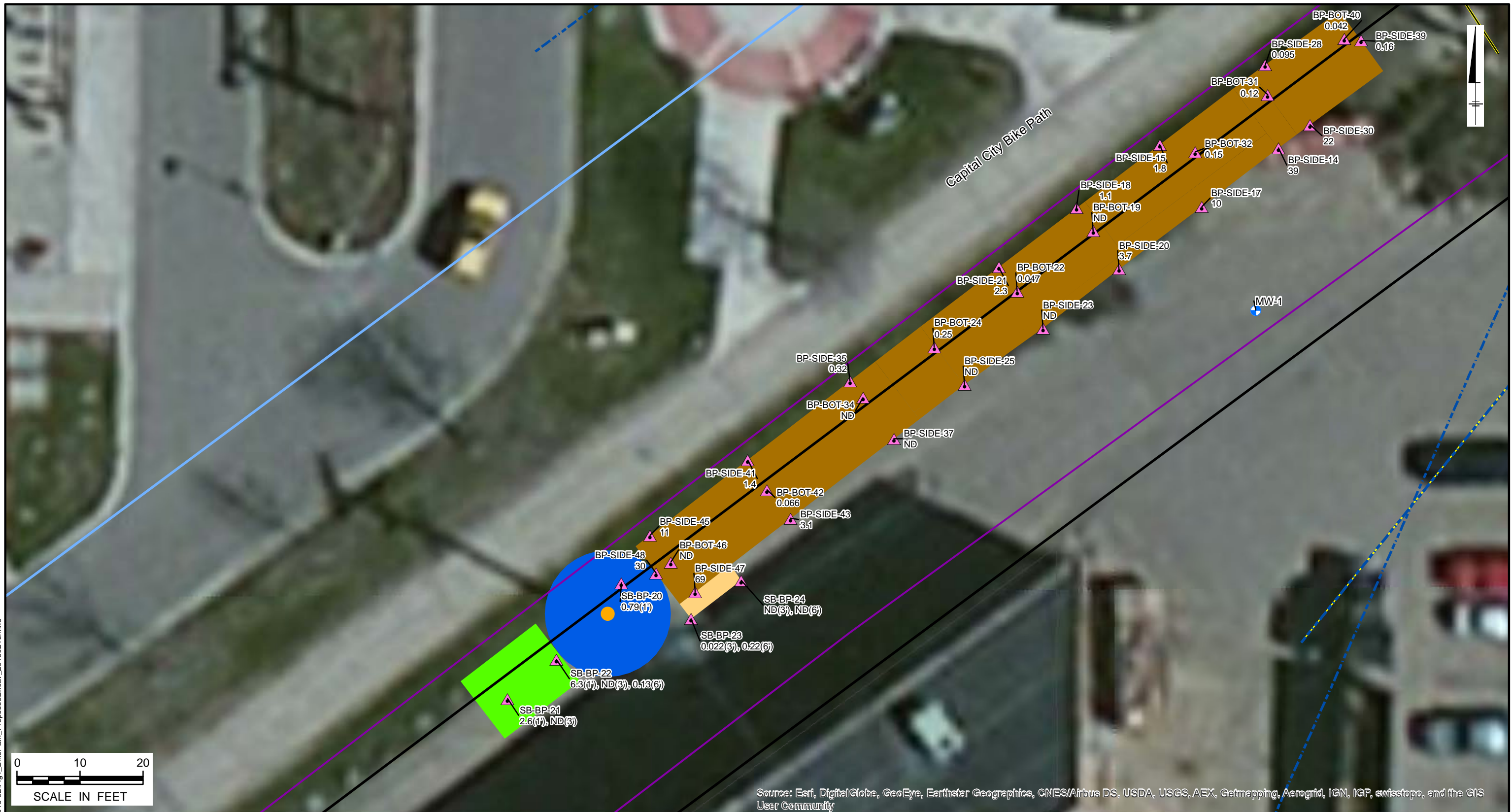

Source: Esri, DigitalGlobe, GeoEye, Earthstar Geographics, CNES/Airbus DS, USDA, USGS, AEX, Getmapping, Aerogrid, IGN, IGP, swisstopo, and the GIS User Community

LEGEND	
	MONITORING WELL
	APPROXIMATE LOCATION OF POWER POLE
	WATER MAIN
	ONSITE STORM WATER DISCHARGE
	ELECTRIC
	COMMUNICATIONS
	STORM WATER
	EXCAVATION CONFIRMATION SAMPLE LOCATIONS
	EXCAVATED AREA TO 6 FEET BELOW GROUND SURFACE, AND BACKFILLED WITH CLEAN SOIL
	PROPOSED EXCAVATION AREA TO 3 FEET BELOW GROUND SURFACE
	PROPOSED EXCAVATION AREA TO 1 FOOT BELOW GROUND SURFACE BY HAND
	PROPOSED EXCAVATION AREA TO 1 FOOT BELOW GROUND SURFACE
	PROPOSED EXCAVATION AREA TO 6 FEET BELOW GROUND SURFACE

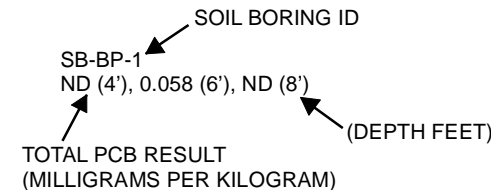

NOTES:  
 1) RESULTS SHOWN IN MILLIGRAMS PER KILOGRAM (MG/KG) OF TOTAL PCBs  
 2) ALL LOCATIONS ARE APPROXIMATE

MADISON-KIPP CORPORATION  
 201 WAUBESA STREET  
 MADISON, WISCONSIN

**PROPOSED CAPITAL CITY BIKE PATH  
 ADDITIONAL EXCAVATION AREAS**

**ARCADIS**

FIGURE  
**1**