

FEHR GRAHAM
 ENGINEERING & ENVIRONMENTAL
 ILLINOIS DESIGN FIRM NO. 194-003525

ILLINOIS
 IOWA
 WISCONSIN

OWNER/DEVELOPER:
 BAY TOWEL
 501 S. ADAMS ST.
 GREEN BAY, WI 54301

PROJECT AND LOCATION:
 BAY TOWEL - SOLVENT
 INVESTIGATION
 GREEN BAY, WI

DRAWN BY: MH
 APPROVED BY: DP
 DATE: 11/10/21
 SCALE: AS NOTED

REVISIONS		
REV. NO.	DESCRIPTION	DATE

DRAWING:
 GEOLOGIC CROSS SECTION
 (NORTHWEST-SOUTHEAST)
 SET TYPE: DRAFT
 G:\C30\21\21-953\Exhibits\21-953_Base Map.dwg, XSECT NW-SE

JOB NUMBER:
 21-953
 SHEET NUMBER:
 1 of 2

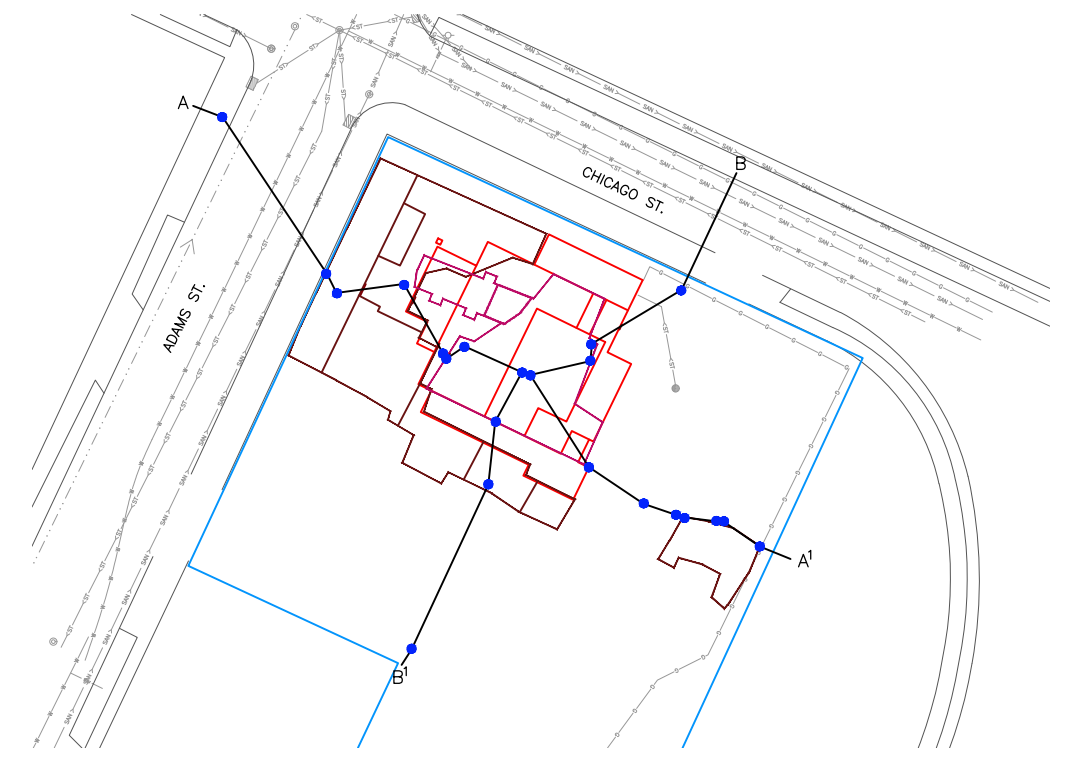
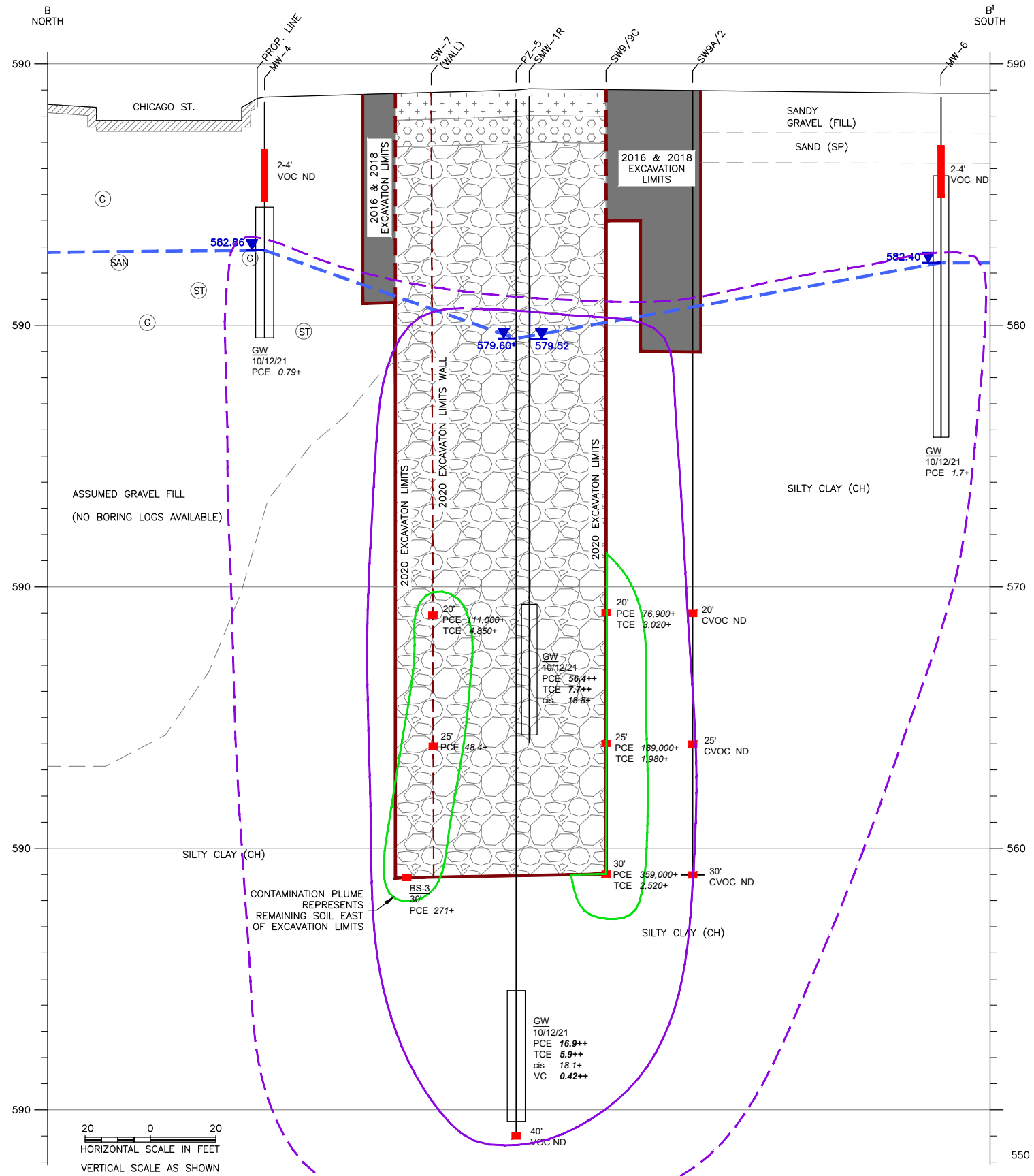

LEGEND

MONITORING WELL & SCREEN	WATER UTILITY	BANK RUN SAND & GRAVEL (SURFACE COMPLETED WITH TRAFFIC BOND SAND/GRAVEL)
SOIL BORING	SANITARY UTILITY	OFF-SITE SOURCE GRAVEL & SAND
	STORM UTILITY	ON-SITE SOURCE GRAVEL & SAND
	GAS UTILITY	AASHTO #57 CLEAN CLEAR STONE (NO FINES)

SOIL (mg/kg)	GROUNDWATER (ug/L)	ND NO DETECT
5' SAMPLE DEPTH	PCE TETRACHLOROETHENE	DBS DETECTIONS BELOW STANDARDS
PCE TETRACHLOROETHENE	TCE TRICHLOROETHENE	VOC VOLATILE ORGANIC COMPOUNDS
TCE TRICHLOROETHENE		CVOC CHLORINATED VOLATILE ORGANIC COMPOUNDS

<i>ITALICS+</i> EXCEEDS GROUNDWATER PATHWAY RCL	EXCEEDS NR140 ENFORCEMENT STANDARDS
ESTIMATED EXTENT OF SOIL CONTAMINATION EXCEEDING THE GROUNDWATER PATHWAY RCL	EXCEEDS BOTH NR140 ENFORCEMENT STANDARD AND PREVENTIVE ACTION LIMIT
GROUNDWATER ELEVATION & CONTOUR	

NOTE:
 - SOIL SAMPLES OBTAINED ON VARIOUS DAYS, RESULTS REPRESENT REMAINING IN PLACE SOIL CONTAMINATION

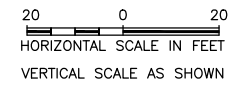

FEHR GRAHAM
 ENGINEERING & ENVIRONMENTAL
 ILLINOIS DESIGN FIRM NO. 194-003525

ILLINOIS
 IOWA
 WISCONSIN

OWNER/DEVELOPER:
 BAY TOWEL
 501 S. ADAMS ST.
 GREEN BAY, WI 54301

PROJECT AND LOCATION:
 BAY TOWEL - SOLVENT
 INVESTIGATION
 GREEN BAY, WI

DRAWN BY: MH
 APPROVED BY: DP
 DATE: 11/10/21
 SCALE: AS NOTED

REVISIONS		
REV. NO.	DESCRIPTION	DATE

DRAWING:
 GEOLOGIC CROSS SECTION
 (NORTH-SOUTH)

SET TYPE: FINAL
 G:\C30\21\21-953\Exhibits\21-953_Base Map.dwg, XSECT N-S

JOB NUMBER:
 21-953

SHEET NUMBER:
 2 of 2

From: Dillon Plamann <dplamann@fehr-graham.com>
Sent: Friday, November 12, 2021 3:49 PM
To: Schultz, Josie M - DNR
Cc: Matt Dahlem; Donald P. Gallo
Subject: RE: BAY TOWEL - SOLVENT INVESTIGATION, BRRTS #0205237064
Attachments: 2021_1110 F1 Cross-Section NW-SE.pdf; 2021_1110 F2 Cross-Section N-S.pdf

**CAUTION: This email originated from outside the organization.
Do not click links or open attachments unless you recognize the sender and know the content is safe.**

Josie,

Attached are the cross sections requested for the virtual meeting.

In addition, backfill at the site consists of bank run sand and gravel (2016 and 2018 excavations), gravel with sand (2020 excavation), and clear stone (2020 excavation). The clear stone was not compacted due to the depth it was being placed and safety concerns. We didn't do any specific permeability tests on any of the backfill, but since it is all coarse grained sediments with limited or no fines, we can assume it all has a relatively high permeability compared to the former impermeable building cover. The native soil (silty clay) has a very low permeability compared to the backfill, as evident by the tight silty clay formation preventing infiltration of groundwater in the excavation base while the excavation was open up to 30 feet below grade (typical depth to groundwater ranges from two to eight feet at the site).

Thank you, and have a nice weekend!

DILLON PLAMANN | Project Hydrogeologist
Fehr Graham | Engineering & Environmental

909 North 8th Street, Suite 101
Sheboygan, WI 53081
C: 920.946.2407
fehrgraham.com

From: Schultz, Josie M - DNR <josie.schultz@wisconsin.gov>
Sent: Tuesday, November 09, 2021 8:58 AM
To: Dillon Plamann <dplamann@fehr-graham.com>
Cc: Matt Dahlem <mdahlem@fehr-graham.com>
Subject: RE: BAY TOWEL - SOLVENT INVESTIGATION, BRRTS #0205237064

Hi Dillon,

This email is to follow-up on the two pieces of information discussed on the phone this morning that DNR will need prior to the virtual meeting:

From: Dillon Plamann <dplamann@fehr-graham.com>
Sent: Friday, November 12, 2021 3:49 PM
To: Schultz, Josie M - DNR
Cc: Matt Dahlem; Donald P. Gallo
Subject: RE: BAY TOWEL - SOLVENT INVESTIGATION, BRRTS #0205237064
Attachments: 2021_1110 F1 Cross-Section NW-SE.pdf; 2021_1110 F2 Cross-Section N-S.pdf

**CAUTION: This email originated from outside the organization.
Do not click links or open attachments unless you recognize the sender and know the content is safe.**

Josie,

Attached are the cross sections requested for the virtual meeting.

In addition, backfill at the site consists of bank run sand and gravel (2016 and 2018 excavations), gravel with sand (2020 excavation), and clear stone (2020 excavation). The clear stone was not compacted due to the depth it was being placed and safety concerns. We didn't do any specific permeability tests on any of the backfill, but since it is all coarse grained sediments with limited or no fines, we can assume it all has a relatively high permeability compared to the former impermeable building cover. The native soil (silty clay) has a very low permeability compared to the backfill, as evident by the tight silty clay formation preventing infiltration of groundwater in the excavation base while the excavation was open up to 30 feet below grade (typical depth to groundwater ranges from two to eight feet at the site).

Thank you, and have a nice weekend!

DILLON PLAMANN | Project Hydrogeologist
Fehr Graham | Engineering & Environmental

909 North 8th Street, Suite 101
Sheboygan, WI 53081
C: 920.946.2407
fehrgraham.com

From: Schultz, Josie M - DNR <josie.schultz@wisconsin.gov>
Sent: Tuesday, November 09, 2021 8:58 AM
To: Dillon Plamann <dplamann@fehr-graham.com>
Cc: Matt Dahlem <mdahlem@fehr-graham.com>
Subject: RE: BAY TOWEL - SOLVENT INVESTIGATION, BRRTS #0205237064

Hi Dillon,

This email is to follow-up on the two pieces of information discussed on the phone this morning that DNR will need prior to the virtual meeting:

1. Cross section(s) through the source area, S. Adams St. & Chicago St. that visually represent the identified soil and groundwater contamination with respect to soil type, groundwater level(s) and utility depth(s)/location(s);
2. A description of the permeability of the compacted gravel backfill with respect to the former impermeable building cover.

Thank you,
Josie

We are committed to service excellence.

Visit our survey at <http://dnr.wi.gov/customersurvey> to evaluate how I did.

Josie Schultz

Cell Phone: (920) 366-5685

Josie.Schultz@Wisconsin.gov



From: Schultz, Josie M - DNR

Sent: Tuesday, November 9, 2021 7:40 AM

To: Dillon Plamann <dplamann@fehr-graham.com>

Cc: Matt Dahlem <mdahlem@fehr-graham.com>

Subject: RE: BAY TOWEL - SOLVENT INVESTIGATION, BRRTS #0205237064

Hi Dillon,

Would you also be able to provide a cross section that includes utility depths for Bay Towel this week?

We are committed to service excellence.

Visit our survey at <http://dnr.wi.gov/customersurvey> to evaluate how I did.

Josie Schultz

Cell Phone: (920) 366-5685

Josie.Schultz@Wisconsin.gov



From: Schultz, Josie M - DNR

Sent: Monday, November 8, 2021 12:16 PM

To: Dillon Plamann <dplamann@fehr-graham.com>

Cc: Matt Dahlem <mdahlem@fehr-graham.com>; Donald P. Gallo <DGallo@axley.com>; John Butz <jbutz@baytowel.com>; Silje Roalsvik <sroalsvik@resolutemgmt.com>; Nancy Reid

<nreid@resolutemgmt.com>; Jeanne Tarvin (jtarvin@ramboll.com) <jtarvin@ramboll.com>

Subject: RE: BAY TOWEL - SOLVENT INVESTIGATION, BRRTS #0205237064

Good Afternoon Dillon,

DNR has reviewed the “Remedial Action Documentation Report, Groundwater Monitoring Status Report, and PFAS Sampling Report” for the Bay Towel site, and would like to schedule the hour-long technical assistance meeting for the week of 11/15 or 11/22. Below are dates and times that will work for DNR:

- Wednesday, November 17 – 11:30 to 2:30
- Thursday, November 18 – 1:30 to 4:00
- Monday, November 22 – 1:00 to 4:00
- Tuesday, November 23 – 10:30 to 12:00 or 1:00 to 2:00
- Wednesday, November 24 – 9:00 to 1:00 or 2:00 to 4:00

Please let me know as soon as possible what dates and times will work best for all interested parties, and who we should expect to be on the call.

Thank you,
Josie

We are committed to service excellence.

Visit our survey at <http://dnr.wi.gov/customersurvey> to evaluate how I did.

Josie Schultz

Cell Phone: (920) 366-5685

Josie.Schultz@Wisconsin.gov



From: Dillon Plamann <dplamann@fehr-graham.com>

Sent: Friday, October 15, 2021 3:30 PM

To: Schultz, Josie M - DNR <josie.schultz@wisconsin.gov>

Cc: Matt Dahlem <mdahlem@fehr-graham.com>; Donald P. Gallo <DGallo@axley.com>; John Butz <jbutz@baytowel.com>; Silje Roalsvik <sroalsvik@resolutemgmt.com>; Nancy Reid <nreid@resolutemgmt.com>; Jeanne Tarvin (jtarvin@ramboll.com) <jtarvin@ramboll.com>

Subject: BAY TOWEL - SOLVENT INVESTIGATION, BRRTS #0205237064

CAUTION: This email originated from outside the organization. Do not click links or open attachments unless you recognize the sender and know the content is safe.

Good afternoon Josie,

We submitted the "Remedial Action Documentation Report, Groundwater Monitoring Status Report, And PFAS Sampling Report" for the Bay Towel site this afternoon. Included with the report is a *Technical Assistance, Environmental Liability Clarification or Post-Closure Modification Request* and a fee of \$700, to "Schedule a Technical Assistance Meeting" to discuss the current site status, and determine the necessary tasks required to close the case.

Please let us know if you have any questions with the report, and some potential dates/times for the technical assistance meeting so we can make sure it works with everyone's schedules.

Thank you, and have a nice weekend!

DILLON PLAMANN | Project Hydrogeologist
Fehr Graham | Engineering & Environmental

909 North 8th Street, Suite 101
Sheboygan, WI 53081
C: 920.946.2407
fehrgraham.com

From: no-reply@wisconsin.gov <no-reply@wisconsin.gov>
Sent: Friday, October 15, 2021 2:23 PM
To: Jeanie Angel <jangel@fehr-graham.com>
Subject: 0205237064: Remedial Action Design Report (NR 724)

Please do not reply to this email.

Dear Jeanie Angel

Thank you for your submittal.

Confirmation Number: 35918
BRRTS #: 0205237064
Site Name: BAY TOWEL - SOLVENT INVESTIGATION
Type of Report: Remedial Action Design Report (NR 724)
Fee Amount: 700.00
Name: Jeanie Angel
Company: Fehr Graham
Other DNR RR Contact:
This submittal contains:

- An evaluation of potential or known use of or impacts from PFAS.

Additional Information:

1. Please print this page and mail it with your check to:
DNR Service Center
Attn: DENISE DANELSKI
2984 SHAWANO AVE
GREEN BAY 54313-6727
2. Please send the paper copy of your submittal to JOSIE SCHULTZ. Please see the [DNR staff directory](#) to look up the address.

A submittal is not considered complete until the fee (if applicable), paper and electronic copy of the document or report are received, per Wis. Admin. Code § NR 749.04 (1) and § NR 700.11 (3g) respectively.

For more information please see the [Guidance for submitting Documents to the Remediation and Redevelopment Program \(RR-690\)](#).

If you have questions please contact:
DENISE DANELSKI
denise.danelski@wisconsin.gov
(920) 510-4537

Be reminded that site investigations shall include an evaluation of hazardous substance discharges and environmental pollution including emerging contaminants in accordance with Wis. Admin. Code §NR 716.07, and evaluations shall be submitted as part of scoping to the Department in accordance with Wis. Admin. Code §NR. 716.09(2)(d).