

FEB. -15' 00 (TUE) 14:24 GENERAL

TEL:608 267 2750

P. 003/005

STATE OF WISCONSIN
DEPARTMENT OF NATURAL RESOURCES
GEOGRAPHIC NAMES COUNCIL
BOX 7921
MADISON, WISCONSIN 53707

GEOGRAPHIC NAME PROPOSAL
FORM 2200-124 2-79

DATE	September 21, 2000
COUNTY	Sawyer

RECOMMENDED NAME OF FEATURE
Heron Creek

OTHER NAMES OR SPELLINGS IN USE
now Squaw Creek

BY WHOM
Sawyer County Board of Supervisors

LOCATION OF FEATURE

STREAM

HEADS: SEC. 22, T 38N N, R 9W E/W

ENDS: SEC. 4, T 37N N, R 9W E/W

LAKE, VILLAGE, ETC.

SECS. _____, T _____ N, R _____ E/W

SECS. _____, T _____ N, R _____ E/W

(OR LOCATE BY LANDMARKS AND ATTACH MAP)

LEAVE BLANK - DEPARTMENT USE ONLY		
LAT. _____ ° _____ ' _____ "	LONG. _____ ° _____ ' _____ "	
LAT. _____ ° _____ ' _____ "	LONG. _____ ° _____ ' _____ "	
LAT. _____ ° _____ ' _____ "	LONG. _____ ° _____ ' _____ "	
USGS QUAD. _____	NAME _____	INDEX NO. _____

DESCRIPTION OF FEATURE: SIZE (ACRES), LENGTH (MILES) OR POPULATION, ETC.
creek flowing through Heron Lake and eventually into Lake Chetac

REASON FOR THIS PROPOSAL (IDENTIFY PROBLEM AND NEED) (ATTACH SUPPLEMENTARY SHEET IF NECESSARY)
objection by County residents, including Lac Courte Oreilles Tribal Governing Board, to the use of the word squaw. Heron Creek suggested by the Town of Edgewater as the creek runs through Heron Lake.

ORIGIN AND SIGNIFICANCE OF RECOMMENDED NAME (ATTACH SUPPORTING DOCUMENTS - RESOLUTION, HISTORICAL DATA, ETC.)
I suspect the presence of herons in the lake.

NOTE: GUIDELINES FOR NAMES ON REVERSE SIDE. SEND FORM AND INQUIRIES TO ABOVE ADDRESS.

APPLICANT'S SIGNATURE
Kris Mayberry
Kris Mayberry, Sawyer County Clerk
STREET OR ROUTE
P.O. Box 273
CITY, STATE, ZIP CODE
Hayward, Wisconsin 54843

AGENCY
Sawyer County Board of Super-
visors
TELEPHONE NUMBER
715.634.4866

LEAVE BLANK - FOR DEPARTMENT MAP SEARCH AND FIELD INVESTIGATION USE		
NAME OF MAP OR OTHER REFERENCE	DATE OF REF.	NAME GIVEN FEATURE
PERSONS CONTACTED (NAME, ADDRESS AND OCCUPATIONS)		
SPECIAL CONCERNS		
FINDINGS AND RECOMMENDATION		

SAND LAKE NORTH PART EDGEWATER T.38N.-R.9W.

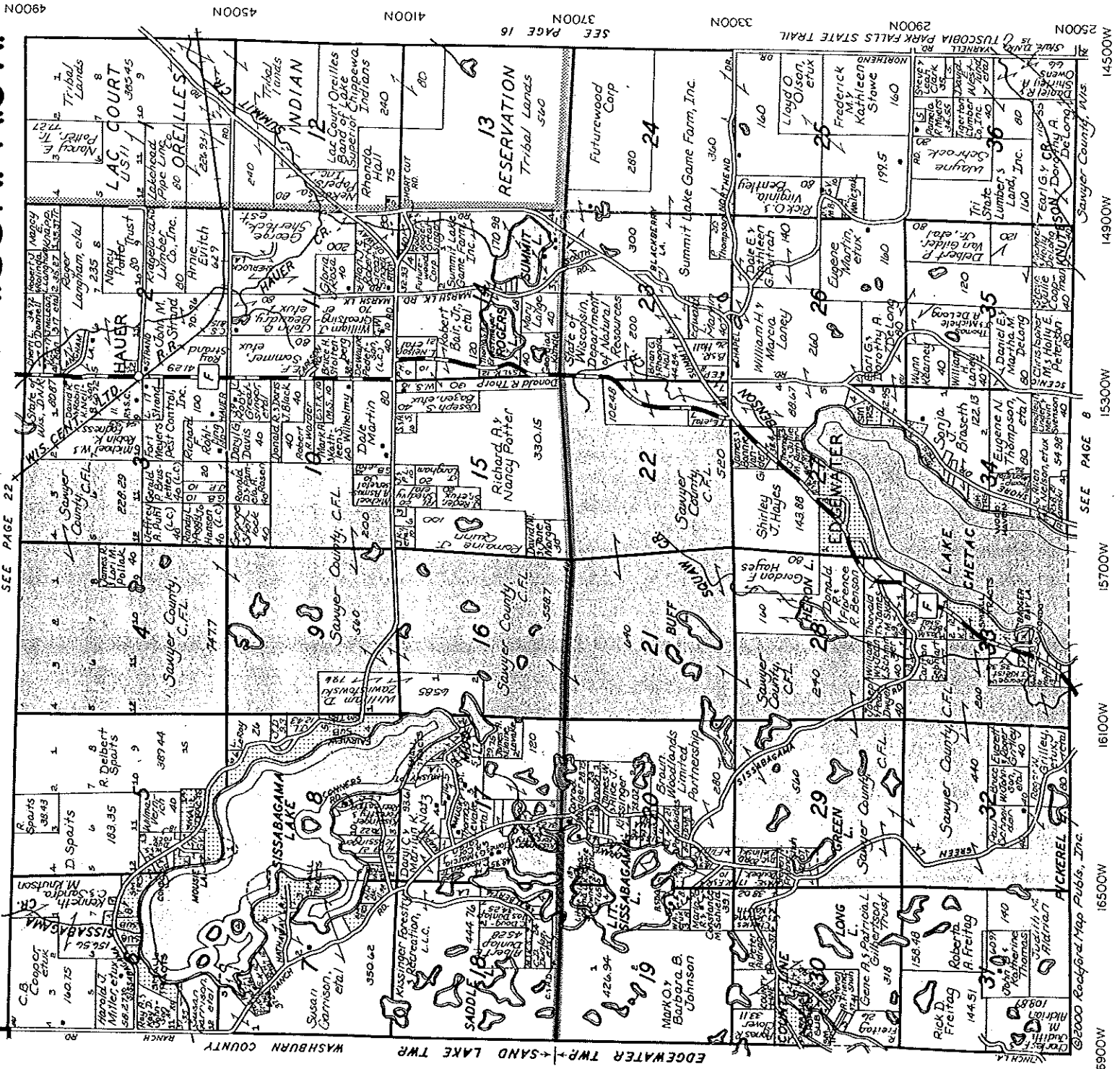

cfb Community First
 Member FDIC
 National Bank

"FOR ALL OF YOUR FINANCIAL NEEDS"

Spooner: 635-2161
 118 Elm Street

Economart Branch: 635-3637
 700 South River Street, Spooner

Stone Lake: 865-3461
 Highway 70 & 1st
 Minong: 466-2251
 Highway 77

