

LAKE SURVEY MAP

WISCONSIN CONSERVATION DEPARTMENT
 BIOLOGY DIVISION
 LAKE AND STREAM IMPROVEMENT SECTION

LAKE HORSE SHOE
 SECTION 10-15
 TOWNSHIP 31 N
 RANGE 8 W
 TOWN OF CLEVELAND
 COUNTY CHIPPEWA

FORM FI-117

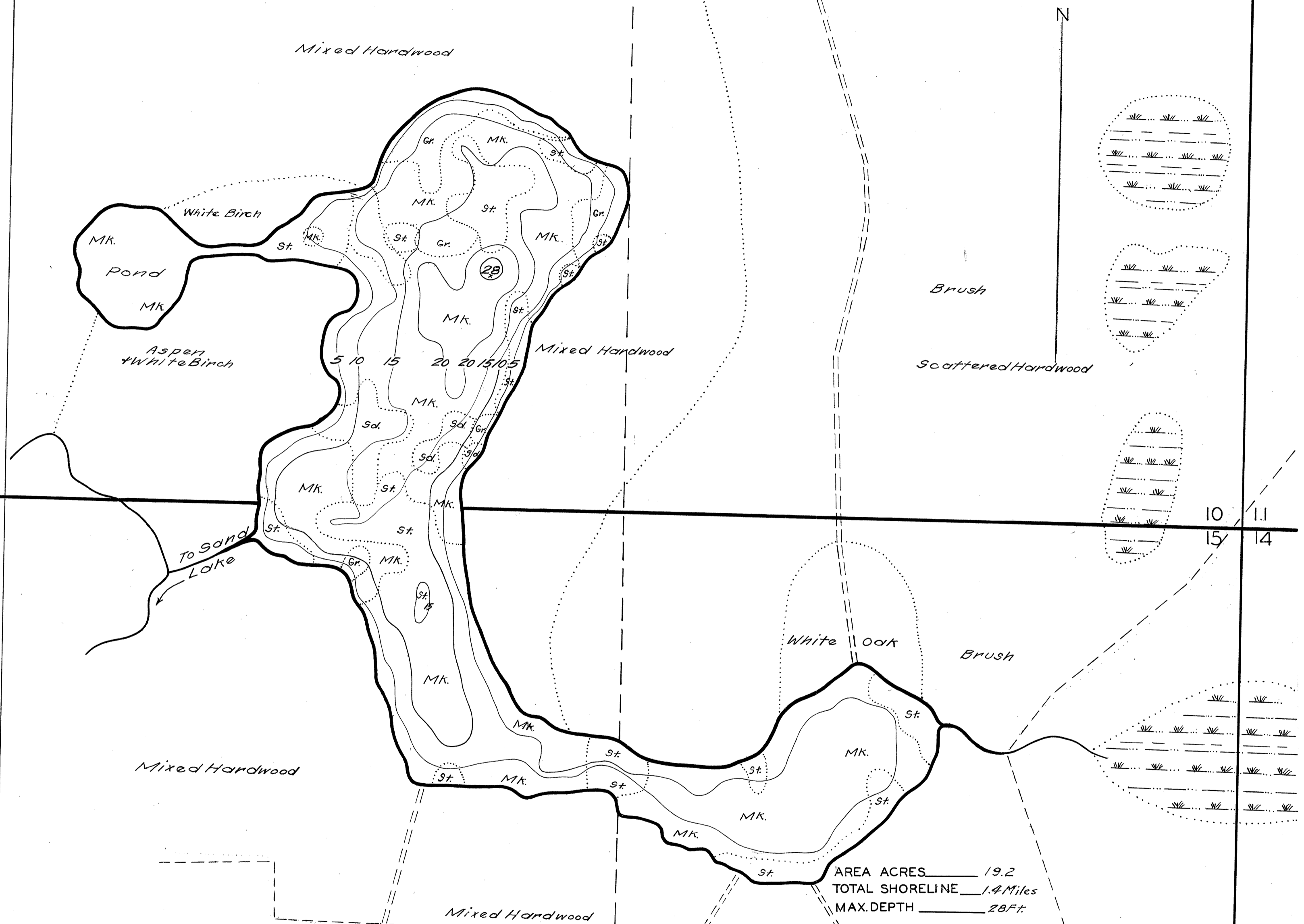

DATE JULY 15 1941
 COMPILED BY _____
 TRACED BY W.T.Z. (W.P.A.)
 SOURCE OF INFORMATION
W.P.A. Lake Survey Project

 SOUNDINGS 66 Ft. intervals

 DATES OF MAP REVISION _____

 WORK AGENCY W. P. A.

| TYPE | DATE | | | |
|-------------------|-------|-------|-------|-------|
| ○ BRUSH REFUGES | _____ | _____ | _____ | _____ |
| ○ SAPLING TANGLES | _____ | _____ | _____ | _____ |
| □ SPAWNING BOXES | _____ | _____ | _____ | _____ |
| * MINNOW SPAWNERS | _____ | _____ | _____ | _____ |
| TOTAL | _____ | _____ | _____ | _____ |

SCALE 1 inch Equals 65 Ft.
 0 50 100 150 200 250 300 350 400 450 500 Ft.

- LEGEND
- WEED BEDS
 - ROCKY SHOALS
 - Sd.* SAND
 - c.l.* CLAY
 - Gr.* GRAVEL
 - Mk.* MUCK
 - DWELLING
 - ABANDONED DWELLING
 - RESORT
 - Silt-St*

CHECKED BY
 W.P.S.-D.A.B.
 7-29-41

Source: Wisconsin Department of Natural Resources 608-266-2621
Horse Shoe Lake – Chippewa County, Wisconsin DNR Lake Map
Date – Jul 1941 - Historical Lake Map - Not for Navigation
A Public Document - Please Identify the Source when using it.