

Tract 5-23 (Elk Haven't) -- Flambeau River State Forest

Parts of: SWSW Sec 28; SESW, SE Sec 29; NE, N½SE Sec 32;
W½NW, NWSW Sec 33, T38N-R3W, Town of Winter, Sawyer County.

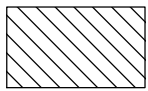

1:15,840



Selection Area (221 acres) – Bounded by red paint and blue paint. Harvest all orange marked trees within the designated boundaries. Sever all orange marked unmerchantable stems. Leave all 1) snags, and 2) trees marked with an orange X .

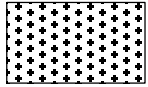

Coppice Area (8 acres) – Bounded by yellow paint. Harvest all trees greater than 2 inch except for: 1) white pine, 2) red pine, 3) hemlock, and 4) oak.



Tamarack Strips (1 acre) – Harvest all trees greater than 2 inch within 60 feet on both sides of orange marked center line except for: 1) white pine, 2) cedar, and 3) hemlock. Strips are a total of 120 feet wide. Cut orange marked trees.

Total Acres: 230

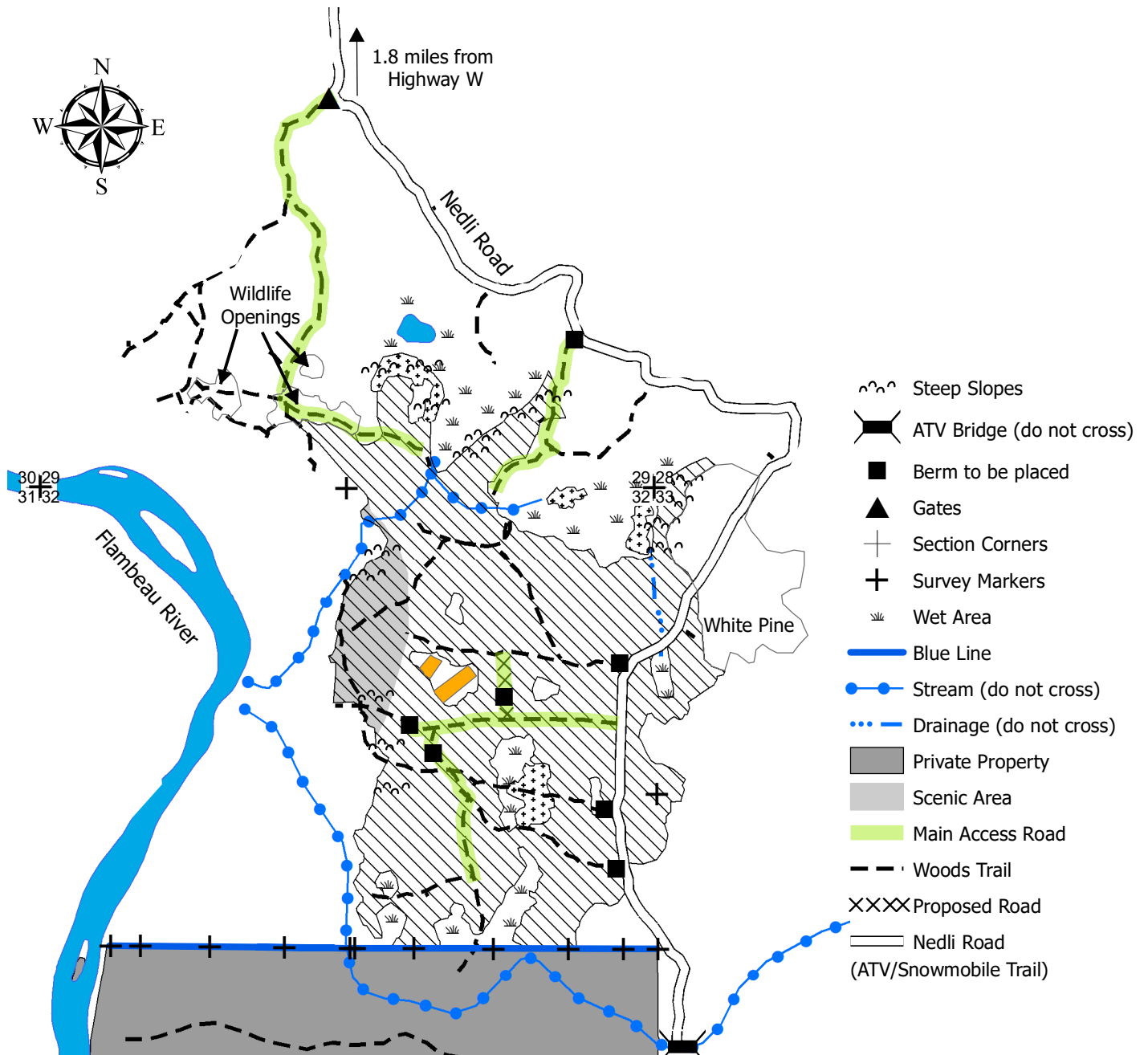

0 0.25 0.5 1 Miles

Mapped by Taylor Lockwood

This map is for informational purposes only and may not have been prepared for or be suitable for legal, engineering or surveying purposes. The user is solely responsible for verifying the accuracy of information before using for any purpose. By using this product for any purpose user agrees to be bound by all disclaimers found here: <https://dnr.wisconsin.gov/legal>.