

WISCONSIN DNR TIMBER SALE
 "SPRUCE WIPEOUT" TRACT 1-22
 40 ACRES CLEARCUT WITH RESERVES
 8 ACRES RESERVE

White River Wildlife Area
 NWSE, NESE, SENE Section 35 T47N R4W
 Town of Gingles, Ashland County
 DNR Contact Avery Jehnke
 920-604-5631 averya.jehnke@wi.gov

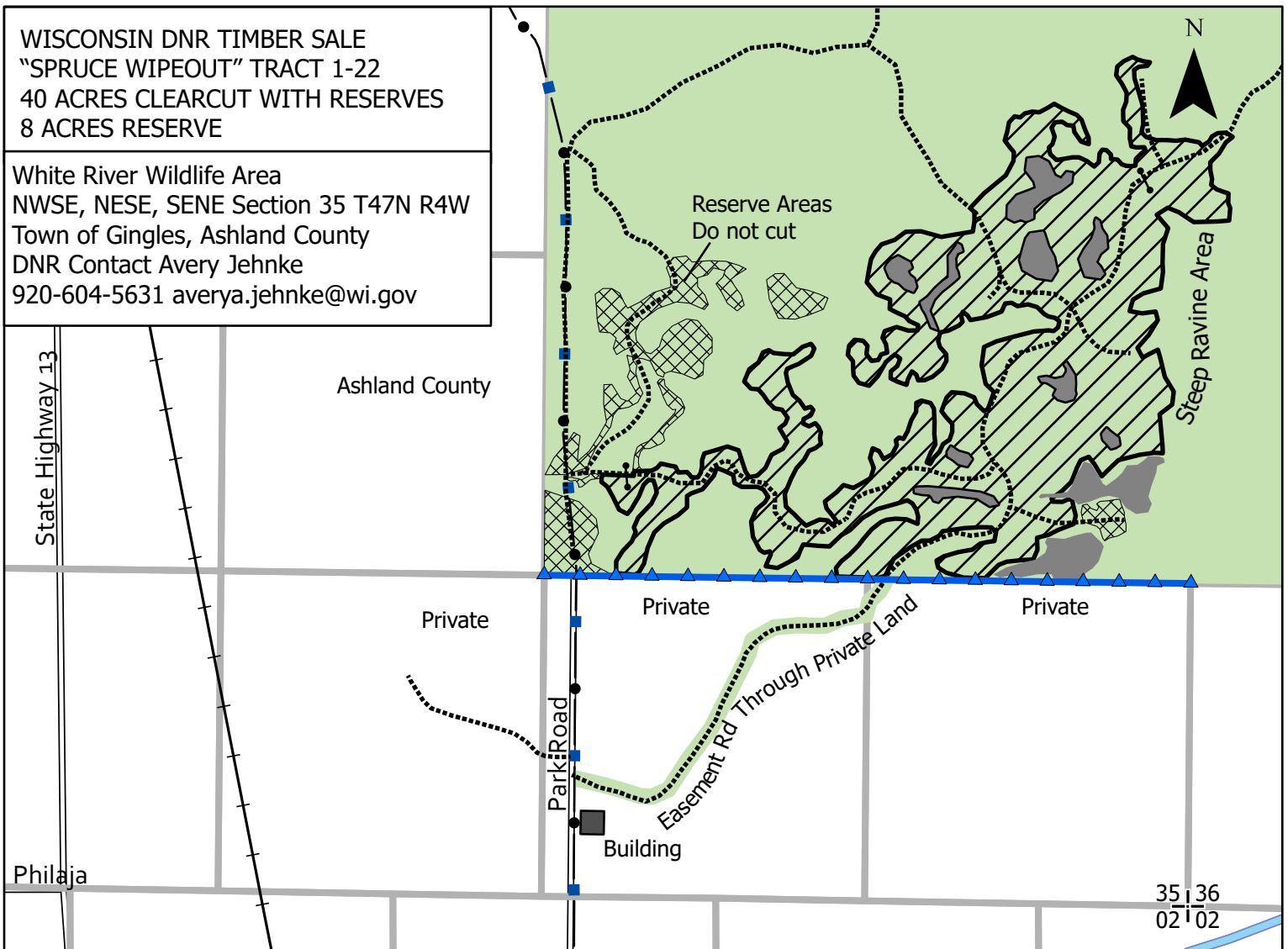

Map prepared April 2022 by A. Jehnke
 This map is not a survey of the actual
 boundary of any property it depicts.



0 0.07 0.15 0.3 Miles

1:7920
 1" = 1/8 Mile

General Sale Conditions:

- Contract end date June 30, 2026
- Ticket scale sale
- Sale boundaries marked with red paint or unmarked using natural boundaries
- Excessive rutting or damage to residual trees will result in suspension of logging activities
- Care must be taken to preserve all survey monuments
- Retain all suitable snag and den trees that do not pose a safety hazard
- Reserve all red marked boundary trees
- Utilize all trees to a 4-inch minimum top diameter
- Scatter all slash and cut to within 2 feet of the ground
- New roads, trails and landings must be approved by the sale administrator
- Equipment must be clean before entering sale area
- Snowmobile Trail must be kept clear and free of debris during harvesting and hauling operations
- Cautionary signage shall be posted on Park Road and snowmobile trail.

Cutting Specifications:

- Cut all trees greater than 1" DBH except designated reserve trees and trees marked with green paint.
 - Designated reserve trees are: Red Pine, White Pine, Cedar and Oak.
 - Aspen (4-6" DBH) at the edges of sale area should be left uncut.
- Harvesting and hauling will be limited to **FROZEN GROUND CONDITIONS ONLY.**

Estimated Volumes:

SPRUCE	900 TONS
ASPEN	500 TONS
MIXED HARDWOOD	140 TONS
TOTAL:	1,540 TONS
Minimum Bid Value:	\$8,800.00

LEGEND

- ▶▶ Blue Paint Line
- Wetland Area
- Woods Roads
- ▨ Harvest Area
- ▩ Reserve- No Harvest
- Snowmobile Trails
- DNR Property
- +— Railroad
- ashland_water2
- + Section Corners
- ▭ 1/4 Section Lines
- Road
- ↘ Gate