

Rib Mountain State Park 2011 Deer Season

Special Regulations – DMU 57D

Only holders of a 2011 Park Access Permit for deer hunting in Rib Mountain State Park (Deer Management Unit 57D) may deer hunt in the park. On all vehicles that enter the park, Park admission stickers are required (\$7 per day or \$25 annually for residents; \$10 per day or \$35 annually for non-residents). Hunters are encouraged to purchase stickers before opening morning to avoid delays at the office.

Season Dates

- Rib Mountain State Park will be open to gun deer hunting November 19 – December 7, 2011 (muzzleloaders only). **NOTE: The Park will not be open to muzzleloader hunting during the statewide December 8-11, 2011 antlerless gun hunt.**
- Archery deer hunting will be open in the park from November 19 – January 8, 2012. Archers must meet blaze orange requirements from November 19 – December 7, 2011 when the muzzleloader season is open.

Weapon Restrictions

- **Only Muzzleloaders** may be used to hunt deer in the park during the November 19 - December 7, 2011 muzzleloader season. Please see the *2011 Wisconsin Deer Hunting Regulations* for muzzleloader restrictions. All firearms must be unloaded and enclosed within a carrying case when in or on a motor vehicle or within a closed area of the park. Note: Muzzleloaders are considered unloaded if the cap is removed from a cap lock muzzleloader, or the flash pan is cleaned on a flint-lock muzzleloader; the ball and powder may remain in the barrel, except that the powder and projectile must be removed from the barrel of an electronic ignition muzzleloader.

Tagging Options

- **Unit 57D is NOT a Regular Unit as incorrectly stated on page 43 of the 2011 Wisconsin Deer Hunting Regulations.**
- **Herd Control regulations apply in Rib Mountain State Park for the 2011 park deer hunting season** (see the *2011 Wisconsin Deer Hunting Regulations booklet* for tagging requirements).
- Muzzleloader and Archery hunters that receive a Park Access Permit for unit 57D may use their Buck Deer Carcass Tag to tag a buck with the respective weapon type and during the seasons listed above.
- In addition, muzzleloader and archery hunters may tag additional antlerless deer per Antlerless Deer Carcass Tag valid in Herd Control or Earn-a-Buck Units. One tag comes free with each gun deer license and two antlerless tags come free with each archery deer license.
- Additional Antlerless Herd Control Carcass Tags valid in “Herd Control & EAB” units are \$2 each (for residents and non-residents) and may be purchased online or at any DNR license sales location.

Hunting Hours

- Hunting hours are found in the *2011 Wisconsin Hunting Regulations (pages 50 – 51)*. Hunters may enter the park up to one hour before the legal hunting hours begin for that day.

Deer Registration

- Deer will not be registered at Rib Mountain State Park. Deer must be registered within the adjacent unit of kill. A list of registration stations is available on the DNR website (dnr.wi.gov) or at DNR Service Centers.
- When registering a deer harvested from Rib Mountain State Park, indicate “57D” as the DMU of Kill.

Additional Park Regulations



- Some areas of the park will be posted as closed areas (see map on back). **No hunting on or shooting into the closed areas is allowed.** A hunter may not pursue a wounded deer moving into any closed hunting area or drive deer from a closed area. Park rangers must be informed by the hunter of the location of any wounded animal within the closed areas.
- Group Hunting is restricted to persons in possession of a 2011 Park Access Permit for unit 57D and a gun deer license. Persons who have filled their carcass tags may continue to engage in group hunting, providing they have their unit 57D Park Access Permits and hunting licenses in their possession.
- Tree stands or elevated devices must be completely removed each date at the close of hunting hours. It is illegal to construct or use tree stands or elevated devices on state property, which causes damage to trees.
- Any tree stand that is not occupied during legal hunting hours shall have the owner’s customer ID number or name and address attached to the tree stand in a manner that is visible to a person on the ground.
- Ground blinds used on DNR lands must have a minimum of 144 square inches of blaze orange material that is highly visible 360 degrees around the blind, any time a gun deer season is in effect.
- Ask permission prior to entering or crossing onto private property.
- There is no open season on any other species of wildlife in the park.
- Use of salt blocks and bait for deer is illegal.
- It is illegal to hunt or shoot from or within 50 feet from the center of public roads, or to shoot across these roadways. It is also illegal to shoot within 100 yards of a building devoted to human occupancy without the permission of the owner or occupant of that building.
- All hunters should be aware of other recreational users in the park. Not all people will be wearing blaze orange, so be sure of your target and beyond.
- The use of paint, tacks or other such items to mark routes to your stand is prohibited and is subject to fines. Ribbons may be used, however they must be removed at the end of hunting season.

Wisconsin Department of Natural Resources
P.O. Box 7921
Madison, WI 53707

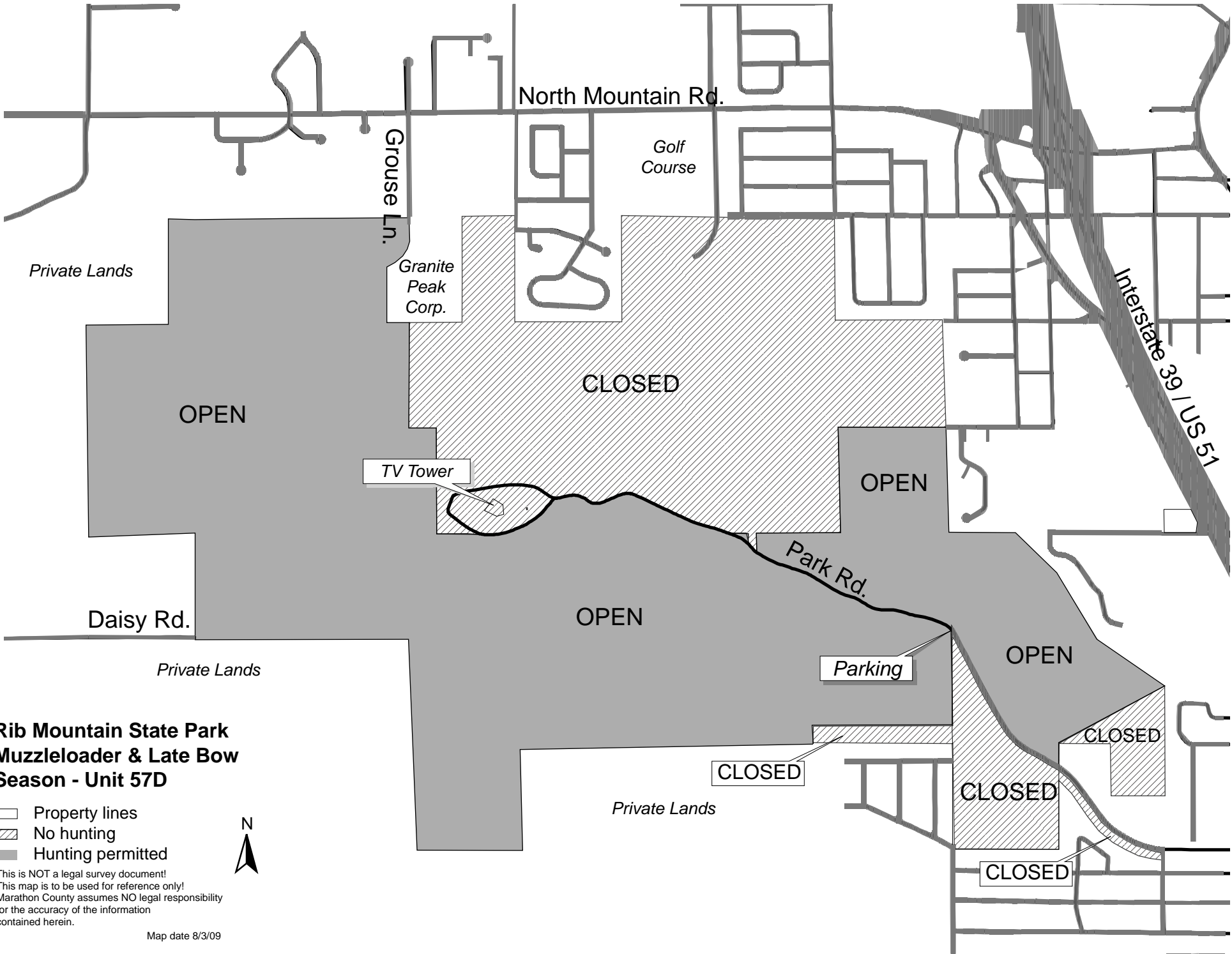



**Rib Mountain State Park
Muzzleloader & Late Bow
Season - Unit 57D**

-  Property lines
-  No hunting
-  Hunting permitted

This is NOT a legal survey document!
This map is to be used for reference only!
Marathon County assumes NO legal responsibility
for the accuracy of the information
contained herein.

Map date 8/3/09

