

SOUTH BEAVER CREEK WILDLIFE AREA

JACKSON COUNTY

See map legend for the activities allowed on the property or contact the DNR Service Center for more property information. PLEASE RESPECT LANDOWNERS' RIGHTS AND OBSERVE ALL PROPERTY POSTINGS.

For more information:
PROPERTY MANAGER
C/O BLACK RIVER FALLS SERVICE CENTER
910 HWY 54 E
BLACK RIVER FALLS, WI 54615-9276
715-284-1403

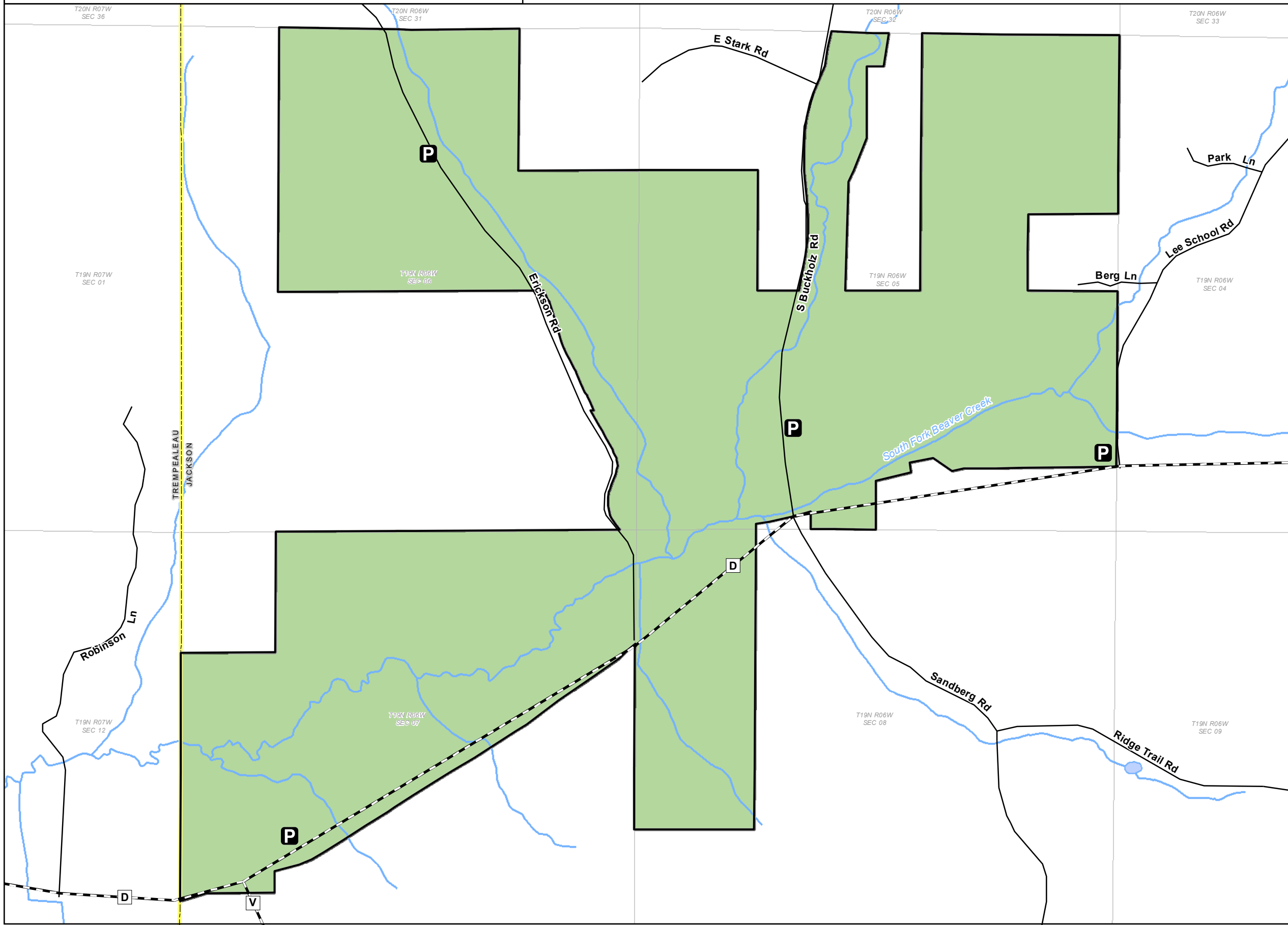

DNR Managed Land

- Open DNR Wildlife Land
- Other DNR Land

Easement Use

- Hunting and Fishing
- Fishing Only
- Hunting Only
- Open, No Hunting or Fishing

State Trail

Parking Area

Boat Access

Section Boundary

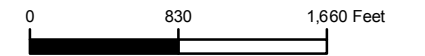

5280 feet = 1 mile



The data shown on this map have been obtained from various sources, and are of varying age, reliability and resolution. This map is not intended to be used for navigation, nor is this map an authoritative source of information about legal land ownership or public access. Users of this map should confirm the ownership of land through other means in order to avoid trespassing. No warranty, expressed or implied, is made regarding accuracy, applicability for a particular use, completeness, or legality of the information depicted on this map.

Wisconsin Department of Natural Resources



Featured property funded in part by
Knowles-Nelson Stewardship Fund
WM-8581 acr

Last revision date: Oct 15, 2010

http://dnr.wi.gov/org/land/facilities/dnr_land_mapping.html