

# COLBURN WILDLIFE AREA

ADAMS COUNTY

See map legend for the activities allowed on the property or contact the DNR Service Center for more property information.  
PLEASE RESPECT LANDOWNERS' RIGHTS AND OBSERVE ALL PROPERTY POSTINGS.

For more information:  
PROPERTY MANAGER  
C/O FRIENDSHIP RANGER STATION  
HWY 13  
FRIENDSHIP, WI 53934-0100  
608-339-4819

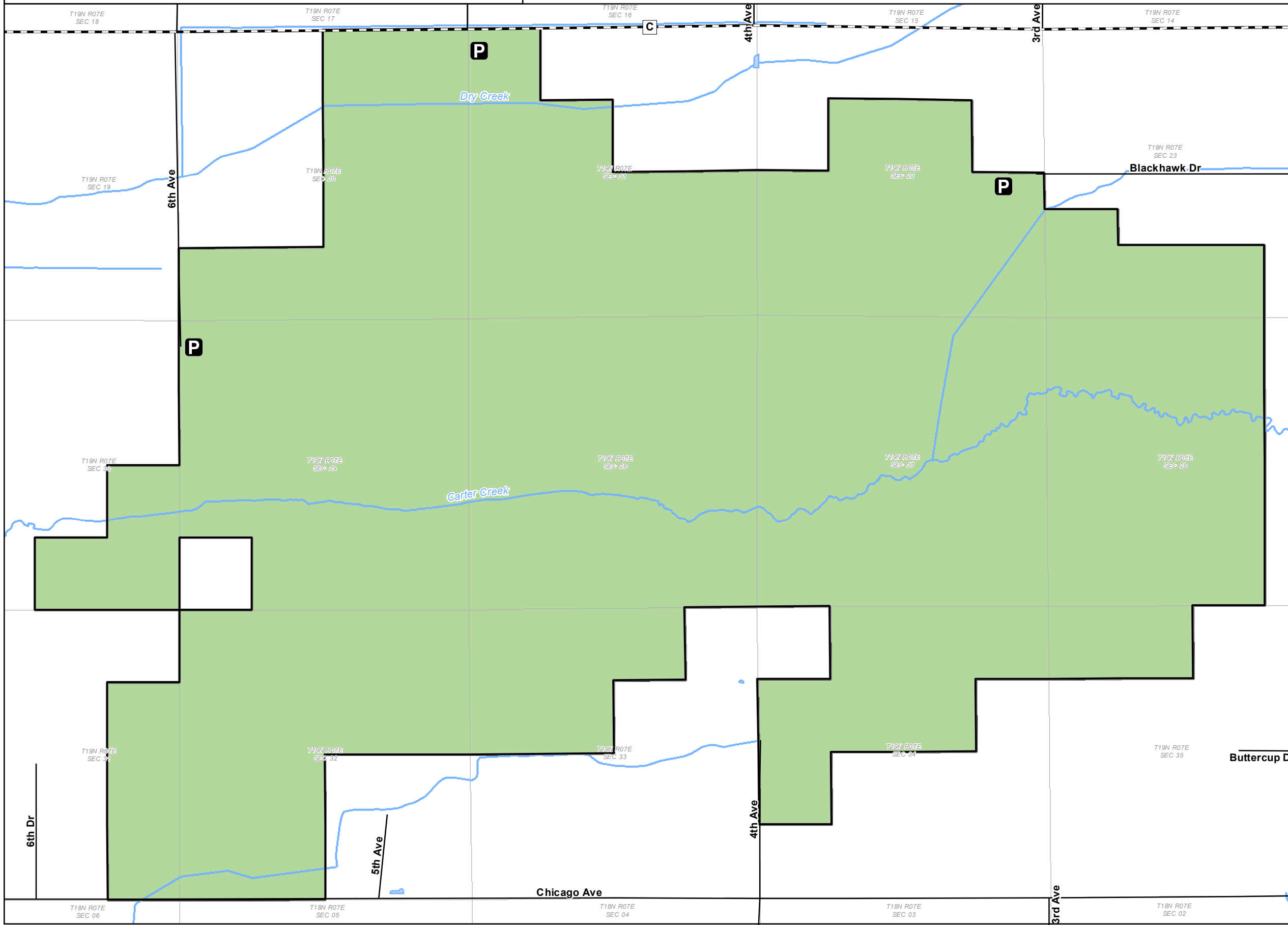

## DNR Managed Land

- Open DNR Wildlife Land
- Other DNR Land

## Easement Use

- Hunting and Fishing
- Fishing Only
- Hunting Only
- Open, No Hunting or Fishing

State Trail

P Parking Area

▶ Boat Access

Section Boundary

0 1,300 2,600 Feet

5280 feet = 1 mile



The data shown on this map have been obtained from various sources, and are of varying age, reliability and resolution. This map is not intended to be used for navigation, nor is this map an authoritative source of information about legal land ownership or public access. Users of this map should confirm the ownership of land through other means in order to avoid trespassing. No warranty, expressed or implied, is made regarding accuracy, applicability for a particular use, completeness, or legality of the information depicted on this map.

Wisconsin Department of Natural Resources



Featured property funded in part by  
Knowles-Nelson Stewardship Fund  
WM-7320 acr

Last revision date: Oct 18, 2010

[http://dnr.wi.gov/org/land/facilities/dnr\\_land\\_mapping.html](http://dnr.wi.gov/org/land/facilities/dnr_land_mapping.html)