

ENGLE CREEK SPRINGS FISHERY AREA

BARRON COUNTY

See map legend for the activities allowed on the property or contact the DNR Service Center for more property information.
PLEASE RESPECT LANDOWNERS' RIGHTS AND OBSERVE ALL PROPERTY POSTINGS.

For more information:
PROPERTY MANAGER
DNR OFFICE
1341 2ND AVE
BARRON WI 54812
715-637-6866

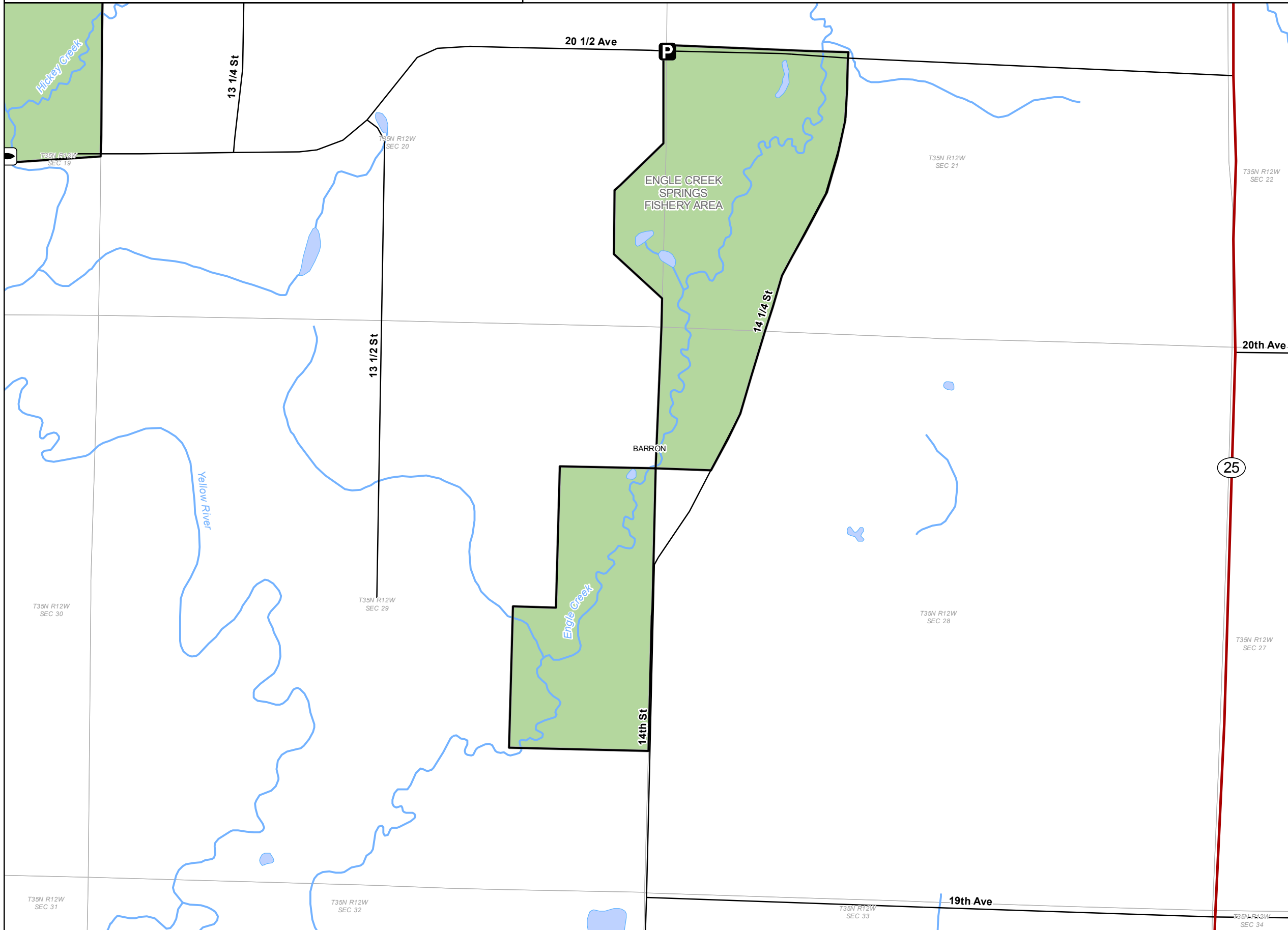

- ### DNR Managed Land
- Open DNR Fishery Land
 - Other Open DNR Land
 - Seasonally Closed Area
- ### Easement Use
- Hunting and Fishing
 - Fishing Only
 - Hunting Only
 - Open, No Hunting or Fishing
- State Trail
 - Boat Access
 - Parking Area
 - Section Boundary

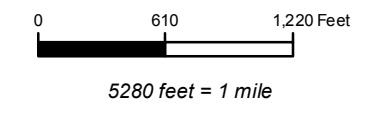

The data shown on this map have been obtained from various sources, and are of varying age, reliability and resolution. This map is not intended to be used for navigation, nor is this map an authoritative source of information about legal land ownership or public access. Users of this map should confirm the ownership of land through other means in order to avoid trespassing. No warranty, expressed or implied, is made regarding accuracy, applicability for a particular use, completeness, or legality of the information depicted on this map.

Wisconsin Department of Natural Resources

