

BEAN BROOK FISHERY AREA EAST

WASHBURN COUNTY

See map legend for the activities allowed on the property or contact the DNR Service Center for more property information. PLEASE RESPECT LANDOWNERS' RIGHTS AND OBSERVE ALL PROPERTY POSTINGS.

For more information:
PROPERTY MANAGER
SPOONER SERVICE CENTER/NOR HDQ WEST
810 W MAPLE ST
SPOONER WI 54801
715-635-4091

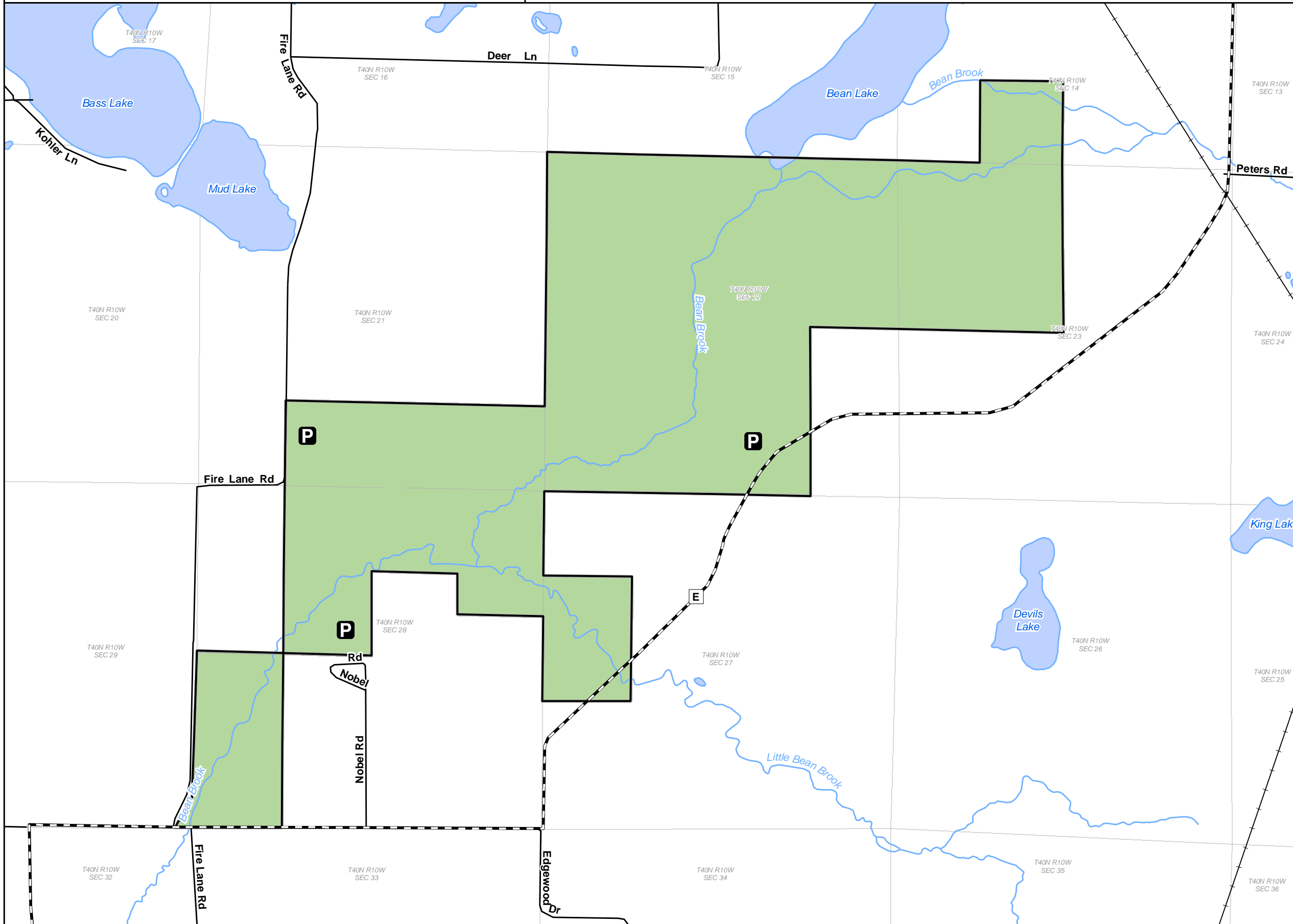

DNR Managed Land

- Open DNR Land
- Other DNR Land

Easement Use

- Hunting and Fishing
- Fishing Only
- Hunting Only
- Open, No Hunting or Fishing

State Trail

Parking Area

Boat Access

Section Boundary

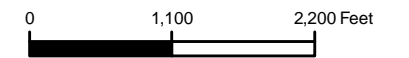

5280 feet = 1 mile



The data shown on this map have been obtained from various sources, and are of varying age, reliability and resolution. This map is not intended to be used for navigation, nor is this map an authoritative source of information about legal land ownership or public access. Users of this map should confirm the ownership of land through other means in order to avoid trespassing. No warranty, expressed or implied, is made regarding accuracy, applicability for a particular use, completeness, or legality of the information depicted on this map.

Wisconsin Department of Natural Resources



Featured property funded in part by
Knowles-Nelson Stewardship Fund

FM-100 acr

Last revision date: Nov 15, 2010

http://dnr.wi.gov/org/land/facilities/dnr_land_mapping.html