

LAKE SURVEY MAP

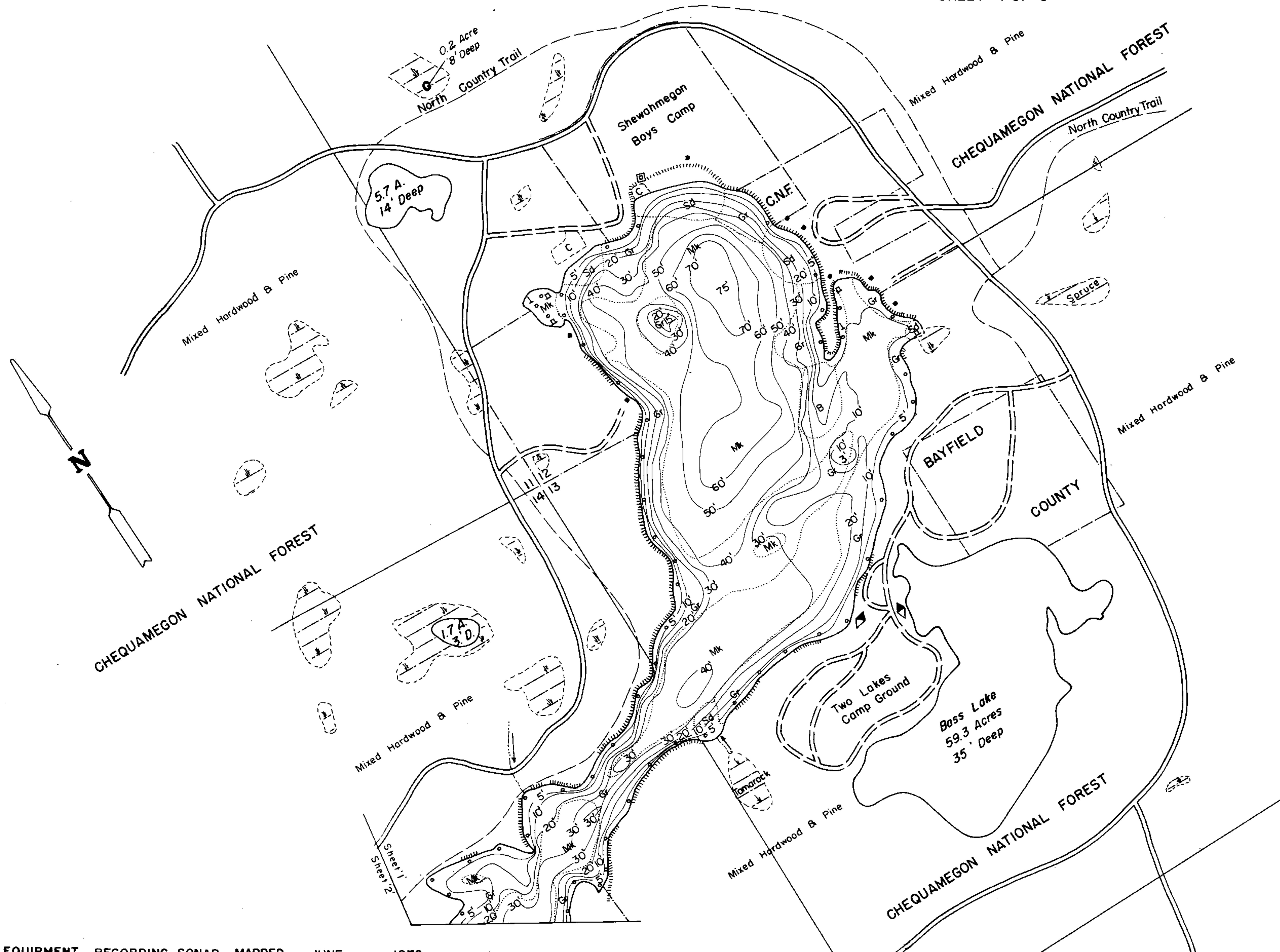

EQUIPMENT RECORDING SONAR MAPPED JUNE 1972

- TOPOGRAPHIC SYMBOLS**
- (B) Brush
 - (PW) Partially wooded
 - (W) Wooded
 - (C) Cleared
 - (P) Pastured
 - (A) Agricultural
 - B.M. Bench Mark
 - Dwelling
 - Resort
 - Camp

- LAKE BOTTOM SYMBOLS**
- P. Peat
 - Mk. Muck
 - C. Clay
 - M. Marl
 - Sd. Sand
 - St. Silt
 - Gr. Gravel
 - R. Rubble
 - Bc. Bedrock
 - Steep slope
 - Indefinite shoreline
 - Marsh
 - Spring
 - Intermittent stream
 - Permanent inlet
 - Permanent outlet
 - Dam
 - D.N.R. State owned land
 - Boulders
 - Stumps & Snags
 - Rock danger to navigation
 - Submergent vegetation
 - Emergent vegetation
 - Floating vegetation
 - Brush shelters

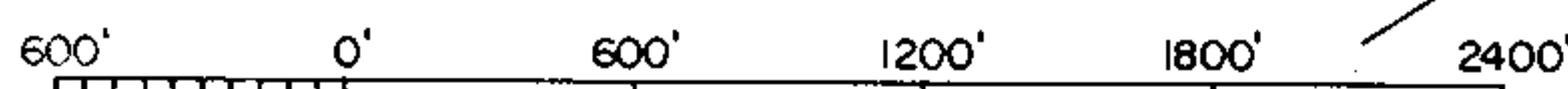

Access Access with Parking Boat Livery

Drawn by: C. Holt
Field work by: C. Busch, G. Lund, J. Sather

SPECIES OF FISH	Abundance		
	Abundant	Common	Present
Muskie			
N. Pike		X	
Walleye		X	
L. M. Bass		X	
S. M. Bass		X	
Panfish		X	
Trout			

WATER AREA 1323.3 ACRES
 UNDER 3 FT. 6 %
 OVER 20 FT. 59 %
 MAX. DEPTH 95 FEET.
 TOTAL ALK. 64 P.P.M.
 VOLUME 36,250 ACRE FT.
 SHORELINE 24.00 MILES
 SHORELINE 2500 MILES WITH IS.

B.M.' 442-C 2' square cut in top of
center of upstream bridge wall below dam
Assumed elevation 101.25'
Water level 96.53' (6-22-72')

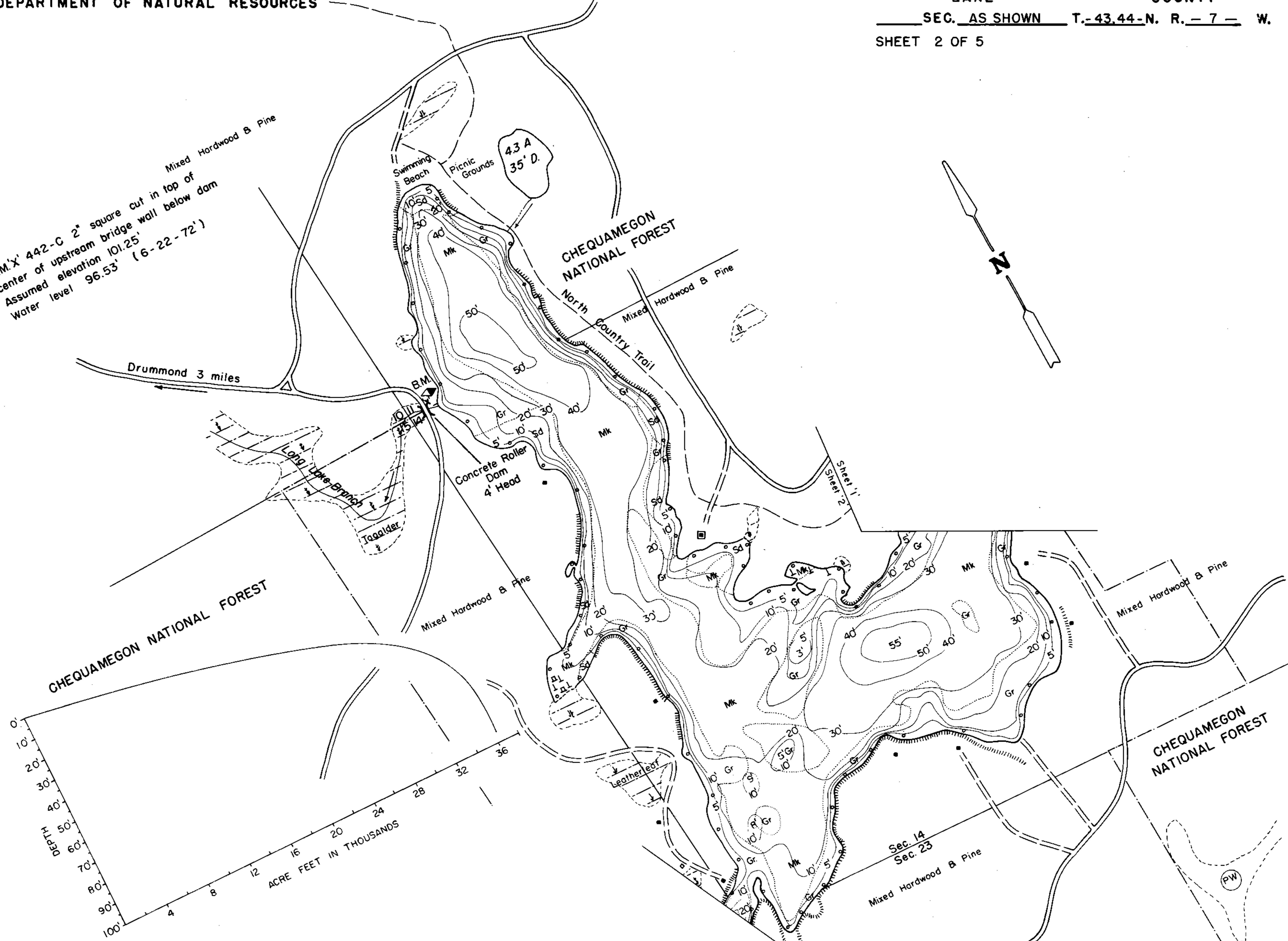

EQUIPMENT RECORDING SONAR MAPPED		JUNE 1972	
TOPOGRAPHIC SYMBOLS		MONTH YEAR LAKE BOTTOM SYMBOLS	
(B) Brush	Steep slope	P. Peat	B Boulders
(PW) Partially wooded	~ Indefinite shoreline	Mk. Muck	⊙ Stumps & Snags
(W) Wooded	~ Marsh	C. Clay	⊙ Rock danger to navigation
(C) Cleared	~ Spring	M. Marl	T Submergent vegetation
(P) Pastured	~ Intermittent stream	Sd. Sand	I Emergent vegetation
(A) Agricultural	~ Permanent inlet	St. Silt	~ Floating vegetation
B.M. Bench Mark	~ Permanent outlet	Gr. Gravel	⊙ Brush shelters
■ Dwelling	~ Dam	R. Rubble	
□ Resort	D.N.R. State owned land	Br. Bedrock	
□ Camp			



Drawn by: C. Holt
Field work by: C. Busch, G. Lund, L. Saffer

SPECIES OF FISH	Abundant Common Present		
	Abundant	Common	Present
Muskie			
N. Pike	X		
Walleye	X		
L.M. Bass			X
S.M. Bass	X		
Panfish	X		
Trout			

WATER AREA 1323.3 ACRES
 UNDER 3 FT. 6 %
 OVER 20 FT. 59 %
 MAX. DEPTH 95 FEET.
 TOTAL ALK. 64 P.P.M.
 VOLUME 36,250 ACRE FT.
 SHORELINE 24.00 MILES
 SHORELINE 25.00 MILES WITH IS.

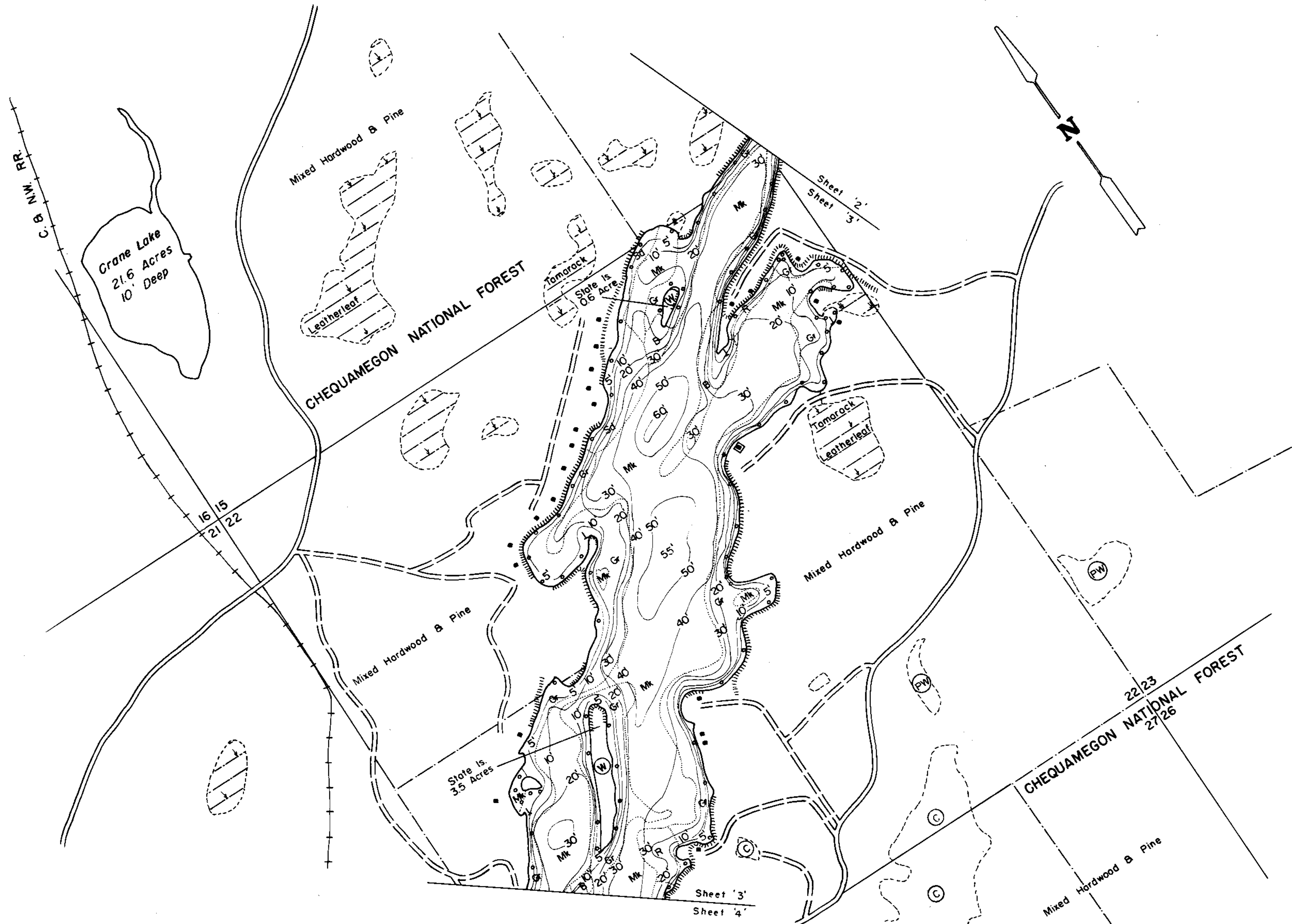

EQUIPMENT RECORDING SONAR MAPPED JUNE 1972

- | TOPOGRAPHIC SYMBOLS | | LAKE BOTTOM SYMBOLS | |
|-----------------------|----------------------------|---------------------|---------------------------|
| (B) Brush | Steep slope | P. Peat | B Boulders |
| (PW) Partially wooded | - - - Indefinite shoreline | Mk. Muck | o Stumps & Snags |
| (W) Wooded | Marsh | C. Clay | Rock danger to navigation |
| (C) Cleared | Spring | M. Marl | T Submergent vegetation |
| (P) Pastured | Intermittent stream | Sd. Sand | ⊥ Emergent vegetation |
| (A) Agricultural | Permanent inlet | St. Silt | ⊥ Floating vegetation |
| B.M. Bench Mark | Permanent outlet | Gr. Gravel | ⊥ Brush shelters |
| ■ Dwelling | Dam | R. Rubble | |
| ■ Resort | D.N.R. State owned land | Bc. Bedrock | |
| ■ Camp | | | |

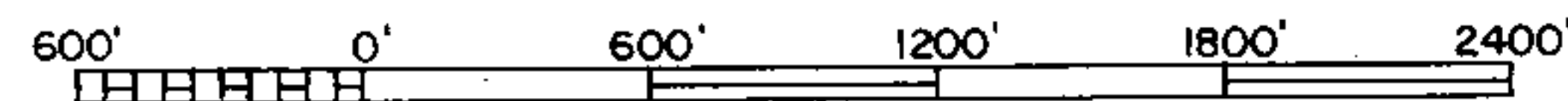

Access Access with Parking Boat Livery

Drawn by: C. Holt
Field work by: C. Busch, G. Lund, L. Sother

SPECIES OF FISH	Abundant Common Present		
	Abundant	Common	Present
Muskie			
N. Pike		X	
Walleye		X	
L. M. Bass		X	
S. M. Bass		X	
Panfish		X	
Trout			

WATER AREA 1323.3 ACRES
 UNDER 3 FT. 6 %
 OVER 20 FT. 59 %
 MAX. DEPTH 95 FEET.
 TOTAL ALK. 64 P.P.M.
 VOLUME 36,250 ACRE FT.
 SHORELINE 24.00 MILES
 SHORELINE 2500 MILES WITH IS.

LAKE SURVEY MAP

OWEN
LAKE

BAYFIELD
COUNTY

SEC. AS SHOWN

T. -43.44-N. R. - 7 - W.

SHEET 4 OF 5

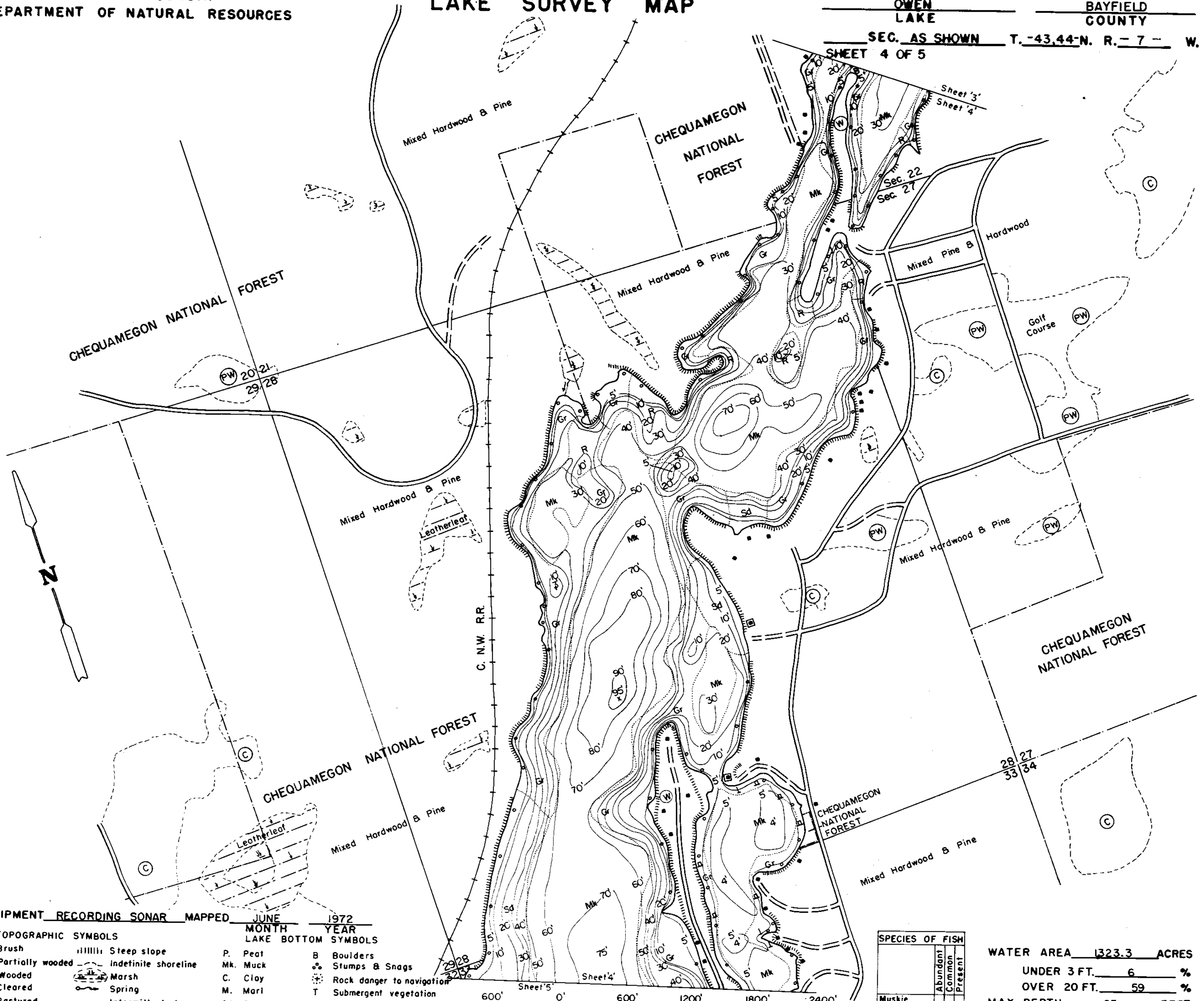

EQUIPMENT RECORDING SONAR MAPPED JUNE 1972

- | TOPOGRAPHIC SYMBOLS | | MONTH YEAR | |
|-----------------------|----------------------------|-------------|-----------------------------|
| (B) Brush | Steep slope | P. Peat | B Boulders |
| (PW) Partially wooded | - - - Indefinite shoreline | Mk. Muck | o Stumps & Snags |
| (W) Wooded | Marsh | C. Clay | ⊗ Rock danger to navigation |
| (C) Cleared | o Spring | M. Marl | T Submergent vegetation |
| (P) Pastured | - - - Intermittent stream | Sd. Sand | ⊥ Emergent vegetation |
| (A) Agricultural | ==== Permanent inlet | St. Silt | ⊏ Floating vegetation |
| B.M. Bench Mark | ==== Permanent outlet | Gr. Gravel | ⊕ Brush shelters |
| ■ Dwelling | ⊥ Dam | R. Rubble | |
| □ Resort | D.N.R. State owned land | Br. Bedrock | |
| ⊠ Camp | | | |

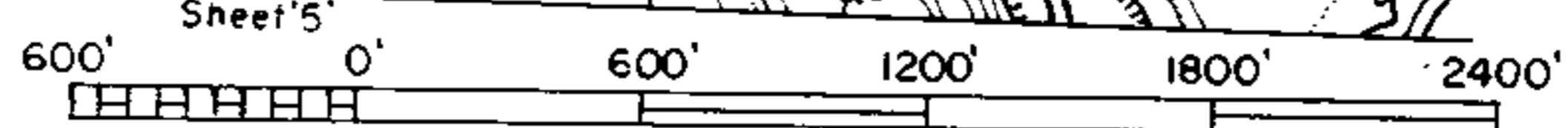

Access Access with Parking Boat Livery

Drawn by: C. Holt
Field work by: C. Busch, G. Lund, L. Sather

SPECIES OF FISH	Abundant Common Present		
	Abundant	Common	Present
Muskie			
N. Pike	X		
Walleye	X		
L. M. Bass		X	X
S. M. Bass	X		
Panfish	X		
Trout			

WATER AREA 1323.3 ACRES
 UNDER 3 FT. 6 %
 OVER 20 FT. 59 %
 MAX. DEPTH 95 FEET.
 TOTAL ALK. 64 P.P.M.
 VOLUME 36,250 ACRE FT.
 SHORELINE 24.00 MILES
 SHORELINE 2500 MILES WITH IS.

LAKE SURVEY MAP

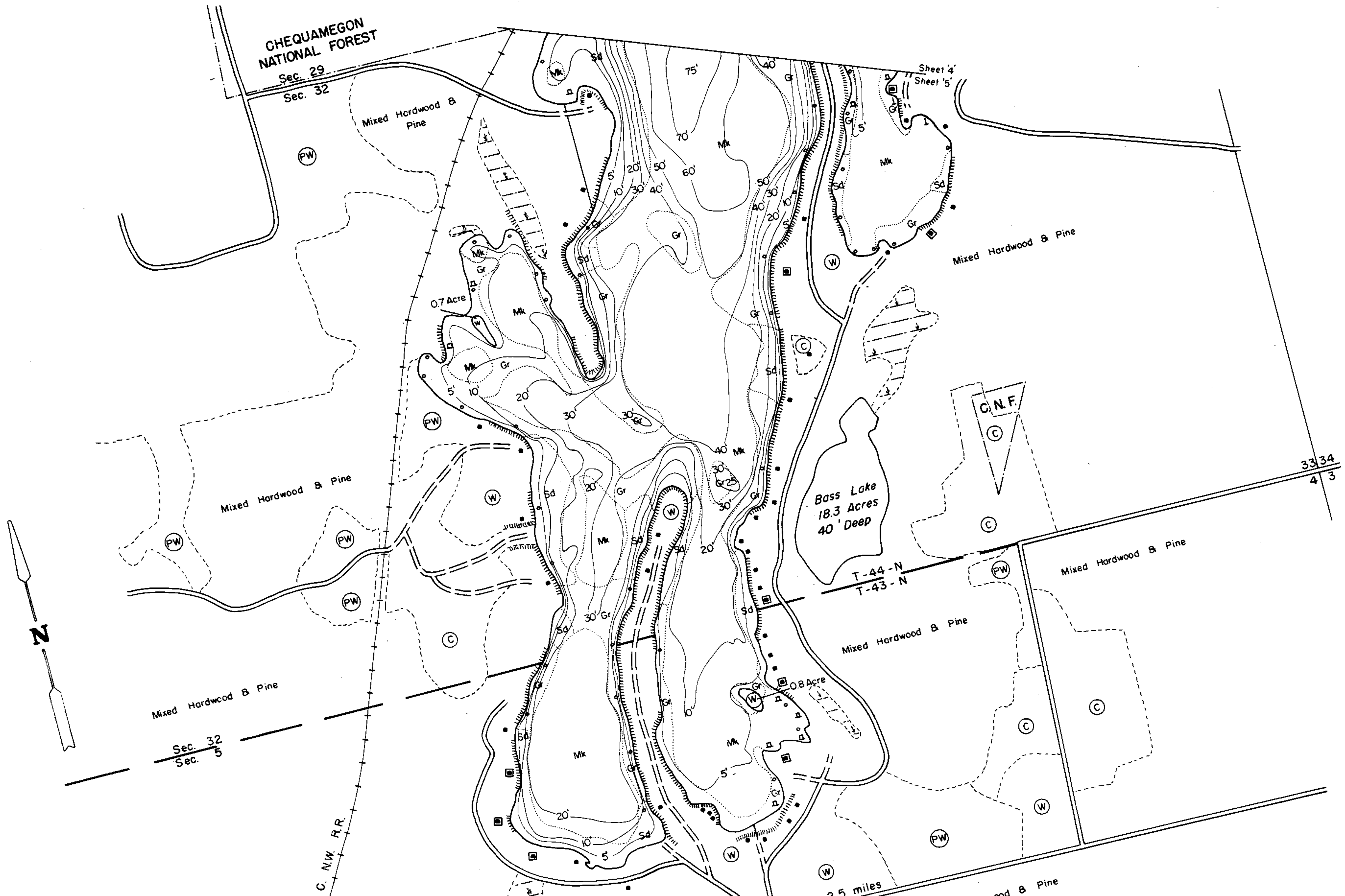

EQUIPMENT RECORDING SONAR MAPPED JUNE 1972

- TOPOGRAPHIC SYMBOLS**
- (B) Brush
 - (PW) Partially wooded
 - (W) Wooded
 - (C) Cleared
 - (P) Pastured
 - (A) Agricultural
 - B.M. Bench Mark
 - Dwelling
 - Resort
 - Camp
- LAKE BOTTOM SYMBOLS**
- P. Peat
 - Mk. Muck
 - C. Clay
 - M. Marl
 - Sd. Sand
 - St. Silt
 - Gr. Gravel
 - R. Rubble
 - Br. Bedrock

- TOPOGRAPHIC SYMBOLS**
- Steep slope
 - Indefinite shoreline
 - Marsh
 - Spring
 - Intermittent stream
 - Permanent inlet
 - Permanent outlet
 - Dam
 - D.N.R. State owned land
- LAKE BOTTOM SYMBOLS**
- B Boulders
 - Stumps & Snags
 - Rock danger to navigation
 - T Submergent vegetation
 - Emergent vegetation
 - Floating vegetation
 - Brush shelters



◆ Access ◆ Access with Parking ◆ Boat Livery
 Drawn by: C. Holt
 Field work by: C. Busch, G. Lund, L. Sather

SPECIES OF FISH	Abundance		
	Abundant	Common	Present
Muskie			
N. Pike		X	
Walleye		X	
L.M. Bass		X	
S.M. Bass		X	
Panfish	X		
Trout			

WATER AREA 1323.3 ACRES
 UNDER 3 FT. 6 %
 OVER 20 FT. 59 %
 MAX. DEPTH 95 FEET.
 TOTAL ALK. 64 P.P.M.
 VOLUME 36,250 ACRE FT.
 SHORELINE 24.00 MILES
 SHORELINE 25.00 MILES WITH IS.

Source: Wisconsin Department of Natural Resources 608-266-2621
Owen Lake – Bayfield County, Wisconsin DNR Lake Map
Date – Jun 1972 - Historical Lake Map - Not for Navigation
A Public Document - Please Identify the Source when using it.