

LAKE SURVEY MAP

LITTLE ST. GERMAIN
LAKE

VILAS
COUNTY

SEC. 19, 23 THRU 27 T. 40 N. R. 8, 9 E.
30, 34, 35 (Sheet 1 of 2 sheets)

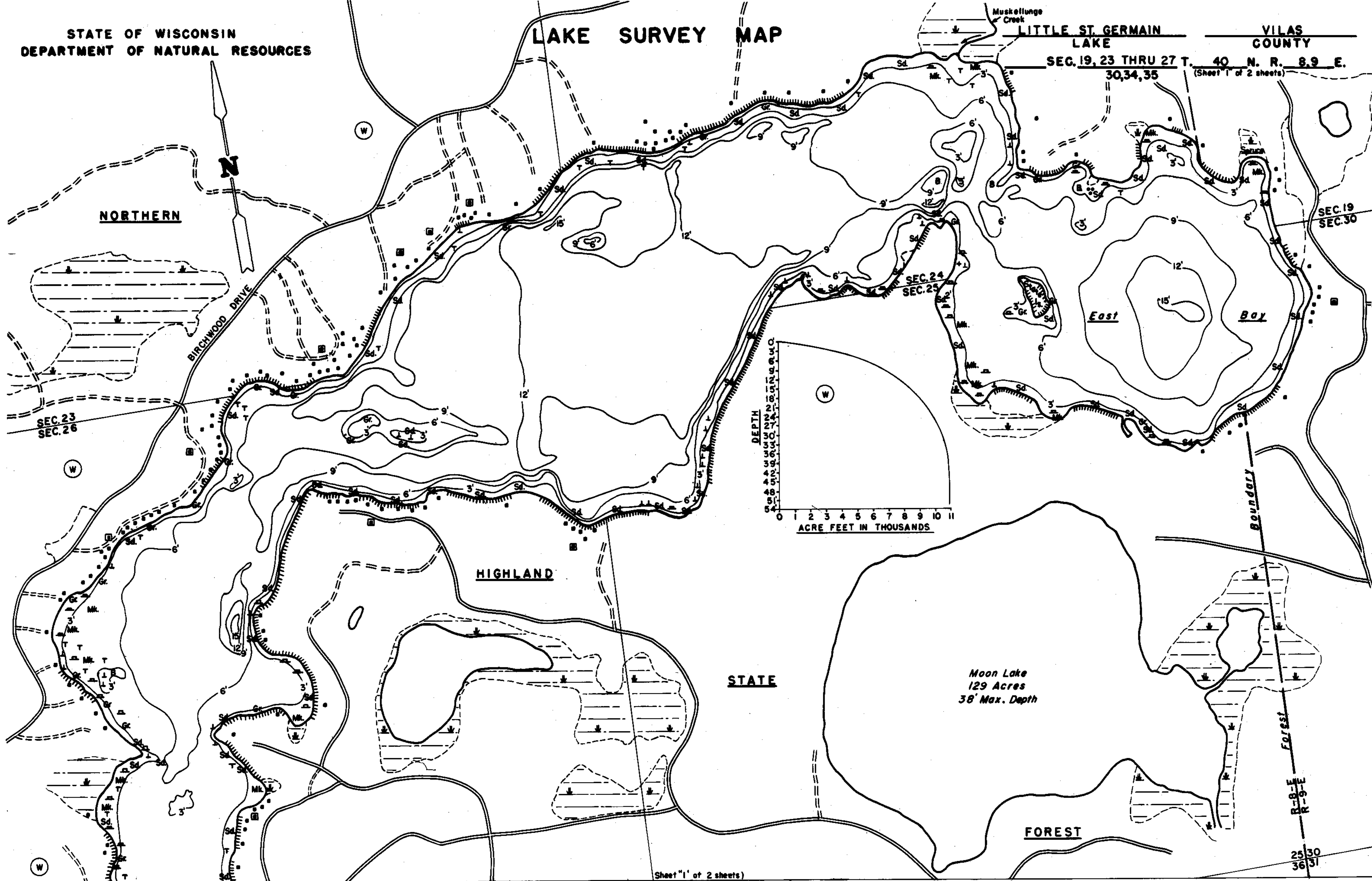

Sheet "1" of 2 sheets)
(Sheet "2" of 2 sheets)

EQUIPMENT RECORDING SONAR MAPPED AUGUST 1975
MONTH YEAR
LAKE BOTTOM SYMBOLS

TOPOGRAPHIC SYMBOLS		LAKE BOTTOM SYMBOLS	
(B) Brush	Steep slope	P. Peat	B Boulders
(PW) Partially wooded	~ Indefinite shoreline	Mk. Muck	⊙ Stumps & Snags
(W) Wooded	⊙ Marsh	C. Clay	⊙ Rock danger to navigation
(C) Cleared	⊙ Spring	M. Marl	T Submergent vegetation
(P) Pastured	~ Intermittent stream	Sd. Sand	⊥ Emergent vegetation
(A) Agricultural	~ Permanent inlet	St. Silt	⊥ Floating vegetation
B.M. Bench Mark	~ Permanent outlet	Gr. Gravel	⊥ Brush shelters
■ Dwelling	~ Dam	R. Rubble	
■ Resort	D.N.R. State owned land	Bc. Bedrock	
■ Camp			



Access Access with Parking Boat Livery
 Drawn by: G.Thuesen
 Field work by: J.Smith

SPECIES OF FISH	Abundant Common Present		
	Abundant	Common	Present
Muskie	X		
N. Pike	X		
Walleye	X		
L.M. Bass		X	
S.M. Bass		X	
Panfish	X		
Trout			
Cisco			X

WATER AREA 980 ACRES
 UNDER 3 FT. 11.4 %
 OVER 20 FT. 14.5 %
 MAX. DEPTH 53 FEET.
 TOTAL ALK. 3.7 P.P.M.
 VOLUME 10980.49 ACRE FT.
 MAIN SHORELINE 14.50 MI.
 ISLAND SHORELINE 0.2 MI.

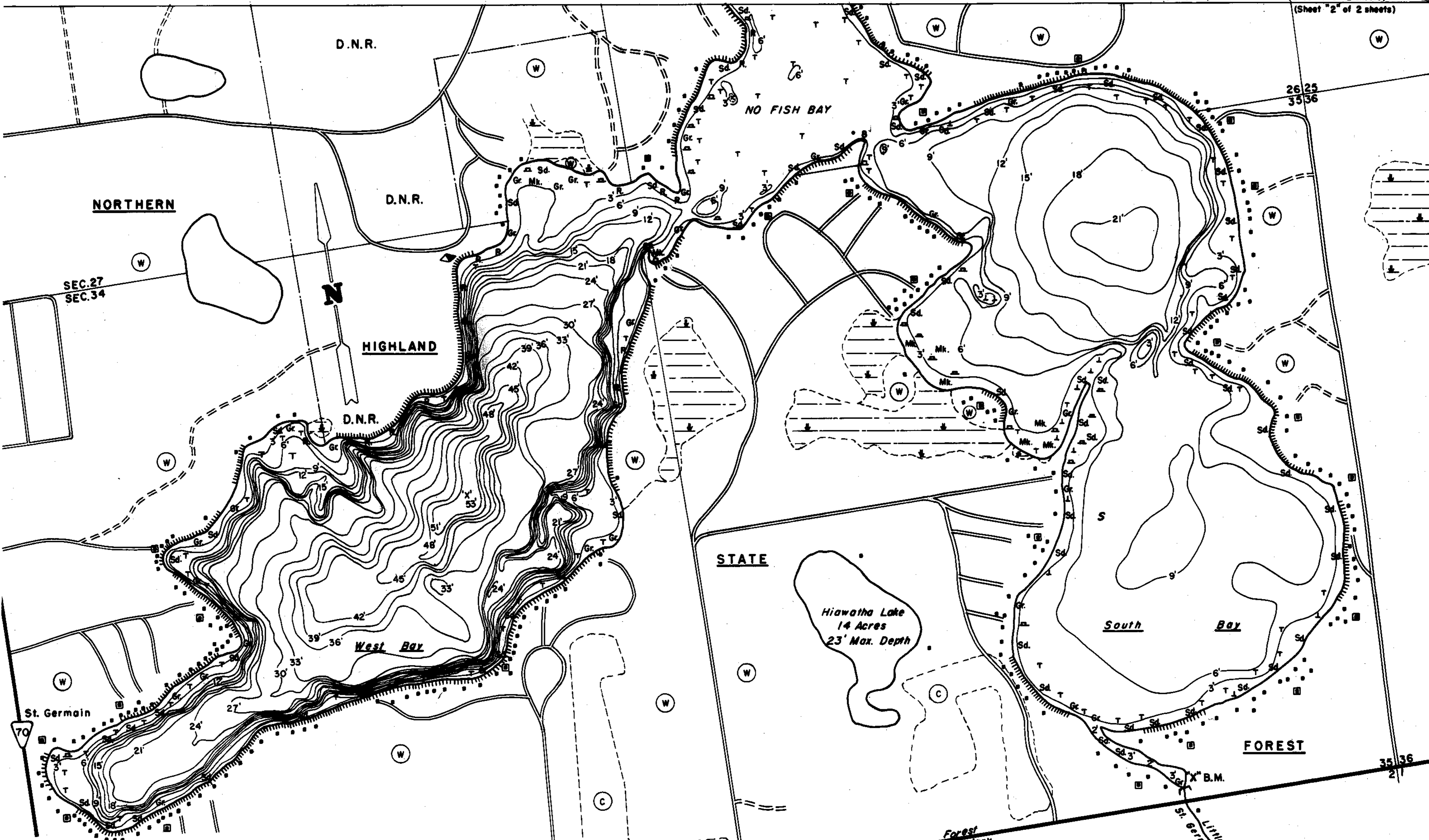

EQUIPMENT RECORDING SONAR MAPPED AUGUST 1975
MONTH YEAR
LAKE BOTTOM SYMBOLS

- | | | |
|----------------------------|----------------------------|-----------------------------|
| TOPOGRAPHIC SYMBOLS | LAKE BOTTOM SYMBOLS | LAKE BOTTOM SYMBOLS |
| (B) Brush | Steep slope | P. Peat |
| (PW) Partially wooded | - - - Indefinite shoreline | Mk. Muck |
| (W) Wooded | Marsh | C. Clay |
| (C) Cleared | Spring | M. Marl |
| (P) Pastured | Intermittent stream | Sd. Sand |
| (A) Agricultural | Permanent inlet | Sl. Silt |
| B.M. Bench Mark | Permanent outlet | Gr. Gravel |
| ■ Dwelling | Dam | R. Rubble |
| ■ Resort | D.N.R. State owned land | Bc. Bedrock |
| ■ Camp | | B Boulders |
| | | ⊙ Stumps & Snags |
| | | ⊙ Rock danger to navigation |
| | | T Submergent vegetation |
| | | ⊥ Emergent vegetation |
| | | ⊥ Floating vegetation |
| | | ⊥ Brush shelters |



Access Access with Parking Boat Livery
 Drawn by: G. Thuesen
 Field work by: J. Smith

SPECIES OF FISH	Abundance	
	Abundant	Common Present
Muskie	X	
N. Pike	X	
Walleye	X	
L.M. Bass	X	X
S.M. Bass	X	X
Panfish	X	
Trout		
Cisco		X

WATER AREA 980 ACRES
 UNDER 3 FT. 11.4 %
 OVER 20 FT. 14.5 %
 MAX. DEPTH 53 FEET.
 TOTAL ALK. 37 P.P.M.
 VOLUME 10980.49 ACRE FT.
 MAIN SHORELINE 14.50 MI.
 ISLAND SHORELINE 0.2 MI.

Source: Wisconsin Department of Natural Resources 608-266-2621
Little St. Germain Lake - Vilas County, Wisconsin DNR Lake Map
Date – Aug 1975 - Historical Lake Map - Not for Navigation
A Public Document - Please Identify the Source when using it.