

LAKE SURVEY MAP

WISCONSIN CONSERVATION DEPARTMENT
BIOLOGY DIVISION
LAKE AND STREAM IMPROVEMENT SECTION

LAKE ATKINS
SECTION 2536, 30-31
TOWNSHIP 37 N
RANGE 11-12 E
TOWN OF PIEHL - CRANDOLL
COUNTY ONEIDA - FOREST

FORM FI-117

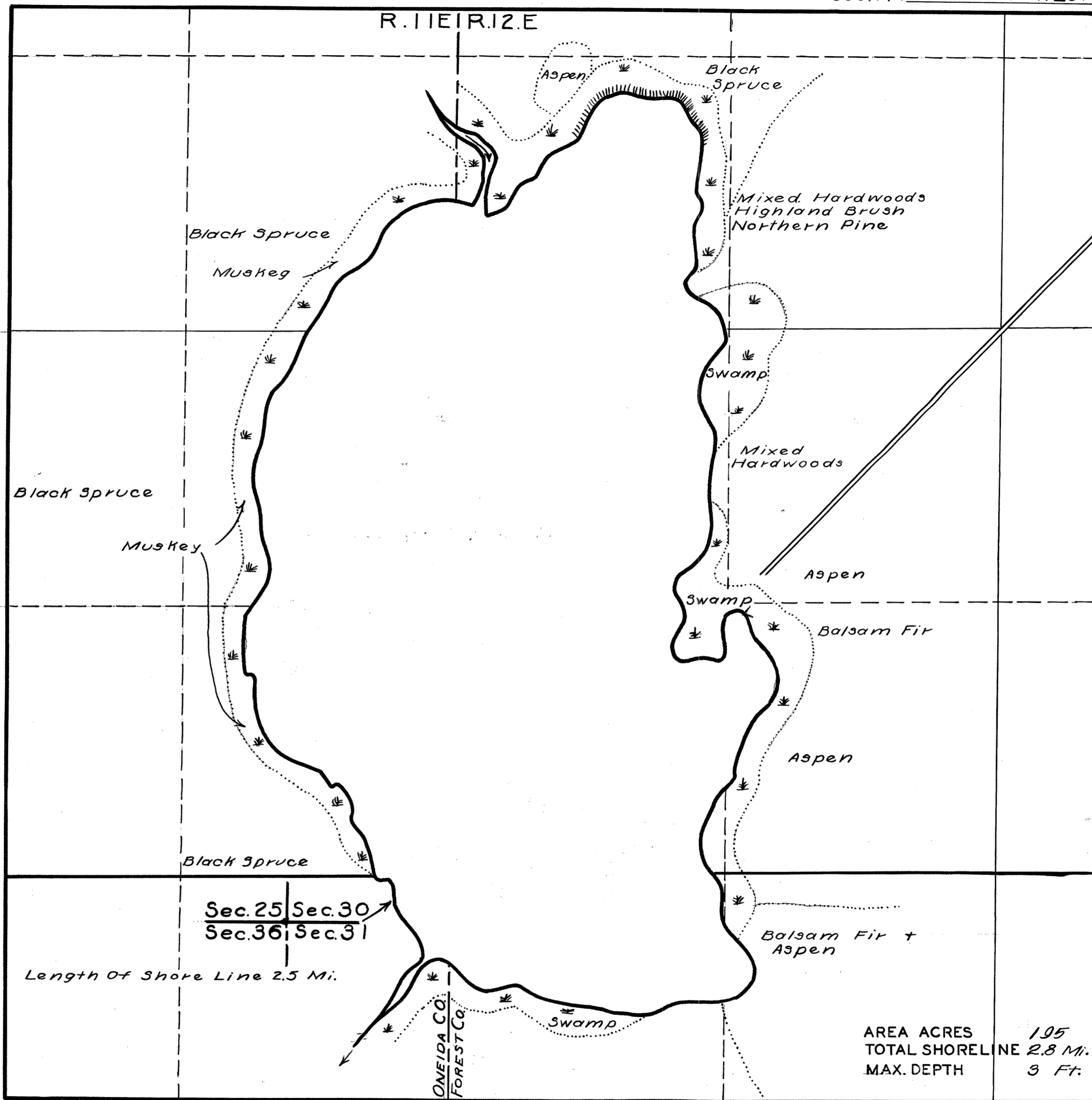

DATE July 12, 1939
COMPILED BY _____
TRACED BY W.R.S.
SOURCE OF INFORMATION
U.S. Forest Service Map
Lake & Stream Survey
SOUNDINGS _____
U.S. Forest Service
DATES OF MAP REVISION _____
WORK AGENCY _____

LAKE IMPROVEMENT RECORD

TYPE	DATE			
⊕ BRUSH REFUGES	_____	_____	_____	_____
~ SAPLING TANGLES	_____	_____	_____	_____
□ SPAWNING BOXES	_____	_____	_____	_____
* MINNOW SPAWNERS	_____	_____	_____	_____
TOTAL	_____	_____	_____	_____

SCALE 1 inch Equals 457 Ft.

- LEGEND
- ⊕ WEED BEDS
 - ⊙ ROCKY SHOALS
 - Sd SAND
 - Cl CLAY
 - Gh GRAVEL
 - Mk MUCK
 - DWELLING
 - ABANDONED DWELLING
 - ▣ RESORT
 - ⌄ Pronounced Hill

Source: Wisconsin Department of Natural Resources 608-266-2621
Atkins Lake – Oneida County, Wisconsin DNR Lake Map
Date – Jul 1939 - Historical Lake Map - Not for Navigation
A Public Document - Please Identify the Source when using it.