

LAKE SURVEY MAP

BEAR
LAKE

ONEIDA
COUNTY

SEC. 19, 24, 25, 30 T. 38 N. R. 5, 6 E.

Hazelhurst 5 Miles

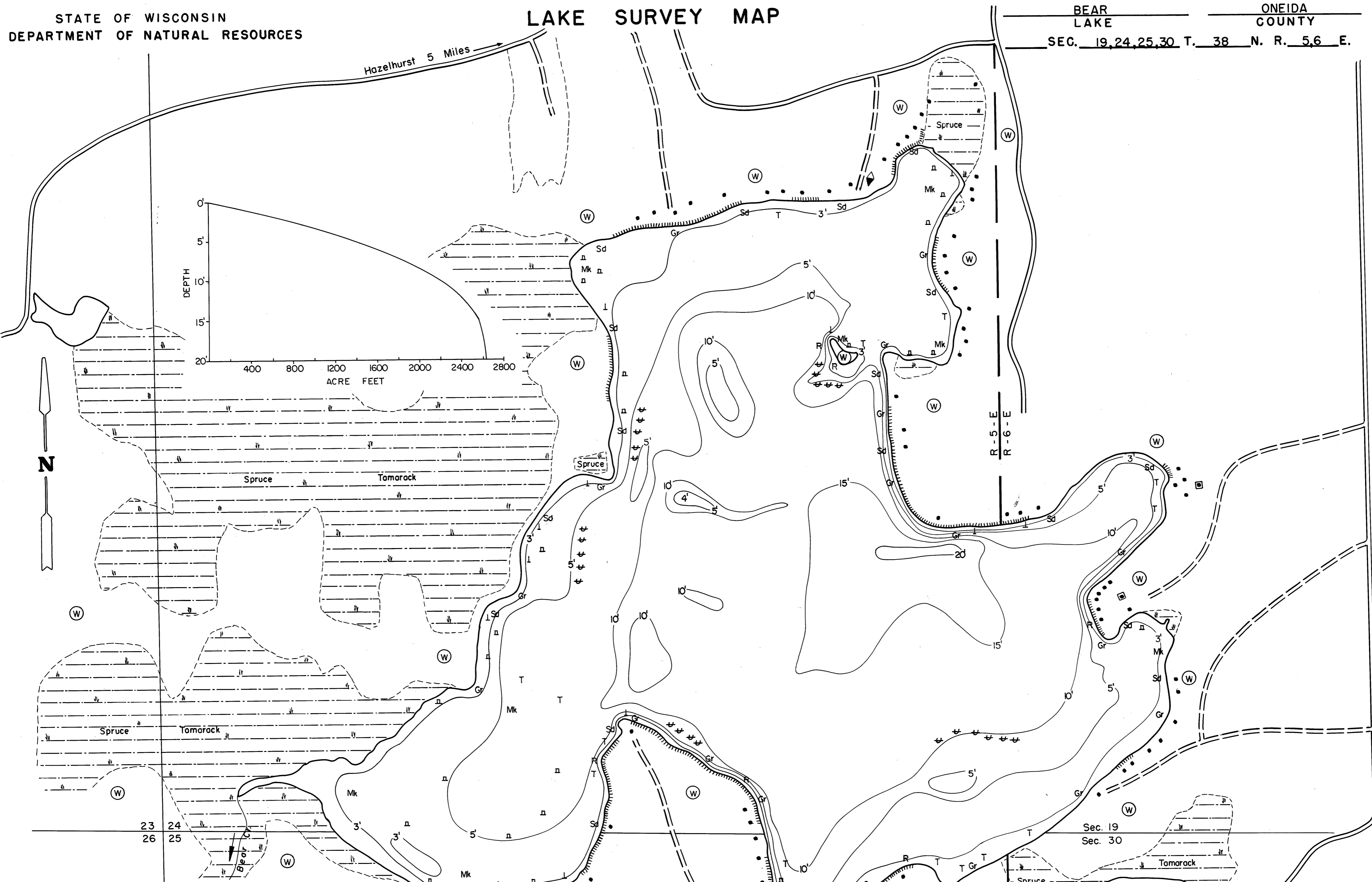

EQUIPMENT RECORDING SONAR MAPPED AUG 1973

- | TOPOGRAPHIC SYMBOLS | | LAKE BOTTOM SYMBOLS | |
|-----------------------|----------------------------|---------------------|-----------------------------|
| (B) Brush | Steep slope | P. Peat | B Boulders |
| (PW) Partially wooded | - - - Indefinite shoreline | Mk. Muck | o Stumps & Snags |
| (W) Wooded | Marsh | C. Clay | ⊗ Rock danger to navigation |
| (C) Cleared | o Spring | M. Marl | T Submergent vegetation |
| (P) Pastured | ~ Intermittent stream | Sd. Sand | ⊥ Emergent vegetation |
| (A) Agricultural | == Permanent inlet | St. Silt | ⊏ Floating vegetation |
| B.M. Bench Mark | == Permanent outlet | Gr. Gravel | ⊕ Brush shelters |
| ■ Dwelling | ⊥ Dam | R. Rubble | |
| ■ Resort | D.N.R. State owned land | Br. Bedrock | |
| □ Camp | | | |

SPECIES OF FISH	Abundance		
	Abundant	Common	Present
Muskie			
N. Pike			X
Walleye		X	
L.M. Bass			X
S.M. Bass			X
Panfish	X		
Trout			

WATER AREA 311.9 ACRES
 UNDER 3 FT. 9 %
 OVER 20 FT. 0 %
 MAX. DEPTH 20 FEET.
 TOTAL ALK. 31 P.P.M.
 VOLUME 2624 ACRE FT.
 MAIN SHORELINE 4.22 MI.
 ISLAND SHORELINE .11 MI.

SCALE
 Access Access with Parking Boat Livery

Drawn by: C. Holt
 Field work by: J. Smith

Source: Wisconsin Department of Natural Resources 608-266-2621
Bear Lake T38N R7E S35– Oneida County, Wisconsin DNR Lake Map
Date – Aug 1973 - Historical Lake Map - Not for Navigation
A Public Document - Please Identify the Source when using it.