

Department of Natural Resources Bench Mark 1631-A.  
Head of 3/8" lag screw in east side of base of twin birch  
25' northwest of culvert under shore road.  
Assumed Elevation 100.00'  
Water Elevation 98.85'

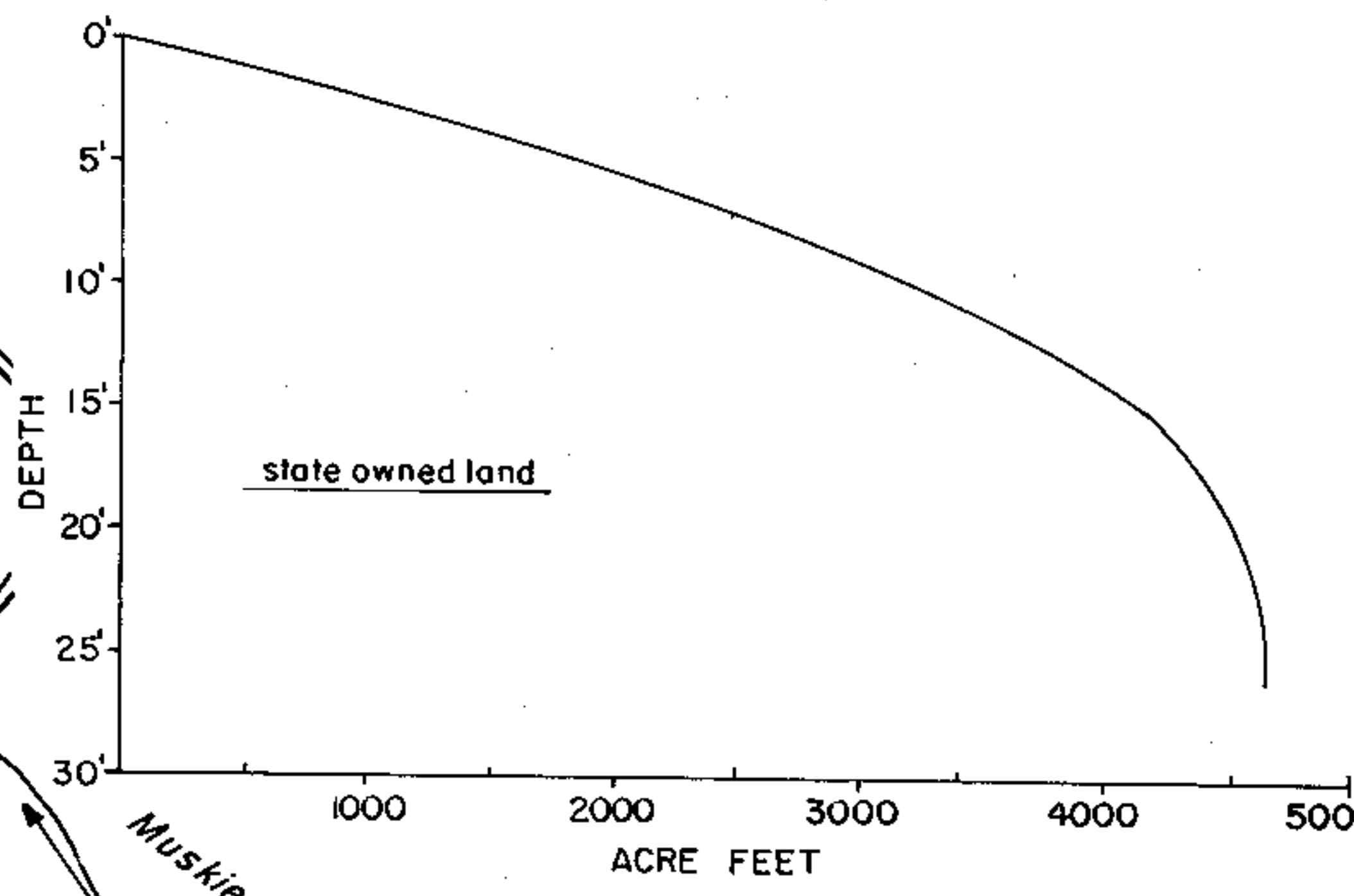
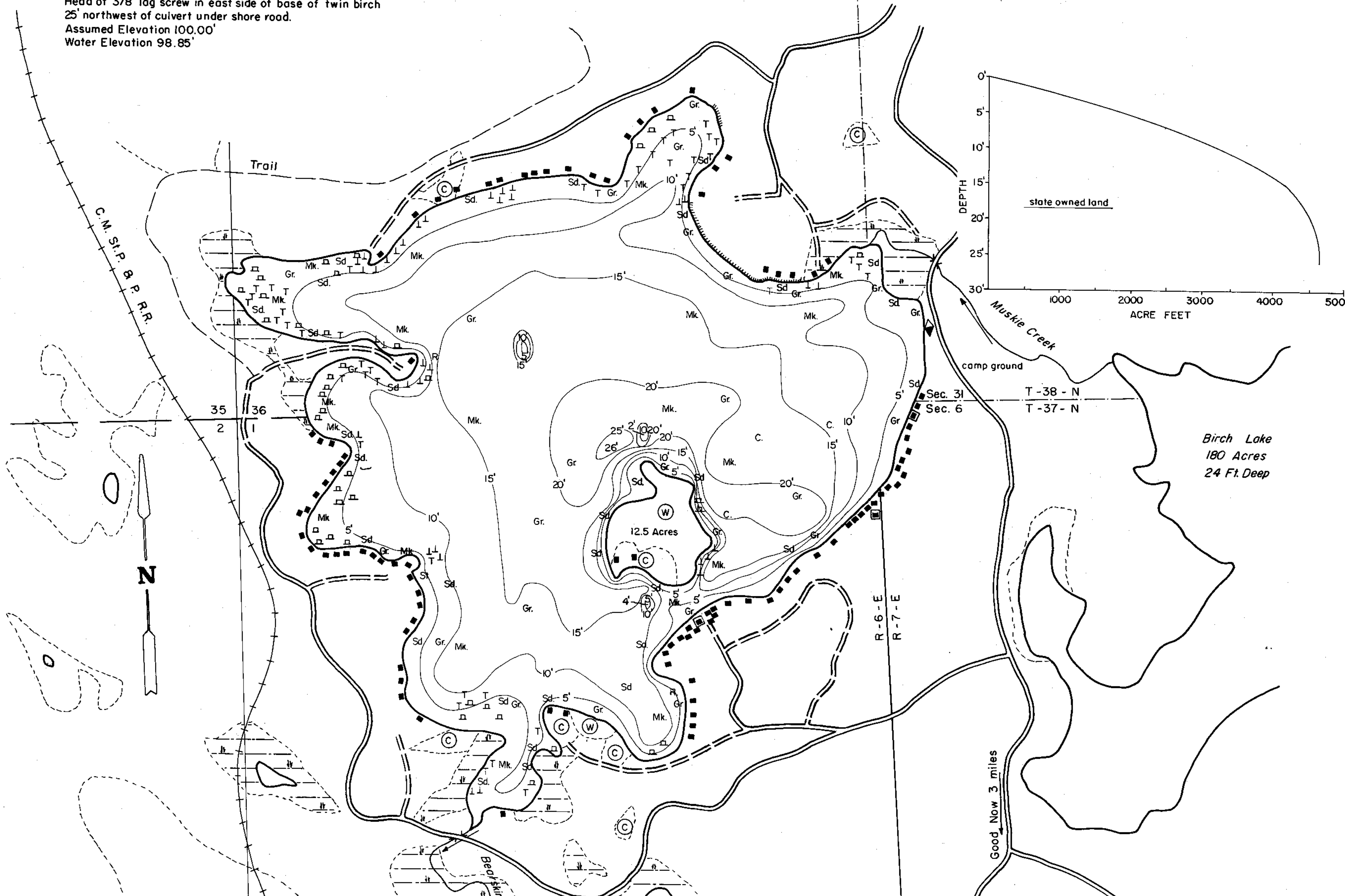

Birch Lake  
180 Acres  
24 Ft. Deep

EQUIPMENT MAPPED JUNE 1968  
HAND LINE MAPPED JULY 1938

TOPOGRAPHIC SYMBOLS		LAKE BOTTOM SYMBOLS	
(B) Brush	Steep slope	P. Peat	B Boulders
(PW) Partially wooded	~ Indefinite shoreline	Mk. Muck	o Stumps & Snags
(W) Wooded	~ Marsh	C. Clay	⊗ Rock danger to navigation
(C) Cleared	~ Spring	M. Marl	T Submergent vegetation
(P) Pastured	~ Intermittent stream	Sd. Sand	⊥ Emergent vegetation
(A) Agricultural	~ Permanent inlet	St. Silt	⊥ Floating vegetation
B.M. Bench Mark	~ Permanent outlet	Gr. Gravel	⊥ Brush shelters
■ Dwelling	~ Dam	R. Rubble	
□ Resort	~ D.N.R. State owned land	Br. Bedrock	
□ Camp			



◆ Access    ◆ Access with Parking    ◆ Boat Livery  
Drawn by: C. Holt  
Field work by: R. Theis

SPECIES OF FISH			
	Abundant	Common	Present
Muskie	X		
N. Pike		X	
Walleye		X	
L.M. Bass		X	
S.M. Bass		X	X
Panfish	X		
Trout			

WATER AREA 400.3 ACRES  
UNDER 3 FT. 11.7 %  
OVER 20 FT. 7.5 %  
MAX. DEPTH 26 FEET.  
TOTAL ALK. 48 P.P.M.  
VOLUME 4636.8 ACRE FT.  
SHORELINE 5.59 MILES  
SHORELINE 4.9 MILES WITHOUT IS.

Source: Wisconsin Department of Natural Resources 608-266-2621  
Bearskin Lake – Oneida County, Wisconsin DNR Lake Map  
Date – Jun 1968 - Historical Lake Map - Not for Navigation  
A Public Document - Please Identify the Source when using it.