

SCATTERED STATE LANDS TRACT NO. 947-09

Compartment 3 Stand #4

Woodboro Lakes 51

FSC Cert #SCS-FM/COC-00070N

Oneida County

Town 36 North, Range 6 East

Section 13 – Pt of SWNW

10% of the total sale bid value will be required as bid bond.

15% of the total sale bid value will be required for performance bond.

The cutting area is approximately 11 acres.

The contract period is 2 years.

All trees that will yield one or more 100-inch sticks to the minimum top diameter chosen by the bidder will be cut and utilized.

ESTIMATED VOLUME (CORDS)

MINIMUM TOP DIAMETER

<u>SPECIES</u>	<u>4"</u>	<u>Whole Tree</u>	<u>Advertised Price Per Unit</u>
Aspen	260	330	\$ 18.70
Mixed Hardwood	80	100	\$ 18.70
Total Minimum Bid Value			\$ 6,358.00

Special Conditions:

1. Cutting must be concurrent for all species to be harvested.⁽⁹⁾
2. Slash must be lopped and scattered to lie within two feet of the ground. No tops or slash allowed across any blue line, or in any swamp.⁽¹⁶⁾
3. All landings and any new roads must be approved by the timber sale administrator. All roads must be repaired to original or better than original condition.⁽¹⁸⁾
4. All cutting to be done when the ground is frozen or dry. Leave all the standing dead trees that are not a safety hazard.⁽³⁵⁾







WISCONSIN
DEPARTMENT OF NATURAL RESOURCES
WOODBORO LAKES 51 SALE
TRACT #947-09
T36N - R6E SECTION 13
HARVEST AREA 11 ACRES



Map Created By:
John Gillen 3/24/09

Scale 1" = ¼ mile

Legend

	-----Harvest Area
	-----Blue Paint Line
	-----Red Paint Line
	-----HWY ROW Fence
	-----Keg
	-----Survey Pipe

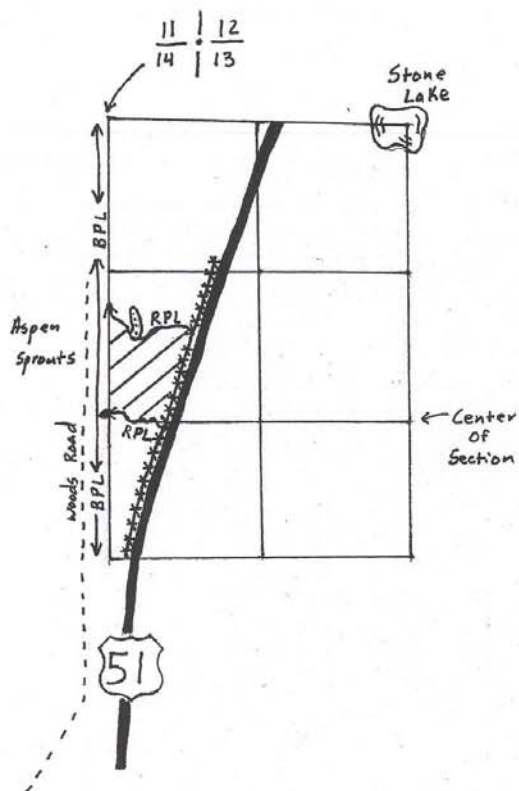

Harvest Area (11 acres):

1. Cut all trees greater than 2 inches in diameter at DBH.
2. **Do not cut** any oak, red pine, or white pine.
3. Take care not to damage oak, ash, and pine regeneration.