

NH-ALSF TRACT NO. 9-09  
NW Plum Lake

Vilas County

Town 41 North, Range 7 East  
Section 25 – SENE; NESW; SE1/4

Town 41 North, Range 8 East  
Section 30 – SWNW; W1/2SW1/4

10% of the total sale bid value will be required as bid bond.  
15% of the total sale bid value will be required for performance bond.  
The cutting area is approximately 76 acres.  
The contract period is 2 years.  
All trees that will yield one or more 100-inch sticks to the minimum top diameter chosen by the bidder will be cut and utilized.

---

ESTIMATED VOLUME (CORDS)  
MINIMUM TOP DIAMETER

<u>SPECIES</u>	<u>4"</u>	<u>Whole Tree</u>	<u>Advertised Price Per Unit</u>
Aspen	115	145	\$ 17.00
Mixed Hardwood <sup>1</sup>	280	350	\$ 15.30
Other Oak <sup>2</sup>	260	320	\$ 11.50
White Pine <sup>3</sup>	255	320	\$ 11.50

ESTIMATED VOLUME (MBF)

Other Oak	52	\$ 128.00
Red Pine	52	\$ 111.00
White Pine	18	\$ 122.00

**Total Minimum Bid Value \$ 26,785.50**

---

<sup>1</sup>Volume includes 51% white birch, 46% red maple, and 3% sugar maple.

<sup>2</sup>Volume includes < 5% dead oak.

<sup>3</sup>Volume includes 46% scotch pine, 29% red pine, 15% white pine, 9% jack pine, and 1% Norway and black spruce.

Special Conditions:

1. **LUMP SUM SALE.** One- half of the total lump sum bid value must be paid prior to starting. The remaining amount must be paid when half of the sale has been completed. All trees are to be pre-approved prior to cutting if not marked or designated to be cut. Any residual trees cut, pushed over or damaged are to be decked, scaled, and billed for in addition to lump sum bid value. Any trees cut without approval will subject the contractor to penalties and fines.<sup>(8)</sup>
2. Cutting must be concurrent for all species to be harvested. Pole skidding WILL NOT be permitted on this sale. Special care must be taken to minimize damage to white pine seedlings.<sup>(9)</sup>
3. Slash within 50 feet of all roads must be lopped and/or scattered to lie within two feet of the ground and pulled back at least ten feet behind the tree line concurrent with cutting. No tops or slash allowed across any red line, blue line, grass opening, or in any wetland.<sup>(16)</sup>
4. All landings and any new woods roads must be approved prior to sale start up. Skidding and decking will be permitted along certain woods roads with prior approval. The private service road must be free of debris and passable at all times. This road must be restored to **pre-harvest condition** upon sale completion.<sup>(18)</sup>
5. All conifer products cut between June 1 and September 1 must be removed from the sale area within three weeks from time of cutting. Conifer products cut during the remainder of the year must be removed prior to June 1 of each year.<sup>(35)</sup>

WISCONSIN  
 DEPARTMENT OF NATURAL RESOURCES  
 TIMBER SALE  
 TRACT 9-09 NW PLUM LAKE  
 T41N R7E SECTION 25  
 T41N R8E SECTION 30  
 HARVEST ACRES - 76

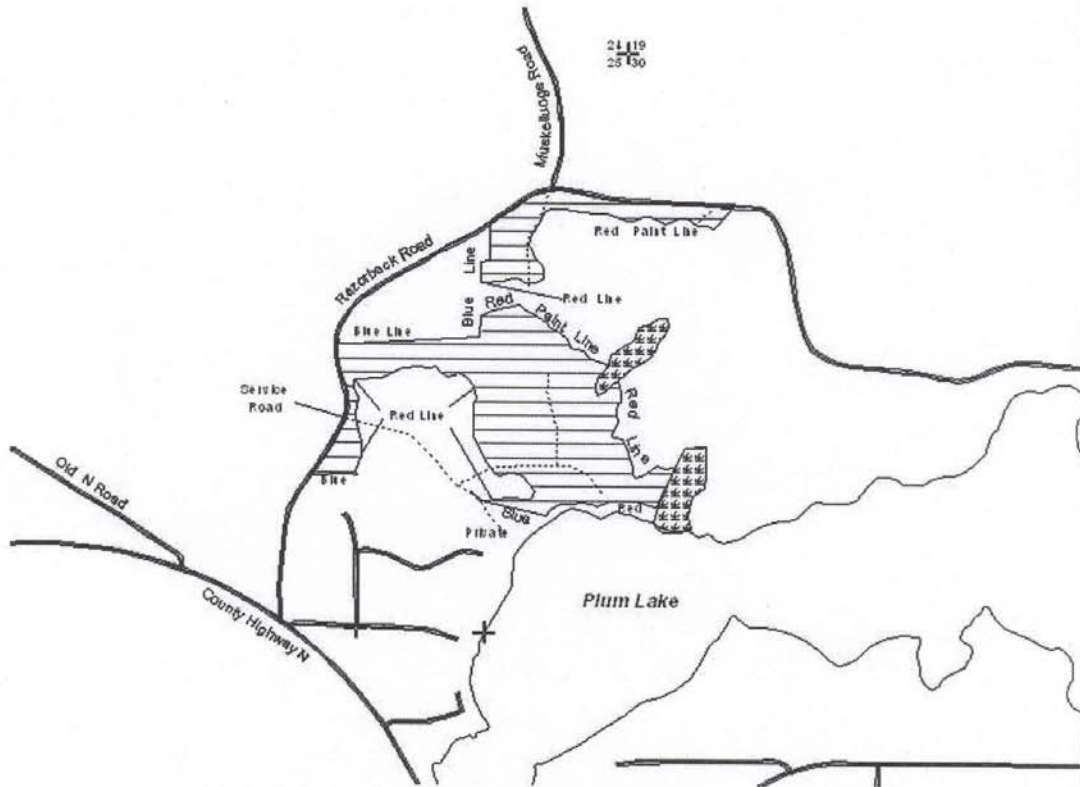

**Legend**

- + Section Corners
- ⋯ Woods Trails
- Highways and Town Roads
- ▨ Main Sale Area
- ⊞ Lowland Swamp Area
- Lakes

 Main Sale Area (76 Acres): Cut all trees within the sale area except those marked with green paint. Cut only those red and white pine marked with orange paint. Cut all 1 to 5 inch aspen.

*Note: Do NOT cut trees marked with green paint.*

N  
 Scale: 4" = 1 Mile  
 1:15,840  
  
 Wisconsin Department of Natural Resources  
 600 Wisconsin Ave., Stevens Point, WI 54481