

NH-ALSF TRACT NO. 33-07
Hall Road

Vilas County

Town 40 North, Range 6 East

Section 15 – NWSW, SWSW

10% of the total sale bid value will be required as bid bond.

25% of the total sale bid value will be required for performance bond.

The cutting area is approximately 26 acres.

The contract period is 4 months.

All trees that will yield one or more 100-inch sticks to the minimum top diameter will be cut and utilized.

ESTIMATED VOLUME (CORDS)

MINIMUM TOP DIAMETER

<u>SPECIES</u>	<u>4"</u>	<u>Whole Tree</u>	<u>Advertised Price Per Unit</u>
White Pine ¹	300	--	\$ 12.00

ESTIMATED VOLUME (MBF)

White Pine ²	160		\$ 130.00
-------------------------	-----	--	-----------

¹ Approximately 200 cords of white pine and 100 cords of all other species.

² Approximately 110 MBF of white pine, 35 MBF of red pine and 15 MBF of white spruce.

Special Conditions:

1. All sale activity must be completed by 1 May 2008.⁽³⁵⁾
2. Due to the short contract the performance bond will be 25% of the total bid.⁽³⁵⁾

**WISCONSIN
DEPARTMENT OF NATURAL RESOURCES
TIMBER SALE
TRACT 33-07 HALL ROAD
T40N R6E SECTION 15
HARVEST ACRES - 26**

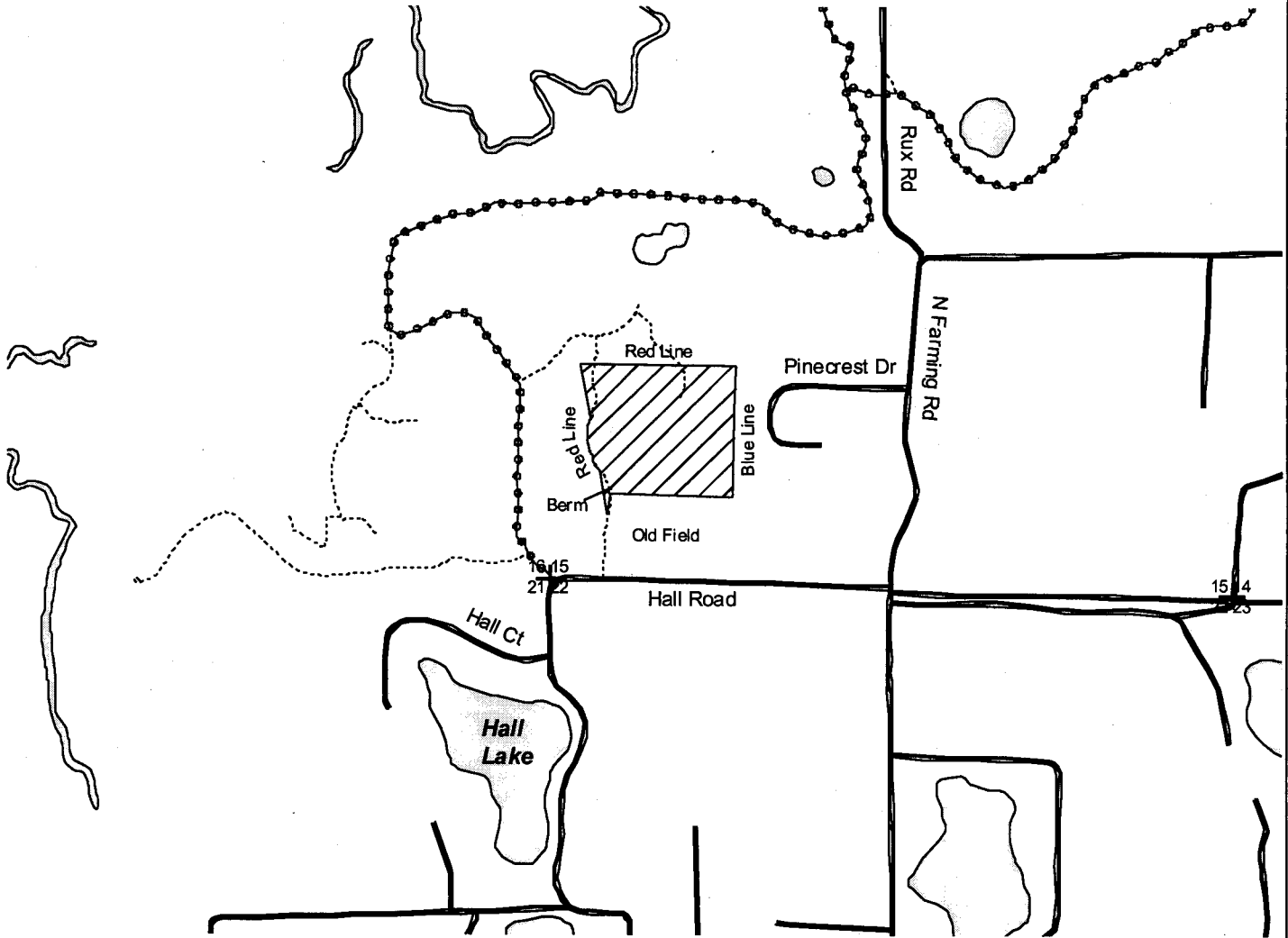

Legend

- Section Corner
- Woods Roads
- Highways and Town Roads
- Snowmobile Trails
- Lakes
- Sale Area

Sale Area (26 Acres): Cut all trees with one or more sticks to a 4 inch top.

Note: All harvested activity must be completed by May 1st, 2008.

N
Scale: 4" = 1 Mile
1:15,840

