

NH-ALSF TRACT NO. 28-07
Who Cooks For You

Vilas County

Town 41 North, Range 8 East
Sections 2 & 11

10% of the total sale bid value will be required as bid bond.

15% of the total sale bid value will be required for performance bond.

The cutting area is approximately 295 acres.

The contract period is for 3 winter periods ending July 31st of the 3rd year.

All trees that will yield one or more 100-inch sticks to the minimum top diameter chosen by the bidder will be cut and utilized.

ESTIMATED VOLUME (CORDS)

MINIMUM TOP DIAMETER

<u>SPECIES</u>	<u>4"</u>	<u>Whole Tree</u>	<u>Advertised Price Per Unit</u>
Mixed Hardwood ¹	2200	--	\$ 16.20
Aspen	370	--	\$ 20.20
White Birch	240	--	\$ 16.20
Balsam Fir	400	--	\$ 6.90

ESTIMATED VOLUME (MBF)

Red Oak	150	\$ 183.00
Sugar Maple	140	\$ 150.00
Mixed Hardwood ²	50	\$ 125.00
White Birch	40	\$ 117.00

¹Includes approximately 39% sugar maple, 35% red maple, 23% red oak, 3% basswood, and 1% ironwood

²Includes approximately 90% red maple and 10% basswood

Special Conditions:

1. No cutting will be permitted between April 1 and July 31 in the Northern Hardwood area.⁽¹³⁾
2. Each block must be cut separately and completed before beginning on the next block.⁽¹³⁾
3. Cutting must be concurrent for all species to be harvested.⁽⁹⁾
4. Any landings or new roads must be approved by the forester prior to construction.⁽¹⁸⁾
5. Slash along town road must be lopped and/or scattered to lie within two feet of the ground and pulled back at least ten feet behind the tree line concurrently with cutting.⁽¹⁶⁾
6. Pole skidding WILL NOT be allowed within the marked area.⁽⁹⁾
7. Snowmobile trails must be kept free of debris and left in good condition for vehicle traffic at all times.⁽¹⁸⁾
8. Snowmobile trails must be repaired to pre-harvest condition.⁽¹⁸⁾
9. Whole tree harvesting WILL NOT be permitted on this sale.⁽⁹⁾
10. Trees may not be felled across blue line or into wetland/swamp areas.⁽¹⁶⁾

**WISCONSIN
DEPARTMENT OF NATURAL RESOURCES
TIMBER SALE
TRACT 28-07 WHO COOKS FOR YOU
T41N R8E SECTIONS 2 & 11
HARVEST ACRES - 295**

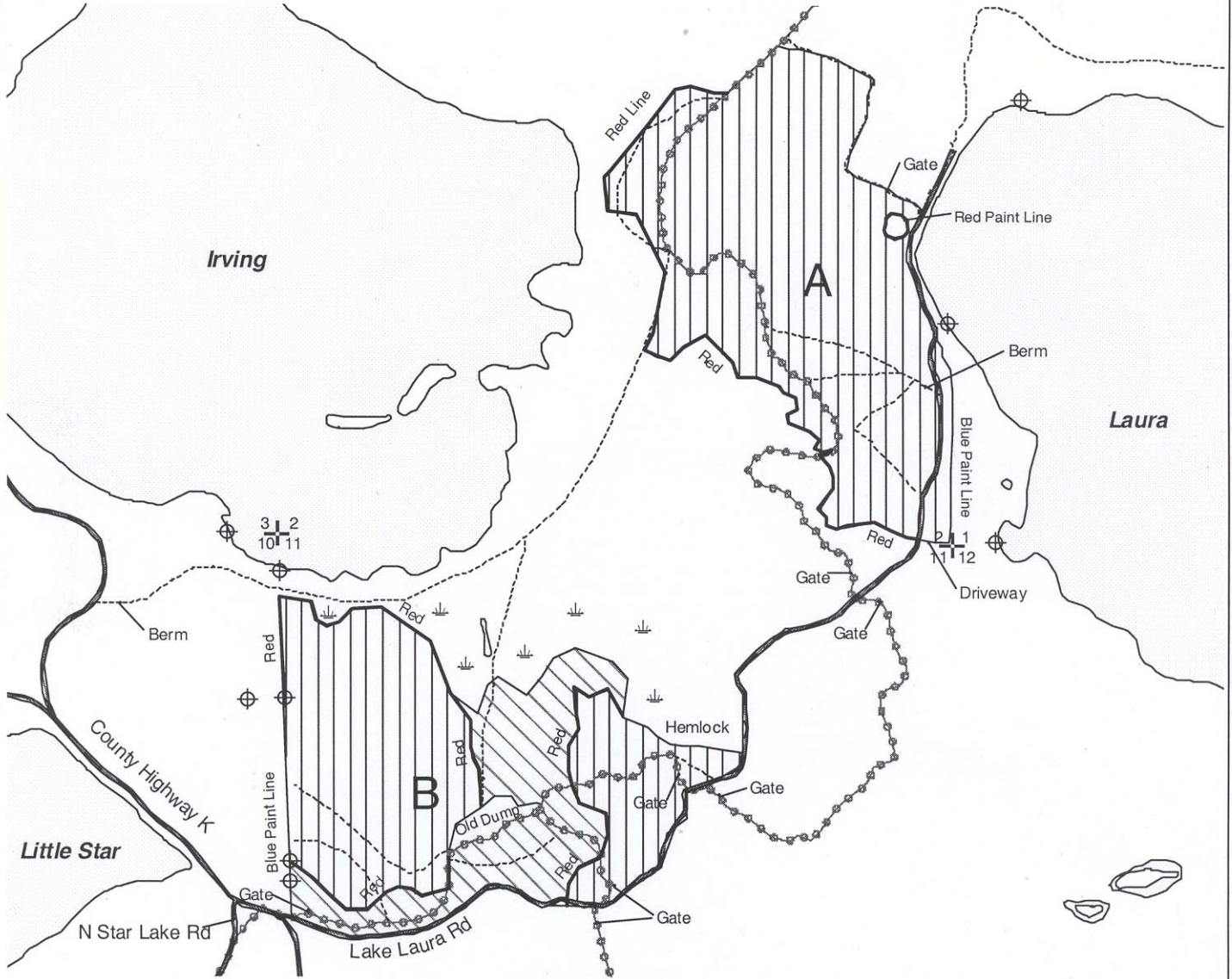

 Northern Hardwood Area (247 Acres): Cut all aspen, white birch and balsam fir with one merchantable stick. Cut all trees marked with orange paint. Do NOT cut trees marked with green paint.

 Oak/Birch Area (48 Acres): Cut all aspen, white birch and balsam fir with at least one merchantable stick. Cut all red and sugar maple less than 15 inches DBH. Cut all trees marked with orange paint. Do NOT cut trees marked with green paint.

Legend

-  Section Corner
-  Iron Pipe
-  Lowland Swamp
-  Woods Roads
-  Highways and Town Roads
-  Snowmobile Trails
-  Lakes
-  Northern Hardwood Area
-  Oak/Birch Area

N
Scale: 4" = 1 Mile
1:15,840

Map produced by
Kelly Onal and
Paul Schultz, 9/07

Note: All harvest activity must be completed in either Zone A or Zone B, in its entirety, before work can begin in another Zone.