

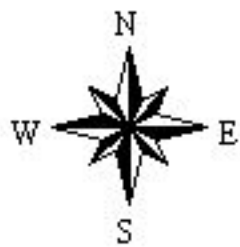

# Brule River State Forest

Sign Pine - Tract 07-07 - 49 acres

T47N R10W Sec. 35

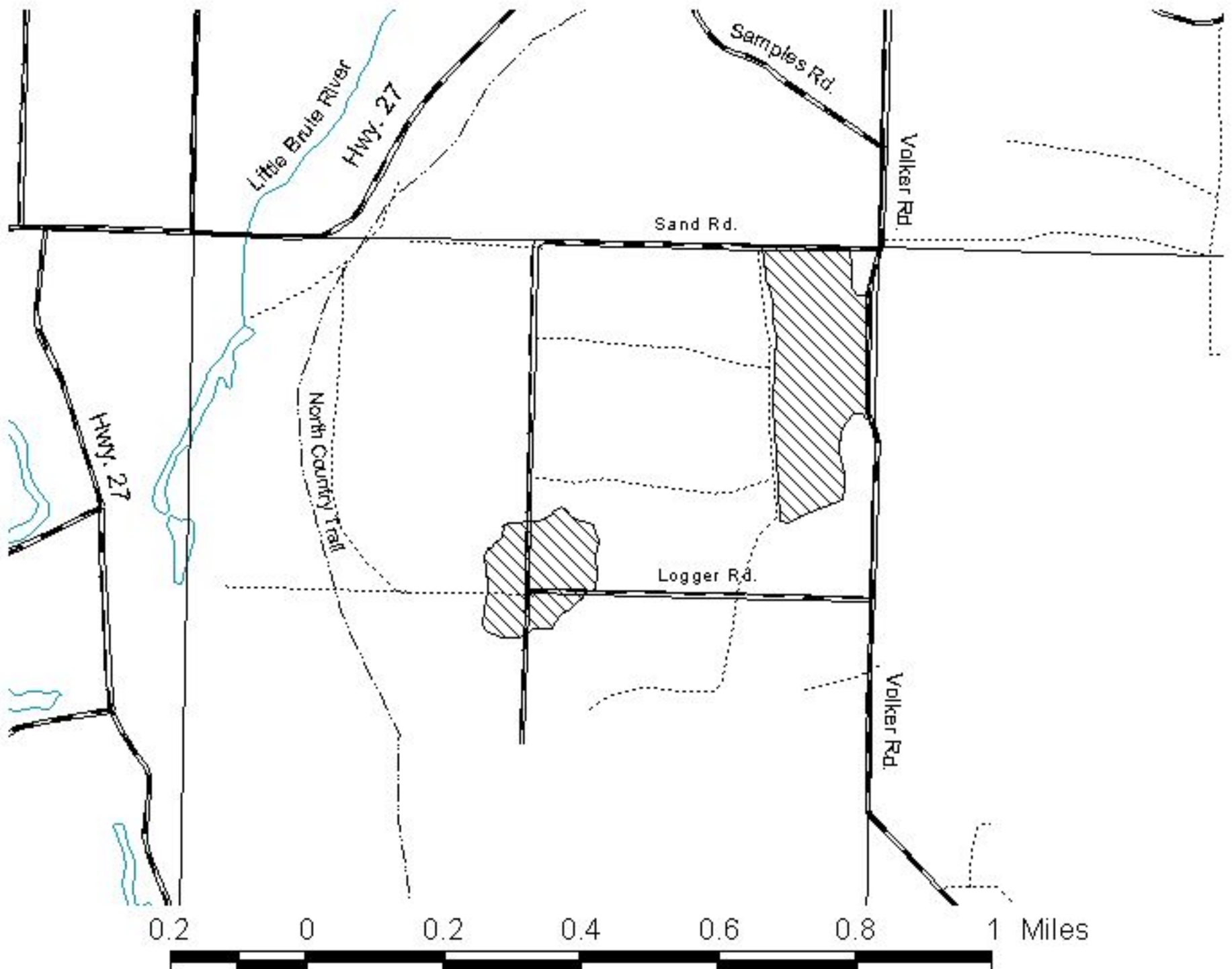
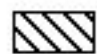

 **Sale Boundaries**  
 **Woods Roads**  
 **Roads**  
 **Section Lines**

Estimated Volumes

Red Pine: 670 cords

Average DBH: 13"

1. Harvest and utilize all marked trees within sale boundaries which contain one or more 100" sticks to a 4" top diameter.
2. Boundaries are marked in red.
3. Slash must be scattered concurrent with cutting and must be no higher than 3 feet off the ground.
4. Between May 15 and August 15 all harvested pine products must be hauled from the site within two weeks of harvest to prevent bark beetle infestation.
5. New road construction must be approved by BRSF staff.
6. Harvest may take place throughout the year.
7. Minimum Bid: \$26,400.00