

Brule River State Forest

"Last First" - Tract 03-07

T46N R10W Sec. 32,33

88 acres - Estimated Harvest Volumes: Red Pine - 1550

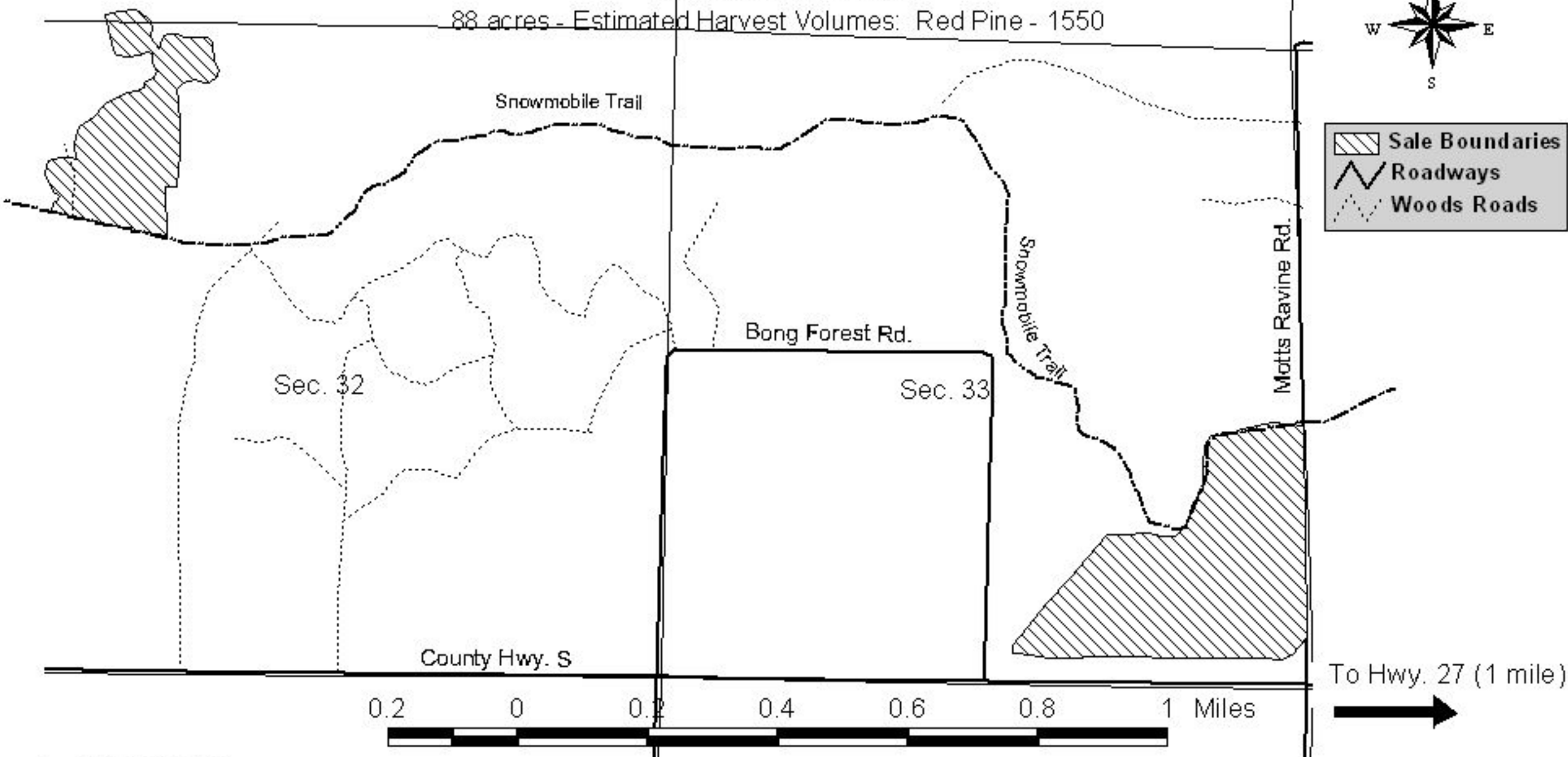
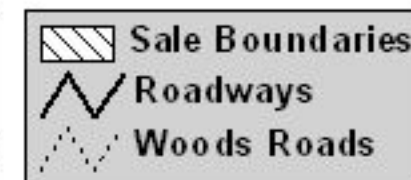

1. Row Thinning
 - a. The harvest pattern for this sale is every other row.
 - b. Harvested trees containing one or more 100" stick to a 4" top diameter are to be utilized.
 - c. Outside rows are to be left intact.
2. Between May 15 and August 15 all pine products must be hauled from the site within two weeks of harvest to prevent bark beetle infestation.
3. Access on the snowmobile trail will be restricted when open to snowmobilers.
4. Boundaries are marked in red paint.
5. Existing roads are to be utilized. New road construction must be approved by BRSF staff.
6. Trees are to be limbed and bucked at the stump. Slash is to be distributed evenly across the site. Damage to the residual stand will not be allowed.
7. Minimum bid: \$38,000.00