

Brule River State Forest

Clevedon Spruce and Aspen - Tract 02-07 - 94 acres

T47N R10W Sec. 3,10

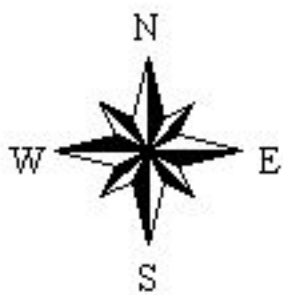
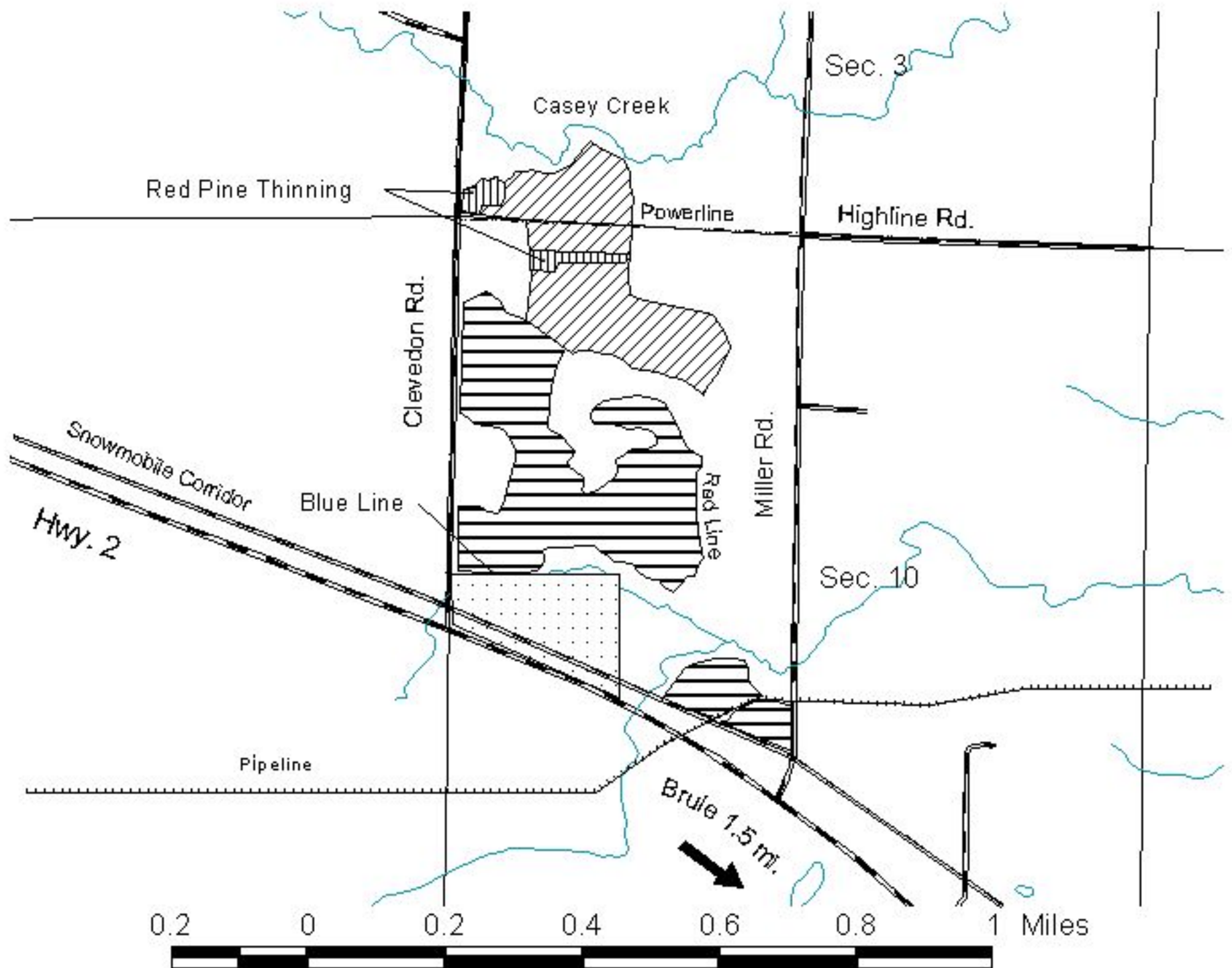

- Woods Roads
- Roads
- Section Lines
- Spruce Thinning
- Aspen Harvest

Volumes	4" top	Whole Tree
Aspen	1550	2000
Spruce	420	630
Red Pine	50	50
Mixed Hdwd	220	310

Spruce includes 10% balsam fir.
MX consists of 50% maple, 25% ash, 25% balsam poplar.

1. Aspen Harvest Area: 59 acres
 - a. Harvest and utilize all aspen, maple, ash, and balsam poplar trees containing one or more 100" sticks to a 4" diameter top.
 - b. Harvest and utilize all balsam fir and spruce which contain 3 or more 100" sticks to a 4" top.
 - c. All other trees will remain uncut and undamaged.
2. Spruce Plantation Thinning: 35 acres
 - a. Harvest patterns are two cut rows with three leave rows between.
 - b. All spruce containing one or more 100" sticks to a 4" diameter top are to be utilized.
 - c. Outside rows remain intact.
3. All marked red pine with one 100" stick to a 4" top diameter within the red pine thinning areas are to be harvested and utilized.
4. Existing roadways are to be utilized. New road construction must be approved by BRSF staff.
5. Harvest operations are restricted to dry or frozen ground only, no rutting will be tolerated.
6. The blue line at the southern end of the aspen stand marks private property. All other cutting boundaries are marked in red.
7. Slash will be distributed across the site evenly.
8. Minimum Bid: \$34,600.00