

Brule River State Forest

Witness Oak - Tract 01-07 - 66 acres

T46N R10W Sec. 31, T46N R11W Sec. 36

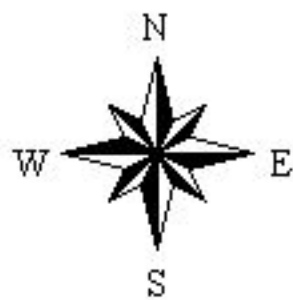
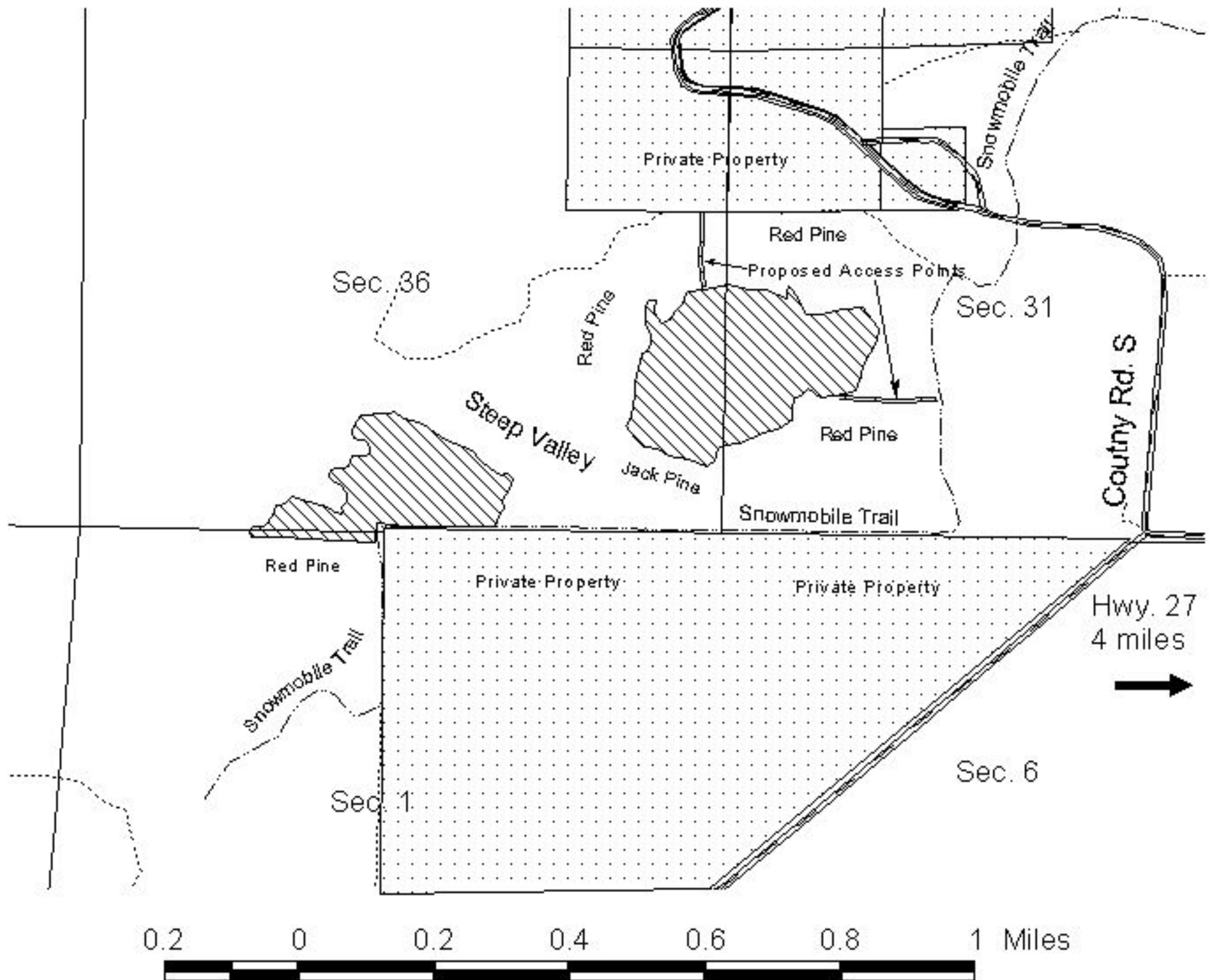

- Woods Roads
- Roads
- Section Lines
- Private Land
- Sale Boundaries

Estimated Volumes	4" top	Whole Tree
Scrub Oak	480	680
Aspen	235	300
Jack Pine	35	45
Balsam Fir	30	45

*All volumes estimated in total cords

1. Harvest and utilize all hardwood species, balsam fir, and jack pine that contain one or more 100" stick to a 4" top diameter. All other trees are to remain uncut and undamaged.
2. Between May 15 and August 15 all pine products must be moved from the site to prevent bark beetle infestation.
3. New road construction must be approved by BRSF staff.
4. Harvest can take place throughout the year. Access to the sale on the snowmobile trail will be restricted when the trail is open to snowmobilers.
5. Boundaries of the sale are marked in red.
6. Slash must be distributed across the site evenly.
7. Minimum Bid: \$8050.00