

NH-ALSF TRACT NO. 2-09

Crazy Pines

Oneida County

Town 38 North, Range 07 East

Section 14 - NESE, SESE

Section 23 - NENE, SENE

10% of the total sale bid value will be required as BID BOND.

15% of the total sale bid value will be required for a PERFORMANCE BOND.

The cutting area is approximately 74 acres.

The contract period is for 2 years.

Cut all trees that will yield one or more 100-inch sticks to the minimum top diameter.

---

ESTIMATED VOLUME (CORDS)

MINIMUM TOP DIAMETER

| <u>SPECIES</u>          | <u>4"</u> | <u>Whole Tree</u> | <u>Advertised Price Per Unit</u> |
|-------------------------|-----------|-------------------|----------------------------------|
| Aspen                   | 1050      | 1400              | \$ 20.20                         |
| Red Maple               | 310       | 420               | \$ 17.70                         |
| Red Oak                 | 60        | 80                | \$ 14.80                         |
| White Pine <sup>1</sup> | 90        | 130               | \$ 14.80                         |

ESTIMATED VOLUME (MBF)

|                         |    |          |
|-------------------------|----|----------|
| White Pine <sup>2</sup> | 40 | \$ 95.00 |
|-------------------------|----|----------|

**Total Minimum Bid Value    \$ 32,717.00**

---

<sup>1</sup> Volume: 2% (2 Cords) red Pine pulp are incorporated within the white pine pulp

<sup>2</sup> Volume: 11% (4.4 MBF) red pine logs are incorporated within the white pine logs

Special Conditions:

1. Absolutely no damage to Lyannis Road or harm to any of the residual trees or seedling/saplings.<sup>(18)</sup>
2. NO TREES WILL BE CUT AND FALLEN INTO THE WILDERNESS REST CEMETARY.<sup>(35)</sup>
3. Trees that are cut into the DOT right-of-way and the high power line right-of-way must be pulled back into the sale area for slashing and bucking.<sup>(16)</sup>
4. Slash will be kept to two feet or less lopped and scattered throughout the rest of the sale. Slash adjacent to the cemetery and Lyannis Rd. is to be one foot or less. The same applies for all adjacent landowner properties.<sup>(16)</sup>
5. The sale can be accessed on the far south end by using the snowmobile trail.<sup>(18)</sup>
6. The snowmobile trail must be maintained in the original presale condition after the harvest.<sup>(18)</sup>
7. Trails will remain open and kept free of hazards at all times during the timber harvest. When the harvest is occurring, proper "Logging Ahead" signs will be placed on all of the trails that the snowmobiles use for the public's safety.<sup>(18)</sup>
8. There are no seasonal restrictions on logging operations during the contract period.<sup>(9)</sup>

**WISCONSIN**  
**DEPARTMENT OF NATURAL RESOURCES**  
**TIMBER SALE**  
**TRACT 2-09 CRAZY PINE**  
**T38N R7E SECTIONS 14 & 23**  
**HARVEST ACRES - 74**

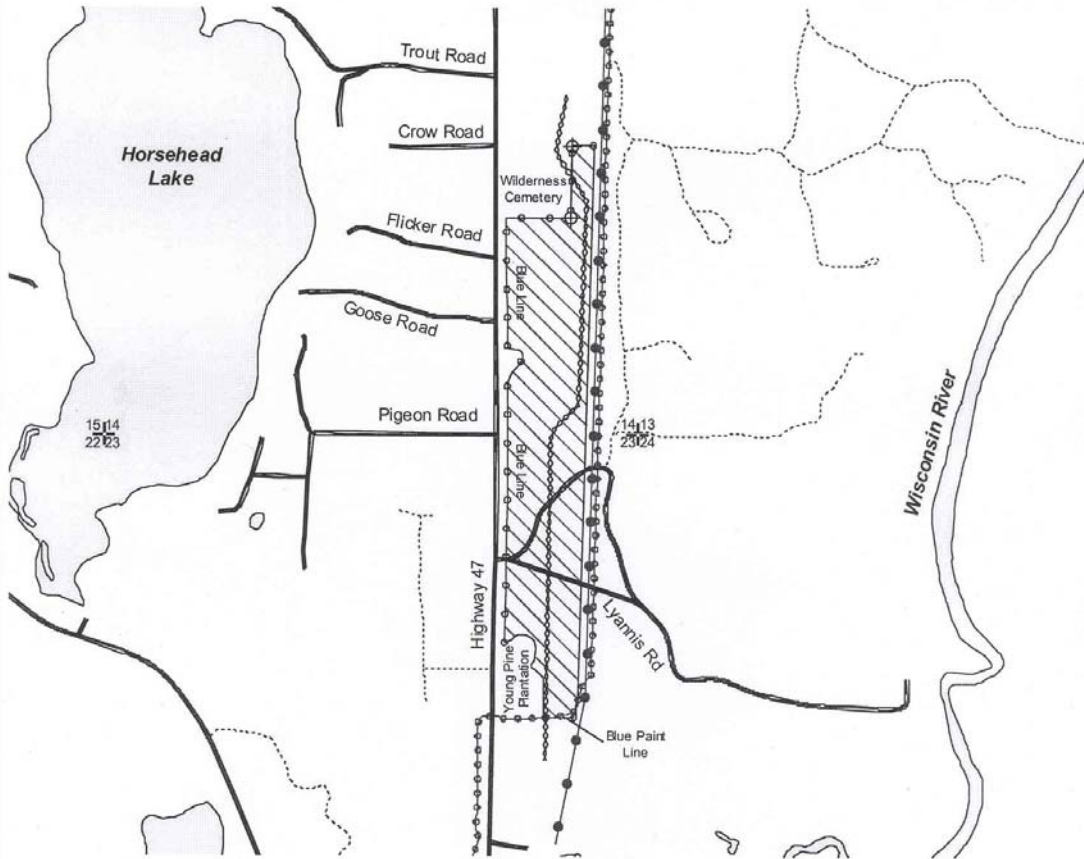

**Legend**

- ⊕ Section Corner
- ⊕ Iron Pipe
- Powerline
- Buried Gas Pipeline
- Woods Roads
- Highways and Town Roads
- Snowmobile Trails
- Lakes

General Sale Area (74 Acres): Cut all aspen and maple.  
 Cut all pine and oak marked with orange paint.

N  
 Scale: 4" = 1 Mile  
 1:15,840

