

NH-ALSF TRACT NO. 29-09
Stone Lake Hardwood

Oncida County

Town 38 North, Range 9 East

- Section 7 – SESE
- Section 8 – NESW, SWSW, SESW
- Section 17 – NWNW
- Section 18 – NENE

10% of the total sale bid value will be required as bid bond.

15% of the total sale bid value will be required for performance bond.

The cutting area is approximately 50 acres.

The contract period is 3 years.

All trees that will yield one or more 100-inch sticks to the minimum top diameter chosen by the bidder will be cut and utilized.

Whole tree utilization is authorized.

ESTIMATED VOLUME (CORDS)

MINIMUM TOP DIAMETER

<u>SPECIES</u>	<u>4"</u>	<u>Whole Tree</u>	<u>Advertised Price Per Unit</u>
Mixed Hardwood ¹	410	550	\$ 15.30
Aspen	100	130	\$ 17.00
Balsam Fir	5	5	\$ 8.50
Total Minimum Bid Value			\$ 8,015.50

¹Approximately 45% white birch, 35% soft maple, 15% hard maple and 5% yellow birch.

Special Conditions

1. Cutting must be concurrent for all species to be harvested.⁽⁹⁾
2. Slash within 50' of Town roads must be lopped and/or scattered to lie within two feet of the ground and pulled back at least ten feet behind the tree line concurrently with cutting.⁽¹⁰⁾

WISCONSIN
DEPARTMENT OF NATURAL RESOURCES
TIMBER SALE
TRACT 29-09 Stone Lake Hardwood
T38N R9E SECTIONS 7, 8, 17, & 18
HARVEST ACRES - 50

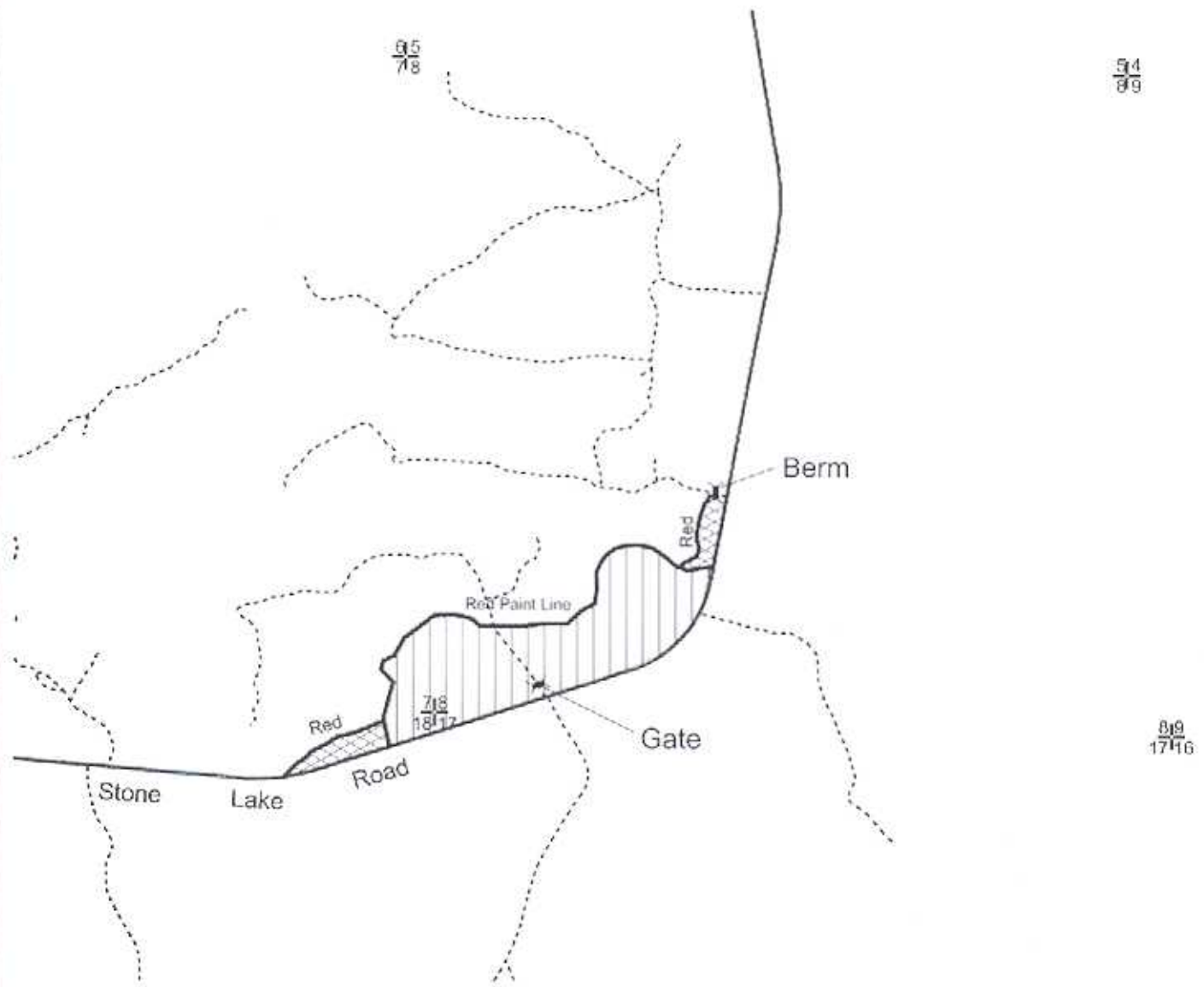

Legend

- Section Corners
- Red Paint Lines
- Woods Roads
- Major Roads
- Lakes

Marked Hardwood (44 Acres): Cut all aspen, white birch, balsam fir and trees marked with orange. (Cut only those yellow birch which are marked with orange.)

Aspen Areas (6 Acres): Cut all trees except oak, pine and hemlock. All 1-5" diameter aspen and maple must be cut concurrently with harvest.

N
 Scale: 4" = 1 Mile
 or 1:15,840

 Map produced by
 Oak, Dakin, & Co.