

Mike Schmoller
Project Manager
Wisconsin Department of Natural Resources
South Central Region
3911 Fish Hatchery Rd
Fitchburg WI 53711

Subject:

Summary of Implementation of the Final Revised Work Plan for Polychlorinated Biphenyl (PCB) Recommended Activities, Madison-Kipp Corporation Site, 201 Waubesa Street, Madison, Wisconsin. Facility ID No. 113125320, BRRTS No. 02-13-558625

Dear Mr. Schmoller:

On behalf of Madison-Kipp Corporation, this letter provides a summary of the excavation activities performed during December 2012 and January 2013 at the Madison-Kipp site located at 201 Waubesa Street in Madison, Wisconsin (Figure 1). These excavation activities were performed per the *Final Revised Work Plan for Polychlorinated Biphenyl Recommended Activities* (Final Work Plan) dated December 4, 2012. The Final Work Plan was submitted to the Wisconsin Department of Natural Resources (WDNR) and United States Environmental Protection Agency (U.S. EPA) for approval. The WDNR, in conjunction with the U.S. EPA, provided approval of the Final Work Plan in a letter dated December 5, 2012. The off-site residential excavation activities will be summarized in a separate submittal.

The following presents a brief description of the approved work presented in the Final Work Plan:

- Excavation of on-site soils containing PCBs at concentrations above 50 milligrams per kilogram (mg/kg) and disposal at a Toxic Substances Control Act (TSCA) approved landfill. Figure 2 presents the areas where total PCBs were detected above 50 mg/kg at depths of 0 to 2 feet below ground surface (bgs).
- Implementation of engineering/institutional controls for soils left in-place on-site containing concentrations of PCBs between 1 and 50 mg/kg.

Imagine the result

ARCADIS U.S., Inc.
126 North Jefferson Street
Suite 400
Milwaukee
Wisconsin 53202
Tel 414 276 7742
Fax 414 276 7603
www.arcadis-us.com

ENVIRONMENT

Date:
September 16, 2013

Contact:
Jennine Trask

Phone:
414.277.6203

Email:
Jennine.Trask@arcadis-us.com

Our ref:
WI001368.0007.00001

- Advance and sample additional soil borings on the off-site residential properties to further define the PCB detections present within the southwest corridor on-site.

This letter report documents the excavation, disposal, confirmation soil sampling, and backfill activities. As part of the overall site remedy, an engineered cap will be implemented at the site. The design of the engineered cap, and a cap maintenance and materials handling plan will be provided under separate submittal. Information regarding the additional soil borings advanced in the southwest corridor was presented in the *Addendum to the Final Revised Work Plan for Polychlorinated Biphenyl Recommended Activities* report submitted to the WDNR and U.S. EPA on December 14, 2012.

Pre-Excavation Activities

Prior to beginning the excavation activities, a neighborhood notification was distributed in coordination with the WDNR. Utility marking arrangements were made through Digger's Hotline (the State of Wisconsin Public Utility clearance service), a ground penetrating radar survey, a private utility locator and discussions with Madison-Kipp Corporation. Additionally, the work was coordinated with Madison Gas & Electric as a portion of the east excavation was located above and adjacent to an electric line. Excavation activities did not proceed until utilities were cleared and Madison Gas & Electric personnel approved the work.

Excavation Activities

Excavation and backfill activities were performed on site from December 17, 2012 through January 11, 2013. Two areas were excavated as presented on Figure 2. The east excavation measured approximately 135 feet long by 18 to 36 feet wide by 2 to 4 feet deep as illustrated on Figure 3. The west excavation measured approximately 45 feet long by 45 feet wide by 2 to 3 feet deep as illustrated on Figure 4. Soils were either direct loaded into trucks for disposal or stockpiled on site prior to loading, transportation and disposal. Any stockpiled soils were placed on and covered with plastic sheeting.

A total of approximately 670 tons of soil were excavated and disposed at the Environmental Quality Company's Wayne Disposal, Inc. Site #2 Landfill, which is a TSCA permitted landfill located in Belleville, Michigan.

Confirmation Soil Sampling

Confirmation soil samples were collected from approximately every 5 feet along the side walls and every 8 feet along the base of the excavation areas in accordance with the Final Work Plan. A total of 36 side wall and 48 base samples were collected from the east excavation area. Per the Final Work Plan, due to the number of pre-excavation samples collected along the eastern property boundary that comprises the east side of the east excavation, additional confirmation samples were not collected from this area. A total of 38 side wall and 25 base samples were collected from the west excavation area. Figures 3 and 4 present the sample locations. The soil samples were submitted for laboratory analysis of PCBs by U.S. EPA SW-846 Method 8082. Samples were collected in clean, laboratory-supplied sample containers and placed in a cooler filled with ice. The samples were submitted using appropriate chain-of-custody procedures.

Confirmation sampling indicated one soil confirmation sample in the west excavation and 10 soil confirmation samples in the east excavation contained concentrations above 50 mg/kg. This data was submitted to WDNR with the recommendation to complete additional excavation and confirmation sampling in areas where the confirmation samples exceeded 50 mg/kg. Following receipt of WDNR approval, the additional excavation was completed to 3 to 4 feet bgs in the areas where the results exceeded 50 mg/kg. Additional confirmation soil samples were then collected from the base and/or sidewalls of the additional excavation areas as necessary. An additional 15 side wall samples and 13 base samples were submitted for laboratory analysis of PCBs from the east excavation. One additional base sample was submitted for laboratory analysis of PCBs from the west excavation. Review of the additional confirmation soil sample results confirmed that all results were below 50 mg/kg, and the results were conveyed to WDNR for approval prior to initiating backfill activities. A summary of the confirmation soil sample analytical results is presented in Table 1. The sample locations for the east excavation area are illustrated on Figure 3 and the sample locations for the west excavation area are illustrated on Figure 4.

Quality Assurance/Quality Control (QA/QC)

Several QA/QC measures were utilized to ensure the integrity of the soil sampling procedures and laboratory analysis including collecting and analyzing equipment blank samples, matrix spike/matrix spike duplicate (MS/MSD) samples and field duplicate samples.

Equipment blank samples were collected at a frequency of one per 10 sampling equipment decontamination procedures. Equipment blank samples were collected by routing laboratory provided deionized water through decontaminated sampling equipment. Equipment blank samples were analyzed to check procedural contamination and/or ambient conditions and/or sample container contamination at the site that may cause sample contamination. A total of 16 equipment blank samples were submitted for laboratory analysis.

Laboratory accuracy was assessed by determining percent recoveries from the analysis of laboratory control samples. Accuracy relative to the sample matrix was assessed by determining percent recoveries from the analysis of MS/MSD samples. MS/MSD samples were collected/designated for analysis at a minimum frequency of one per 20 or fewer samples. A total of nine MS/MSD samples were submitted for laboratory analysis.

Precision is defined as the measure of agreement among repeated measurements of the same property under identical or substantially similar locations. Field duplicate samples were collected at a minimum frequency of one per 20 investigative samples to evaluate the precision of the field sample collection procedures. A total of 10 duplicate samples were taken in the field and submitted for laboratory analysis.

After review of the QA/QC sample data, there was no evidence of contamination or other anomalies that would indicate inaccurate or misrepresentative data. All QA/QC sample results were within acceptable limits.

Backfill

Following receipt of the final soil confirmation sample analytical results and WDNR's approval to proceed with backfill activities, the east and west excavation areas were backfilled with 3-inch crushed stone to a depth of 1 foot bgs. The remaining foot was backfilled with ¾-inch crushed stone and compacted in 6-inch maximum lifts using a vibratory roller compactor. Asphalt replacement will be handled directly by Madison-Kipp as part of the implementation of an engineered cap.

If you have any questions or require any additional information, please contact us at 414.276.7742.

Sincerely,

ARCADIS U.S., Inc.



Christopher D. Kubacki, PE
Senior Engineer



Jennine L. Trask, PE
Project Manager

Attachments:

Table 1 – Excavation Confirmation Soil Sample Analytical Results

Figure 1 – Site Location Map

Figure 2 – Proposed Excavation Area (0-2 Feet Below Ground Surface)

Figure 3 – East Excavation Area

Figure 4 – West Excavation Area

Copies:

David Crass – Michael Best

Linda Hanefeld - WDNR

Mark Meunier – Madison-Kipp Corporation

Robert Nauta – RJN Environmental Services (electronic)

Steve Tinker – Wisconsin Department of Justice (electronic)

Ken Zolnierczyk – U.S. EPA (electronic)

Table 1. Excavation Confirmation Soil Sample Analytical Results, Madison-Kipp Corporation, 201 Waubesa Street, Madison, Wisconsin.

Sample ID	Non-Industrial	Industrial	EPA High	TSCA	E-BA1	E-BA2	E-BA2D	E-BA3
Sample Date	Direct	Direct	Occupancy	Disposal	12/19/2012	12/19/2012	1/4/2013	12/19/2012
Sample Location	Contact RCL	Contact RCL	Cleanup Level	Limit	East Ex-base	East Ex-base	East Ex-base	East Ex-base
Aroclor-1242	0.222	0.744	NE	NE	8.3	73	0.0077 J	<0.13
Aroclor-1248	0.222	0.744	NE	NE	<0.79	<1.6	<0.008	3.1
Aroclor-1254	0.222	0.744	NE	NE	<0.43	<0.87	<0.0044	<0.087
Total Detected PCBs	NE	NE	1	50	8.3	73	0.0077	3.1

Concentrations presented in milligrams per kilogram (mg/kg).

Only detected constituents are listed.

100 Exceeds the WDNR's non-industrial direct contact residual contaminant level.

100 Exceeds the WDNR's industrial direct contact residual contaminant level.

100 Exceeds the Toxic Substances Control Act disposal limit.

100 Exceeds the EPA's self-implementing high-occupancy cleanup level with no site restrictions.

< Constituent not detected above noted laboratory detection limit.

J Constituent concentration is an approximate value.

NE Criteria not established.

ND Total PCBs less than the laboratory detection limit.

PCBs Polychlorinated biphenyls.

RCL Residual contaminant level.

TSCA Toxic Substances Control Act.

EPA United States Environmental Protection Agency.

East Ex East excavation.

West Ex West excavation.

Table 1. Excavation Confirmation Soil Sample Analytical Results, Madison-Kipp Corporation, 201 Waubesa Street, Madison, Wisconsin.

Sample ID	E-BA4	E-BB1	E-BB2	E-BB3	E-BB4	E-BC1	E-BC2
Sample Date	12/19/2012	12/19/2012	12/19/2012	12/19/2012	12/19/2012	12/19/2012	12/19/2012
Sample Location	East Ex-base	East Ex-base	East Ex-base	East Ex-base	East Ex-base	East Ex-base	East Ex-base
Aroclor-1242	0.82	3.7	10	18	9.8	0.098	<0.0067
Aroclor-1248	<0.037	<0.16	<0.77	<0.78	<0.74	<0.0069	<0.008
Aroclor-1254	<0.02	<0.087	<0.42	<0.43	<0.41	<0.0038	<0.0044
Total Detected PCBs	0.82	3.7	10	18	9.8	0.098	ND

Concentrations presented in milligrams per kilogram (mg/kg).

Only detected constituents are listed.

100 Exceeds the WDNR's non-industrial direct contact residual contaminant level.

100 Exceeds the WDNR's industrial direct contact residual contaminant level.

100 Exceeds the Toxic Substances Control Act disposal limit.

100 Exceeds the EPA's self-implementing high-occupancy cleanup level with no site restrictions.

< Constituent not detected above noted laboratory detection limit.

J Constituent concentration is an approximate value.

NE Criteria not established.

ND Total PCBs less than the laboratory detection limit.

PCBs Polychlorinated biphenyls.

RCL Residual contaminant level.

TSCA Toxic Substances Control Act.

EPA United States Environmental Protection Agency.

East Ex East excavation.

West Ex West excavation.

Table 1. Excavation Confirmation Soil Sample Analytical Results, Madison-Kipp Corporation, 201 Waubesa Street, Madison, Wisconsin.

Sample ID	E-BC3	E-BC4	E-BD1	E-BD1D	E-BD2	E-BD3	E-BD4
Sample Date	12/19/2012	12/19/2012	12/19/2012	1/3/2013	12/19/2012	12/19/2012	12/19/2012
Sample Location	East Ex-base	East Ex-base	East Ex-base	East Ex-base	East Ex-base	East Ex-base	East Ex-base
Aroclor-1242	23	0.08	55	<0.006	0.89	45	0.013 J
Aroclor-1248	<0.72	<0.0076	<1.3	<0.0072	<0.041	<1.6	<0.0071
Aroclor-1254	<0.39	0.15	<0.73	<0.0039	<0.022	<0.85	0.01 J
Total Detected PCBs	23	0.23	55	ND	0.89	45	0.023

Concentrations presented in milligrams per kilogram (mg/kg).

Only detected constituents are listed.

100 Exceeds the WDNR's non-industrial direct contact residual contaminant level.

100 Exceeds the WDNR's industrial direct contact residual contaminant level.

100 Exceeds the Toxic Substances Control Act disposal limit.

100 Exceeds the EPA's self-implementing high-occupancy cleanup level with no site restrictions.

< Constituent not detected above noted laboratory detection limit.

J Constituent concentration is an approximate value.

NE Criteria not established.

ND Total PCBs less than the laboratory detection limit.

PCBs Polychlorinated biphenyls.

RCL Residual contaminant level.

TSCA Toxic Substances Control Act.

EPA United States Environmental Protection Agency.

East Ex East excavation.

West Ex West excavation.

Table 1. Excavation Confirmation Soil Sample Analytical Results, Madison-Kipp Corporation, 201 Waubesa Street, Madison, Wisconsin.

Sample ID	E-BE1	E-BE2	E-BE2D	E-BE3	E-BE4	E-BF1	E-BF2	E-BF3
Sample Date	12/19/2012	12/19/2012	1/3/2013	12/19/2012	12/19/2012	12/19/2012	12/19/2012	12/19/2012
Sample Location	East Ex-base	East Ex-base	East Ex-base	East Ex-base	East Ex-base	East Ex-base	East Ex-base	East Ex-base
Aroclor-1242	1.3	90	0.008 J	7.7	0.053	1.4	0.029	76
Aroclor-1248	<0.067	<7.9	<0.0076	<1.5	<0.0074	<0.064	<0.0077	<7.3
Aroclor-1254	<0.037	<4.3	<0.0042	<0.83	0.018 J	<0.035	<0.0042	<4
Total Detected PCBs	1.3	90	0.008	7.7	0.071	1.4	0.029	76

Concentrations presented in milligrams per kilogram (mg/kg).

Only detected constituents are listed.

100 Exceeds the WDNR's non-industrial direct contact residual contaminant level.

100 Exceeds the WDNR's industrial direct contact residual contaminant level.

100 Exceeds the Toxic Substances Control Act disposal limit.

100 Exceeds the EPA's self-implementing high-occupancy cleanup level with no site restrictions.

< Constituent not detected above noted laboratory detection limit.

J Constituent concentration is an approximate value.

NE Criteria not established.

ND Total PCBs less than the laboratory detection limit.

PCBs Polychlorinated biphenyls.

RCL Residual contaminant level.

TSCA Toxic Substances Control Act.

EPA United States Environmental Protection Agency.

East Ex East excavation.

West Ex West excavation.

Table 1. Excavation Confirmation Soil Sample Analytical Results, Madison-Kipp Corporation, 201 Waubesa Street, Madison, Wisconsin.

Sample ID	E-BF3D	E-BF4	E-BG1	E-BG2	E-BG3	E-BG4	E-BG5	E-BH1
Sample Date	1/3/2013	12/19/2012	12/27/2012	12/27/2012	12/27/2012	12/27/2012	1/3/2013	12/27/2012
Sample Location	East Ex-base	East Ex-base	East Ex-base	East Ex-base	East Ex-base	East Ex-base	East Ex-base	East Ex-base
Aroclor-1242	9.1	0.11	0.36	2	15	0.067	<0.0055	0.14
Aroclor-1248	<0.3	<0.0069	<0.07	<0.093	<0.84	<0.0068	0.04	<0.0069
Aroclor-1254	<0.17	0.046	<0.038	<0.051	<0.46	<0.0037	<0.0036	<0.0038
Total Detected PCBs	9.1	0.156	0.36	2	15	0.067	0.04	0.14

Concentrations presented in milligrams per kilogram (mg/kg).

Only detected constituents are listed.

100 Exceeds the WDNR's non-industrial direct contact residual contaminant level.

100 Exceeds the WDNR's industrial direct contact residual contaminant level.

100 Exceeds the Toxic Substances Control Act disposal limit.

100 Exceeds the EPA's self-implementing high-occupancy cleanup level with no site restrictions.

< Constituent not detected above noted laboratory detection limit.

J Constituent concentration is an approximate value.

NE Criteria not established.

ND Total PCBs less than the laboratory detection limit.

PCBs Polychlorinated biphenyls.

RCL Residual contaminant level.

TSCA Toxic Substances Control Act.

EPA United States Environmental Protection Agency.

East Ex East excavation.

West Ex West excavation.

Table 1. Excavation Confirmation Soil Sample Analytical Results, Madison-Kipp Corporation, 201 Waubesa Street, Madison, Wisconsin.

Sample ID	E-BH2	E-BH3	E-BH4	E-BH5	E-BI1	E-BI1D	E-BI2	E-BJ1
Sample Date	12/27/2012	12/27/2012	12/27/2012	1/3/2013	12/27/2012	1/3/2013	12/27/2012	12/27/2012
Sample Location	East Ex-base	East Ex-base	East Ex-base	East Ex-base	East Ex-base	East Ex-base	East Ex-base	East Ex-base
Aroclor-1242	6.4	10	0.021	0.17	57	<0.0066	0.017	0.34
Aroclor-1248	<0.73	<0.85	<0.0065	<0.0066	<1.5	<0.0079	<0.0068	<0.0087
Aroclor-1254	<0.4	<0.47	<0.0036	<0.0036	<0.84	<0.0043	<0.0037	<0.0048
Total Detected PCBs	6.4	10	0.021	0.17	57	ND	0.017	0.34

Concentrations presented in milligrams per kilogram (mg/kg).

Only detected constituents are listed.

100 Exceeds the WDNR's non-industrial direct contact residual contaminant level.

100 Exceeds the WDNR's industrial direct contact residual contaminant level.

100 Exceeds the Toxic Substances Control Act disposal limit.

100 Exceeds the EPA's self-implementing high-occupancy cleanup level with no site restrictions.

< Constituent not detected above noted laboratory detection limit.

J Constituent concentration is an approximate value.

NE Criteria not established.

ND Total PCBs less than the laboratory detection limit.

PCBs Polychlorinated biphenyls.

RCL Residual contaminant level.

TSCA Toxic Substances Control Act.

EPA United States Environmental Protection Agency.

East Ex East excavation.

West Ex West excavation.

Table 1. Excavation Confirmation Soil Sample Analytical Results, Madison-Kipp Corporation, 201 Waubesa Street, Madison, Wisconsin.

Sample ID	E-BJ2	E-BK1	E-BK2	E-BL1	E-BL2	E-BM1	E-BM2	E-BN1
Sample Date	12/27/2012	12/27/2012	12/27/2012	12/27/2012	12/27/2012	12/27/2012	12/27/2012	12/27/2012
Sample Location	East Ex-base	East Ex-base	East Ex-base	East Ex-base	East Ex-base	East Ex-base	East Ex-base	East Ex-base
Aroclor-1242	<0.0056	4.4	<0.0055	<0.0066	0.019	<0.0067	<0.0056	<0.007
Aroclor-1248	<0.0068	<0.17	<0.0066	<0.0079	<0.007	<0.008	<0.0067	<0.0084
Aroclor-1254	<0.0037	<0.091	<0.0036	<0.0043	<0.0038	<0.0044	<0.0037	0.12
Total Detected PCBs	ND	4.4	ND	ND	0.019	ND	ND	0.12

Concentrations presented in milligrams per kilogram (mg/kg).

Only detected constituents are listed.

100 Exceeds the WDNR's non-industrial direct contact residual contaminant level.

100 Exceeds the WDNR's industrial direct contact residual contaminant level.

100 Exceeds the Toxic Substances Control Act disposal limit.

100 Exceeds the EPA's self-implementing high-occupancy cleanup level with no site restrictions.

< Constituent not detected above noted laboratory detection limit.

J Constituent concentration is an approximate value.

NE Criteria not established.

ND Total PCBs less than the laboratory detection limit.

PCBs Polychlorinated biphenyls.

RCL Residual contaminant level.

TSCA Toxic Substances Control Act.

EPA United States Environmental Protection Agency.

East Ex East excavation.

West Ex West excavation.

Table 1. Excavation Confirmation Soil Sample Analytical Results, Madison-Kipp Corporation, 201 Waubesa Street, Madison, Wisconsin.

Sample ID	E-BN2	E-BO1	E-BO2	E-BP1	E-BP2	E-BQ1	E-BQ2	E-BQ3
Sample Date	12/27/2012	12/27/2012	12/27/2012	12/27/2012	12/27/2012	1/4/2013	1/4/2013	1/4/2013
Sample Location	East Ex-base	East Ex-base	East Ex-base	East Ex-base	East Ex-base	East Ex-base	East Ex-base	East Ex-base
Aroclor-1242	<0.0061	1	<0.0056	<1.4	<0.0058	0.037	0.019 J	0.028
Aroclor-1248	<0.0073	<0.073	<0.0067	<1.7	<0.0069	<0.0077	<0.0077	<0.0078
Aroclor-1254	0.043	<0.04	<0.0037	20	<0.0038	<0.0042	<0.0042	<0.0043
Total Detected PCBs	0.043	1	ND	20	ND	0.037	0.019	0.028

Concentrations presented in milligrams per kilogram (mg/kg).

Only detected constituents are listed.

100 Exceeds the WDNR's non-industrial direct contact residual contaminant level.

100 Exceeds the WDNR's industrial direct contact residual contaminant level.

100 Exceeds the Toxic Substances Control Act disposal limit.

100 Exceeds the EPA's self-implementing high-occupancy cleanup level with no site restrictions.

< Constituent not detected above noted laboratory detection limit.

J Constituent concentration is an approximate value.

NE Criteria not established.

ND Total PCBs less than the laboratory detection limit.

PCBs Polychlorinated biphenyls.

RCL Residual contaminant level.

TSCA Toxic Substances Control Act.

EPA United States Environmental Protection Agency.

East Ex East excavation.

West Ex West excavation.

Table 1. Excavation Confirmation Soil Sample Analytical Results, Madison-Kipp Corporation, 201 Waubesa Street, Madison, Wisconsin.

Sample ID	E-BR1	E-BR2	E-BR3	ENW-1	ENW-2	ENW-3
Sample Date	1/4/2013	1/4/2013	1/4/2013	12/19/2012	12/19/2012	12/19/2012
Sample Location	East Ex-base	East Ex-base	East Ex-base	East Ex-north side wall	East Ex-north side wall	East Ex-north side wall
Aroclor-1242	1.2	0.04	0.0076 J	1,200	210	390
Aroclor-1248	<0.078	<0.008	<0.0076	<37	<7.5	<15
Aroclor-1254	<0.043	<0.0044	<0.0042	<20	<4.1	<8.3
Total Detected PCBs	1.2	0.04	0.0076	1,200	210	390

Concentrations presented in milligrams per kilogram (mg/kg).

Only detected constituents are listed.

100 Exceeds the WDNR's non-industrial direct contact residual contaminant level.

100 Exceeds the WDNR's industrial direct contact residual contaminant level.

100 Exceeds the Toxic Substances Control Act disposal limit.

100 Exceeds the EPA's self-implementing high-occupancy cleanup level with no site restrictions.

< Constituent not detected above noted laboratory detection limit.

J Constituent concentration is an approximate value.

NE Criteria not established.

ND Total PCBs less than the laboratory detection limit.

PCBs Polychlorinated biphenyls.

RCL Residual contaminant level.

TSCA Toxic Substances Control Act.

EPA United States Environmental Protection Agency.

East Ex East excavation.

West Ex West excavation.

Table 1. Excavation Confirmation Soil Sample Analytical Results, Madison-Kipp Corporation, 201 Waubesa Street, Madison, Wisconsin.

Sample ID	ENW-4	ENW-5	ENW-6	ENW-7	ENW-8
Sample Date	12/19/2012	12/19/2012	12/19/2012	1/4/2013	1/4/2013
Sample Location	East Ex-north side wall	East Ex-north side wall	East Ex-north side wall	East Ex-north side wall	East Ex-north side wall
Aroclor-1242	100	<0.034	8.1	0.0069 J	0.069
Aroclor-1248	<7.4	0.49	<0.78	<0.0077	<0.0076
Aroclor-1254	<4.1	<0.022	<0.43	<0.0042	<0.0041
Total Detected PCBs	100	0.49	8.1	0.0069	0.069

Concentrations presented in milligrams per kilogram (mg/kg).

Only detected constituents are listed.

100 Exceeds the WDNR's non-industrial direct contact residual contaminant level.

100 Exceeds the WDNR's industrial direct contact residual contaminant level.

100 Exceeds the Toxic Substances Control Act disposal limit.

100 Exceeds the EPA's self-implementing high-occupancy cleanup level with no site restrictions.

< Constituent not detected above noted laboratory detection limit.

J Constituent concentration is an approximate value.

NE Criteria not established.

ND Total PCBs less than the laboratory detection limit.

PCBs Polychlorinated biphenyls.

RCL Residual contaminant level.

TSCA Toxic Substances Control Act.

EPA United States Environmental Protection Agency.

East Ex East excavation.

West Ex West excavation.

Table 1. Excavation Confirmation Soil Sample Analytical Results, Madison-Kipp Corporation, 201 Waubesa Street, Madison, Wisconsin.

Sample ID	ENW-9	ENW-10	ENW-11	ENW-12	ENW-13
Sample Date	1/4/2013	1/4/2013	1/4/2013	1/4/2013	1/4/2013
Sample Location	East Ex-north side wall	East Ex-north side wall	East Ex-north side wall	East Ex-north side wall	East Ex-north side wall
Aroclor-1242	0.031	0.16	0.82	0.51	0.23
Aroclor-1248	<0.0077	<0.0078	<0.04	<0.016	<0.008
Aroclor-1254	<0.0042	<0.0043	<0.022	<0.0088	<0.0044
Total Detected PCBs	0.031	0.16	0.82	0.51	0.23

Concentrations presented in milligrams per kilogram (mg/kg).

Only detected constituents are listed.

100 Exceeds the WDNR's non-industrial direct contact residual contaminant level.

100 Exceeds the WDNR's industrial direct contact residual contaminant level.

100 Exceeds the Toxic Substances Control Act disposal limit.

100 Exceeds the EPA's self-implementing high-occupancy cleanup level with no site restrictions.

< Constituent not detected above noted laboratory detection limit.

J Constituent concentration is an approximate value.

NE Criteria not established.

ND Total PCBs less than the laboratory detection limit.

PCBs Polychlorinated biphenyls.

RCL Residual contaminant level.

TSCA Toxic Substances Control Act.

EPA United States Environmental Protection Agency.

East Ex East excavation.

West Ex West excavation.

Table 1. Excavation Confirmation Soil Sample Analytical Results, Madison-Kipp Corporation, 201 Waubesa Street, Madison, Wisconsin.

Sample ID	ENW-14	ENW-15	ENW-16	ENW-17	ESW-1
Sample Date	1/4/2013	1/4/2013	1/4/2013	1/4/2013	12/18/2012
Sample Location	East Ex-north side wall	East Ex-north side wall	East Ex-north side wall	East Ex-north side wall	East Ex-south side wall
Aroclor-1242	0.016 J	<0.0066	0.01 J	<0.0066	0.037
Aroclor-1248	<0.008	<0.0079	<0.0081	<0.0079	<0.0079
Aroclor-1254	<0.0044	<0.0043	<0.0044	<0.0043	<0.0043
Total Detected PCBs	0.016	ND	0.01	ND	0.037

Concentrations presented in milligrams per kilogram (mg/kg).

Only detected constituents are listed.

100 Exceeds the WDNR's non-industrial direct contact residual contaminant level.

100 Exceeds the WDNR's industrial direct contact residual contaminant level.

100 Exceeds the Toxic Substances Control Act disposal limit.

100 Exceeds the EPA's self-implementing high-occupancy cleanup level with no site restrictions.

< Constituent not detected above noted laboratory detection limit.

J Constituent concentration is an approximate value.

NE Criteria not established.

ND Total PCBs less than the laboratory detection limit.

PCBs Polychlorinated biphenyls.

RCL Residual contaminant level.

TSCA Toxic Substances Control Act.

EPA United States Environmental Protection Agency.

East Ex East excavation.

West Ex West excavation.

Table 1. Excavation Confirmation Soil Sample Analytical Results, Madison-Kipp Corporation, 201 Waubesa Street, Madison, Wisconsin.

Sample ID	ESW-2	ESW-3	ESW-4	EW-0	EW-1
Sample Date	12/19/2012	12/19/2012	12/18/2012	12/19/2012	12/19/2012
Sample Location	East Ex-south side wall	East Ex-south side wall	East Ex-south side wall	East Ex-west side wall	East Ex-west side wall
Aroclor-1242	9.4	0.099	0.039	0.048	15
Aroclor-1248	<0.69	<0.0072	<0.0066	<0.0079	<1.3
Aroclor-1254	<0.38	<0.004	0.033	<0.0043	<0.72
Total Detected PCBs	9.4	0.099	0.072	0.048	15

Concentrations presented in milligrams per kilogram (mg/kg).

Only detected constituents are listed.

100 Exceeds the WDNR's non-industrial direct contact residual contaminant level.

100 Exceeds the WDNR's industrial direct contact residual contaminant level.

100 Exceeds the Toxic Substances Control Act disposal limit.

100 Exceeds the EPA's self-implementing high-occupancy cleanup level with no site restrictions.

< Constituent not detected above noted laboratory detection limit.

J Constituent concentration is an approximate value.

NE Criteria not established.

ND Total PCBs less than the laboratory detection limit.

PCBs Polychlorinated biphenyls.

RCL Residual contaminant level.

TSCA Toxic Substances Control Act.

EPA United States Environmental Protection Agency.

East Ex East excavation.

West Ex West excavation.

Table 1. Excavation Confirmation Soil Sample Analytical Results, Madison-Kipp Corporation, 201 Waubesa Street, Madison, Wisconsin.

Sample ID	EWW-2	EWW-3	EWW-4	EWW-5	EWW-6
Sample Date	12/19/2012	12/19/2012	12/19/2012	12/19/2012	12/19/2012
Sample Location	East Ex-west side wall	East Ex-west side wall	East Ex-west side wall	East Ex-west side wall	East Ex-west side wall
Aroclor-1242	0.019 J	2.3	<0.0054	0.14	0.68
Aroclor-1248	<0.0078	<0.33	0.14	<0.0068	<0.035
Aroclor-1254	<0.0043	<0.18	<0.0036	<0.0037	<0.019
Total Detected PCBs	0.019	2.3	0.14	0.14	0.68

Concentrations presented in milligrams per kilogram (mg/kg).

Only detected constituents are listed.

100 Exceeds the WDNR's non-industrial direct contact residual contaminant level.

100 Exceeds the WDNR's industrial direct contact residual contaminant level.

100 Exceeds the Toxic Substances Control Act disposal limit.

100 Exceeds the EPA's self-implementing high-occupancy cleanup level with no site restrictions.

< Constituent not detected above noted laboratory detection limit.

J Constituent concentration is an approximate value.

NE Criteria not established.

ND Total PCBs less than the laboratory detection limit.

PCBs Polychlorinated biphenyls.

RCL Residual contaminant level.

TSCA Toxic Substances Control Act.

EPA United States Environmental Protection Agency.

East Ex East excavation.

West Ex West excavation.

Table 1. Excavation Confirmation Soil Sample Analytical Results, Madison-Kipp Corporation, 201 Waubesa Street, Madison, Wisconsin.

Sample ID	EW-7	EW-8	EW-9	EW-10	EW-11
Sample Date	12/19/2012	12/19/2012	12/19/2012	12/19/2012	12/19/2012
Sample Location	East Ex-west side wall	East Ex-west side wall	East Ex-west side wall	East Ex-west side wall	East Ex-west side wall
Aroclor-1242	0.33	0.53	4.8	54	0.023
Aroclor-1248	<0.0067	<0.033	<0.14	<1.4	<0.007
Aroclor-1254	<0.0037	<0.018	<0.074	<0.74	<0.0038
Total Detected PCBs	0.33	0.53	4.8	54	0.023

Concentrations presented in milligrams per kilogram (mg/kg).

Only detected constituents are listed.

100 Exceeds the WDNR's non-industrial direct contact residual contaminant level.

100 Exceeds the WDNR's industrial direct contact residual contaminant level.

100 Exceeds the Toxic Substances Control Act disposal limit.

100 Exceeds the EPA's self-implementing high-occupancy cleanup level with no site restrictions.

< Constituent not detected above noted laboratory detection limit.

J Constituent concentration is an approximate value.

NE Criteria not established.

ND Total PCBs less than the laboratory detection limit.

PCBs Polychlorinated biphenyls.

RCL Residual contaminant level.

TSCA Toxic Substances Control Act.

EPA United States Environmental Protection Agency.

East Ex East excavation.

West Ex West excavation.

Table 1. Excavation Confirmation Soil Sample Analytical Results, Madison-Kipp Corporation, 201 Waubesa Street, Madison, Wisconsin.

Sample ID	EW-12	EW-13	EW-14	EW-15	EW-16
Sample Date	12/19/2012	12/19/2012	12/19/2012	12/19/2012	12/19/2012
Sample Location	East Ex-west side wall	East Ex-west side wall	East Ex-west side wall	East Ex-west side wall	East Ex-west side wall
Aroclor-1242	<0.027	0.1	0.014 J	0.12	0.036
Aroclor-1248	0.93	<0.0069	<0.0071	<0.007	<0.0072
Aroclor-1254	<0.018	<0.0038	<0.0039	<0.0039	<0.0039
Total Detected PCBs	0.93	0.1	0.014	0.12	0.036

Concentrations presented in milligrams per kilogram (mg/kg).

Only detected constituents are listed.

100 Exceeds the WDNR's non-industrial direct contact residual contaminant level.

100 Exceeds the WDNR's industrial direct contact residual contaminant level.

100 Exceeds the Toxic Substances Control Act disposal limit.

100 Exceeds the EPA's self-implementing high-occupancy cleanup level with no site restrictions.

< Constituent not detected above noted laboratory detection limit.

J Constituent concentration is an approximate value.

NE Criteria not established.

ND Total PCBs less than the laboratory detection limit.

PCBs Polychlorinated biphenyls.

RCL Residual contaminant level.

TSCA Toxic Substances Control Act.

EPA United States Environmental Protection Agency.

East Ex East excavation.

West Ex West excavation.

Table 1. Excavation Confirmation Soil Sample Analytical Results, Madison-Kipp Corporation, 201 Waubesa Street, Madison, Wisconsin.

Sample ID	EW-17	EW-18	EW-19	EW-20	EW-21
Sample Date	12/19/2012	12/18/2012	12/18/2012	12/18/2012	12/18/2012
Sample Location	East Ex-west side wall	East Ex-west side wall	East Ex-west side wall	East Ex-west side wall	East Ex-west side wall
Aroclor-1242	<0.0061	0.017 J	<0.006	<0.0057	<0.0063
Aroclor-1248	<0.0073	<0.0072	<0.0072	<0.0069	<0.0076
Aroclor-1254	<0.004	<0.0039	<0.004	<0.0038	<0.0041
Total Detected PCBs	ND	0.017	ND	ND	ND

Concentrations presented in milligrams per kilogram (mg/kg).

Only detected constituents are listed.

100 Exceeds the WDNR's non-industrial direct contact residual contaminant level.

100 Exceeds the WDNR's industrial direct contact residual contaminant level.

100 Exceeds the Toxic Substances Control Act disposal limit.

100 Exceeds the EPA's self-implementing high-occupancy cleanup level with no site restrictions.

< Constituent not detected above noted laboratory detection limit.

J Constituent concentration is an approximate value.

NE Criteria not established.

ND Total PCBs less than the laboratory detection limit.

PCBs Polychlorinated biphenyls.

RCL Residual contaminant level.

TSCA Toxic Substances Control Act.

EPA United States Environmental Protection Agency.

East Ex East excavation.

West Ex West excavation.

Table 1. Excavation Confirmation Soil Sample Analytical Results, Madison-Kipp Corporation, 201 Waubesa Street, Madison, Wisconsin.

Sample ID	EW-22	EW-23	EW-24	EW-25	EW-26
Sample Date	12/18/2012	12/18/2012	12/18/2012	12/18/2012	1/4/2013
Sample Location	East Ex-west side wall	East Ex-west side wall	East Ex-west side wall	East Ex-west side wall	East Ex-west side wall
Aroclor-1242	<0.0062	<0.006	<0.0059	0.044	0.072
Aroclor-1248	<0.0074	<0.0072	<0.0071	<0.008	<0.0065
Aroclor-1254	<0.0041	<0.0039	<0.0039	0.014 J	<0.0036
Total Detected PCBs	ND	ND	ND	0.058	0.072

Concentrations presented in milligrams per kilogram (mg/kg).

Only detected constituents are listed.

100 Exceeds the WDNR's non-industrial direct contact residual contaminant level.

100 Exceeds the WDNR's industrial direct contact residual contaminant level.

100 Exceeds the Toxic Substances Control Act disposal limit.

100 Exceeds the EPA's self-implementing high-occupancy cleanup level with no site restrictions.

< Constituent not detected above noted laboratory detection limit.

J Constituent concentration is an approximate value.

NE Criteria not established.

ND Total PCBs less than the laboratory detection limit.

PCBs Polychlorinated biphenyls.

RCL Residual contaminant level.

TSCA Toxic Substances Control Act.

EPA United States Environmental Protection Agency.

East Ex East excavation.

West Ex West excavation.

Table 1. Excavation Confirmation Soil Sample Analytical Results, Madison-Kipp Corporation, 201 Waubesa Street, Madison, Wisconsin.

Sample ID	EW-27	EW-28	EW-29	WB-A1	WB-A2	WB-A3
Sample Date	1/4/2013	1/4/2013	1/4/2013	12/26/2012	12/26/2012	12/26/2012
Sample Location	East Ex-west side wall	East Ex-west side wall	East Ex-west side wall	West Ex-base	West Ex-base	West Ex-base
Aroclor-1242	<0.0055	<0.0056	0.12	0.083	0.096	0.028
Aroclor-1248	0.024	0.028	<0.0067	<0.0081	<0.0081	<0.0079
Aroclor-1254	<0.0036	<0.0037	<0.0037	<0.0044	<0.0045	<0.0043
Total Detected PCBs	0.024	0.028	0.12	0.083	0.096	0.028

Concentrations presented in milligrams per kilogram (mg/kg).

Only detected constituents are listed.

100 Exceeds the WDNR's non-industrial direct contact residual contaminant level.

100 Exceeds the WDNR's industrial direct contact residual contaminant level.

100 Exceeds the Toxic Substances Control Act disposal limit.

100 Exceeds the EPA's self-implementing high-occupancy cleanup level with no site restrictions.

< Constituent not detected above noted laboratory detection limit.

J Constituent concentration is an approximate value.

NE Criteria not established.

ND Total PCBs less than the laboratory detection limit.

PCBs Polychlorinated biphenyls.

RCL Residual contaminant level.

TSCA Toxic Substances Control Act.

EPA United States Environmental Protection Agency.

East Ex East excavation.

West Ex West excavation.

Table 1. Excavation Confirmation Soil Sample Analytical Results, Madison-Kipp Corporation, 201 Waubesa Street, Madison, Wisconsin.

Sample ID	WB-A4	WB-A5	WB-B1	WB-B2	WB-B3	WB-B4	WB-B5	WB-C1
Sample Date	12/26/2012	12/26/2012	12/26/2012	12/26/2012	12/27/2012	12/27/2012	12/27/2012	12/26/2012
Sample Location	West Ex-base	West Ex-base	West Ex-base	West Ex-base	West Ex-base	West Ex-base	West Ex-base	West Ex-base
Aroclor-1242	<0.007	<0.0067	<0.0067	0.019 J	<0.0068	0.013 J	<0.0071	<0.0067
Aroclor-1248	0.023	<0.008	<0.0081	<0.0078	<0.0081	<0.008	0.31	<0.008
Aroclor-1254	<0.0046	<0.0044	<0.0044	<0.0043	<0.0044	<0.0044	<0.0047	<0.0044
Total Detected PCBs	0.023	ND	ND	0.019	ND	0.013	0.31	ND

Concentrations presented in milligrams per kilogram (mg/kg).

Only detected constituents are listed.

100 Exceeds the WDNR's non-industrial direct contact residual contaminant level.

100 Exceeds the WDNR's industrial direct contact residual contaminant level.

100 Exceeds the Toxic Substances Control Act disposal limit.

100 Exceeds the EPA's self-implementing high-occupancy cleanup level with no site restrictions.

< Constituent not detected above noted laboratory detection limit.

J Constituent concentration is an approximate value.

NE Criteria not established.

ND Total PCBs less than the laboratory detection limit.

PCBs Polychlorinated biphenyls.

RCL Residual contaminant level.

TSCA Toxic Substances Control Act.

EPA United States Environmental Protection Agency.

East Ex East excavation.

West Ex West excavation.

Table 1. Excavation Confirmation Soil Sample Analytical Results, Madison-Kipp Corporation, 201 Waubesa Street, Madison, Wisconsin.

Sample ID	WB-C2	WB-C3	WB-C4	WB-C5	WB-C5D	WB-D1	WB-D2	WB-D3
Sample Date	12/26/2012	12/27/2012	12/27/2012	12/27/2012	1/4/2013	12/26/2012	12/26/2012	12/27/2012
Sample Location	West Ex-base	West Ex-base	West Ex-base	West Ex-base	West Ex-base	West Ex-base	West Ex-base	West Ex-base
Aroclor-1242	<0.0066	<0.69	<0.069	89	<0.0068	0.017 J	<0.0065	0.066
Aroclor-1248	0.079	6.6	0.79	<3.2	<0.0082	<0.0081	0.31	<0.0086
Aroclor-1254	<0.0043	<0.45	<0.045	<1.8	<0.0045	<0.0044	<0.0043	<0.0047
Total Detected PCBs	0.079	6.6	0.79	89	ND	0.017	0.31	0.066

Concentrations presented in milligrams per kilogram (mg/kg).

Only detected constituents are listed.

100 Exceeds the WDNR's non-industrial direct contact residual contaminant level.

100 Exceeds the WDNR's industrial direct contact residual contaminant level.

100 Exceeds the Toxic Substances Control Act disposal limit.

100 Exceeds the EPA's self-implementing high-occupancy cleanup level with no site restrictions.

< Constituent not detected above noted laboratory detection limit.

J Constituent concentration is an approximate value.

NE Criteria not established.

ND Total PCBs less than the laboratory detection limit.

PCBs Polychlorinated biphenyls.

RCL Residual contaminant level.

TSCA Toxic Substances Control Act.

EPA United States Environmental Protection Agency.

East Ex East excavation.

West Ex West excavation.

Table 1. Excavation Confirmation Soil Sample Analytical Results, Madison-Kipp Corporation, 201 Waubesa Street, Madison, Wisconsin.

Sample ID	WB-D4	WB-D5	WB-E1	WB-E2	WB-E3	WB-E4	WB-E5	W-E1
Sample Date	12/27/2012	12/27/2012	12/26/2012	12/26/2012	12/27/2012	12/27/2012	12/27/2012	12/27/2012
Sample Location	West Ex-base	West Ex-base	West Ex-base	West Ex-base	West Ex-base	West Ex-base	West Ex-base	West Ex-east side wall
Aroclor-1242	<0.7	3.5	0.012 J	<0.0066	<0.0071	<0.0064	0.022	0.026
Aroclor-1248	14	<0.17	<0.0083	0.25	<0.0085	0.18	<0.0081	<0.0084
Aroclor-1254	<0.46	<0.092	<0.0046	<0.0043	<0.0047	<0.0042	<0.0044	<0.0046
Total Detected PCBs	14	3.5	0.012	0.25	ND	0.18	0.022	0.026

Concentrations presented in milligrams per kilogram (mg/kg).

Only detected constituents are listed.

100 Exceeds the WDNR's non-industrial direct contact residual contaminant level.

100 Exceeds the WDNR's industrial direct contact residual contaminant level.

100 Exceeds the Toxic Substances Control Act disposal limit.

100 Exceeds the EPA's self-implementing high-occupancy cleanup level with no site restrictions.

< Constituent not detected above noted laboratory detection limit.

J Constituent concentration is an approximate value.

NE Criteria not established.

ND Total PCBs less than the laboratory detection limit.

PCBs Polychlorinated biphenyls.

RCL Residual contaminant level.

TSCA Toxic Substances Control Act.

EPA United States Environmental Protection Agency.

East Ex East excavation.

West Ex West excavation.

Table 1. Excavation Confirmation Soil Sample Analytical Results, Madison-Kipp Corporation, 201 Waubesa Street, Madison, Wisconsin.

Sample ID	W-E2	W-E3	W-E4	W-E5	W-E6
Sample Date	12/27/2012	12/27/2012	12/27/2012	12/27/2012	12/27/2012
Sample Location	West Ex-east side wall	West Ex-east side wall	West Ex-east side wall	West Ex-east side wall	West Ex-east side wall
Aroclor-1242	<0.007	<0.0071	<1.3	<3.4	0.19
Aroclor-1248	<0.0084	<0.0085	6.6	39	<0.0081
Aroclor-1254	<0.0046	<0.0047	<0.84	<2.2	<0.0044
Total Detected PCBs	ND	ND	6.6	39	0.19

Concentrations presented in milligrams per kilogram (mg/kg).

Only detected constituents are listed.

100 Exceeds the WDNR's non-industrial direct contact residual contaminant level.

100 Exceeds the WDNR's industrial direct contact residual contaminant level.

100 Exceeds the Toxic Substances Control Act disposal limit.

100 Exceeds the EPA's self-implementing high-occupancy cleanup level with no site restrictions.

< Constituent not detected above noted laboratory detection limit.

J Constituent concentration is an approximate value.

NE Criteria not established.

ND Total PCBs less than the laboratory detection limit.

PCBs Polychlorinated biphenyls.

RCL Residual contaminant level.

TSCA Toxic Substances Control Act.

EPA United States Environmental Protection Agency.

East Ex East excavation.

West Ex West excavation.

Table 1. Excavation Confirmation Soil Sample Analytical Results, Madison-Kipp Corporation, 201 Waubesa Street, Madison, Wisconsin.

Sample ID	W-E7	W-E8	W-E9	W-E10	W-N1
Sample Date	12/27/2012	12/27/2012	1/4/2013	1/4/2013	12/26/2012
Sample Location	West Ex-east side wall	West Ex-east side wall	West Ex-east side wall	West Ex-east side wall	West Ex-north side wall
Aroclor-1242	0.11	<0.0056	0.16	<0.0069	<0.0067
Aroclor-1248	<0.0083	0.026	<0.0076	0.28	0.15
Aroclor-1254	<0.0046	<0.0037	<0.0041	<0.0045	<0.0044
Total Detected PCBs	0.11	0.026	0.16	0.28	0.15

Concentrations presented in milligrams per kilogram (mg/kg).

Only detected constituents are listed.

100 Exceeds the WDNR's non-industrial direct contact residual contaminant level.

100 Exceeds the WDNR's industrial direct contact residual contaminant level.

100 Exceeds the Toxic Substances Control Act disposal limit.

100 Exceeds the EPA's self-implementing high-occupancy cleanup level with no site restrictions.

< Constituent not detected above noted laboratory detection limit.

J Constituent concentration is an approximate value.

NE Criteria not established.

ND Total PCBs less than the laboratory detection limit.

PCBs Polychlorinated biphenyls.

RCL Residual contaminant level.

TSCA Toxic Substances Control Act.

EPA United States Environmental Protection Agency.

East Ex East excavation.

West Ex West excavation.

Table 1. Excavation Confirmation Soil Sample Analytical Results, Madison-Kipp Corporation, 201 Waubesa Street, Madison, Wisconsin.

Sample ID	W-N2	W-N3	W-N4	W-N5	W-N6
Sample Date	12/26/2012	12/26/2012	12/26/2012	12/26/2012	12/26/2012
Sample Location	West Ex-north side wall	West Ex-north side wall	West Ex-north side wall	West Ex-north side wall	West Ex-north side wall
Aroclor-1242	2.2	0.018 J	0.032	0.036	0.14
Aroclor-1248	<0.15	<0.0079	<0.008	<0.0081	<0.0078
Aroclor-1254	<0.084	<0.0043	<0.0044	<0.0044	<0.0043
Total Detected PCBs	2.2	0.018	0.032	0.036	0.14

Concentrations presented in milligrams per kilogram (mg/kg).

Only detected constituents are listed.

100 Exceeds the WDNR's non-industrial direct contact residual contaminant level.

100 Exceeds the WDNR's industrial direct contact residual contaminant level.

100 Exceeds the Toxic Substances Control Act disposal limit.

100 Exceeds the EPA's self-implementing high-occupancy cleanup level with no site restrictions.

< Constituent not detected above noted laboratory detection limit.

J Constituent concentration is an approximate value.

NE Criteria not established.

ND Total PCBs less than the laboratory detection limit.

PCBs Polychlorinated biphenyls.

RCL Residual contaminant level.

TSCA Toxic Substances Control Act.

EPA United States Environmental Protection Agency.

East Ex East excavation.

West Ex West excavation.

Table 1. Excavation Confirmation Soil Sample Analytical Results, Madison-Kipp Corporation, 201 Waubesa Street, Madison, Wisconsin.

Sample ID	W-N7	W-N8	W-N9	W-N10	W-S1
Sample Date	12/26/2012	12/26/2012	12/26/2012	12/26/2012	12/27/2012
Sample Location	West Ex-north side wall	West Ex-north side wall	West Ex-north side wall	West Ex-north side wall	West Ex-south side wall
Aroclor-1242	1.1	<0.0064	<0.0065	<0.0067	<0.0066
Aroclor-1248	<0.078	<0.0077	0.01 J	<0.008	<0.0079
Aroclor-1254	<0.043	<0.0042	<0.0043	<0.0044	<0.0043
Total Detected PCBs	1.1	ND	0.01	ND	ND

Concentrations presented in milligrams per kilogram (mg/kg).

Only detected constituents are listed.

100 Exceeds the WDNR's non-industrial direct contact residual contaminant level.

100 Exceeds the WDNR's industrial direct contact residual contaminant level.

100 Exceeds the Toxic Substances Control Act disposal limit.

100 Exceeds the EPA's self-implementing high-occupancy cleanup level with no site restrictions.

< Constituent not detected above noted laboratory detection limit.

J Constituent concentration is an approximate value.

NE Criteria not established.

ND Total PCBs less than the laboratory detection limit.

PCBs Polychlorinated biphenyls.

RCL Residual contaminant level.

TSCA Toxic Substances Control Act.

EPA United States Environmental Protection Agency.

East Ex East excavation.

West Ex West excavation.

Table 1. Excavation Confirmation Soil Sample Analytical Results, Madison-Kipp Corporation, 201 Waubesa Street, Madison, Wisconsin.

Sample ID	W-S2	W-S3	W-S4	W-S5	W-S6
Sample Date	12/27/2012	12/27/2012	12/27/2012	12/27/2012	12/27/2012
Sample Location	West Ex-south side wall	West Ex-south side wall	West Ex-south side wall	West Ex-south side wall	West Ex-south side wall
Aroclor-1242	<0.0066	0.085	0.02	<0.0056	0.066
Aroclor-1248	<0.008	<0.0083	<0.0072	<0.0068	<0.0076
Aroclor-1254	<0.0044	<0.0046	<0.0039	<0.0037	<0.0042
Total Detected PCBs	ND	0.085	0.02	ND	0.066

Concentrations presented in milligrams per kilogram (mg/kg).

Only detected constituents are listed.

100 Exceeds the WDNR's non-industrial direct contact residual contaminant level.

100 Exceeds the WDNR's industrial direct contact residual contaminant level.

100 Exceeds the Toxic Substances Control Act disposal limit.

100 Exceeds the EPA's self-implementing high-occupancy cleanup level with no site restrictions.

< Constituent not detected above noted laboratory detection limit.

J Constituent concentration is an approximate value.

NE Criteria not established.

ND Total PCBs less than the laboratory detection limit.

PCBs Polychlorinated biphenyls.

RCL Residual contaminant level.

TSCA Toxic Substances Control Act.

EPA United States Environmental Protection Agency.

East Ex East excavation.

West Ex West excavation.

Table 1. Excavation Confirmation Soil Sample Analytical Results, Madison-Kipp Corporation, 201 Waubesa Street, Madison, Wisconsin.

Sample ID	W-S7	W-S8	W-S9	W-S10	W-W1
Sample Date	12/27/2012	12/27/2012	12/27/2012	12/27/2012	12/26/2012
Sample Location	West Ex-south side wall	West Ex-south side wall	West Ex-south side wall	West Ex-south side wall	West Ex-west side wall
Aroclor-1242	0.02	0.13	1.9	<0.0066	0.07
Aroclor-1248	<0.0069	<0.0078	<0.083	<0.0079	<0.0081
Aroclor-1254	<0.0038	<0.0043	<0.045	<0.0043	<0.0044
Total Detected PCBs	0.02	0.13	1.9	ND	0.07

Concentrations presented in milligrams per kilogram (mg/kg).

Only detected constituents are listed.

100 Exceeds the WDNR's non-industrial direct contact residual contaminant level.

100 Exceeds the WDNR's industrial direct contact residual contaminant level.

100 Exceeds the Toxic Substances Control Act disposal limit.

100 Exceeds the EPA's self-implementing high-occupancy cleanup level with no site restrictions.

< Constituent not detected above noted laboratory detection limit.

J Constituent concentration is an approximate value.

NE Criteria not established.

ND Total PCBs less than the laboratory detection limit.

PCBs Polychlorinated biphenyls.

RCL Residual contaminant level.

TSCA Toxic Substances Control Act.

EPA United States Environmental Protection Agency.

East Ex East excavation.

West Ex West excavation.

Table 1. Excavation Confirmation Soil Sample Analytical Results, Madison-Kipp Corporation, 201 Waubesa Street, Madison, Wisconsin.

Sample ID	W-W2	W-W3	W-W4	W-W5	W-W6
Sample Date	12/26/2012	12/26/2012	12/26/2012	12/26/2012	12/26/2012
Sample Location	West Ex-west side wall	West Ex-west side wall	West Ex-west side wall	West Ex-west side wall	West Ex-west side wall
Aroclor-1242	0.89	0.064	<0.0065	0.19	0.034
Aroclor-1248	<0.079	<0.0078	<0.0078	<0.0082	<0.0078
Aroclor-1254	<0.043	<0.0042	<0.0043	<0.0045	<0.0043
Total Detected PCBs	0.89	0.064	ND	0.19	0.034

Concentrations presented in milligrams per kilogram (mg/kg).

Only detected constituents are listed.

100 Exceeds the WDNR's non-industrial direct contact residual contaminant level.

100 Exceeds the WDNR's industrial direct contact residual contaminant level.

100 Exceeds the Toxic Substances Control Act disposal limit.

100 Exceeds the EPA's self-implementing high-occupancy cleanup level with no site restrictions.

< Constituent not detected above noted laboratory detection limit.

J Constituent concentration is an approximate value.

NE Criteria not established.

ND Total PCBs less than the laboratory detection limit.

PCBs Polychlorinated biphenyls.

RCL Residual contaminant level.

TSCA Toxic Substances Control Act.

EPA United States Environmental Protection Agency.

East Ex East excavation.

West Ex West excavation.

Table 1. Excavation Confirmation Soil Sample Analytical Results, Madison-Kipp Corporation, 201 Waubesa Street, Madison, Wisconsin.

Sample ID	W-W7	W-W8
Sample Date	12/26/2012	12/26/2012
Sample Location	West Ex-west side wall	West Ex-west side wall
Aroclor-1242	<0.0065	<0.0065
Aroclor-1248	<0.0078	<0.0078
Aroclor-1254	<0.0043	<0.0043
Total Detected PCBs	ND	ND

Concentrations presented in milligrams per kilogram (mg/kg).

Only detected constituents are listed.

100 Exceeds the WDNR's non-industrial direct contact residual contaminant level.

100 Exceeds the WDNR's industrial direct contact residual contaminant level.

100 Exceeds the Toxic Substances Control Act disposal limit.

100 Exceeds the EPA's self-implementing high-occupancy cleanup level with no site restrictions.

< Constituent not detected above noted laboratory detection limit.

J Constituent concentration is an approximate value.

NE Criteria not established.

ND Total PCBs less than the laboratory detection limit.

PCBs Polychlorinated biphenyls.

RCL Residual contaminant level.

TSCA Toxic Substances Control Act.

EPA United States Environmental Protection Agency.

East Ex East excavation.

West Ex West excavation.

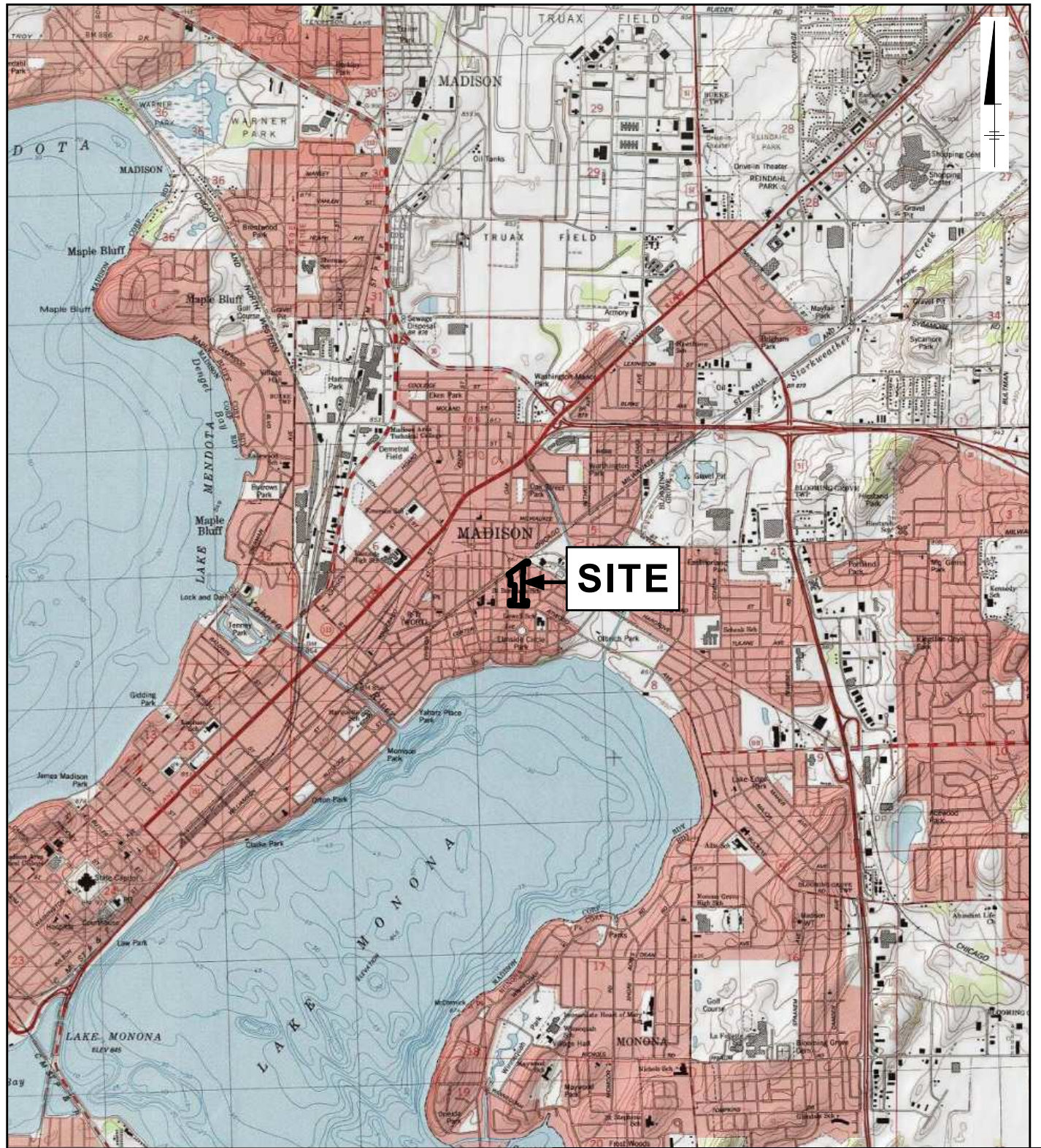

WISCONSIN

SITE LOCATION

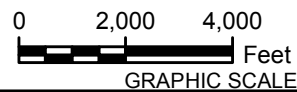

NOTE:
TOPO BASE MAP OBTAINED FROM
ESRI ONLINE MAPPING, USING
ARCMAP 10 ACCESSED 4/3/2013

MADISON-KIPP CORPORATION
201 WAUBESA STREET
MADISON, WISCONSIN

SITE LOCATION MAP



FIGURE
1

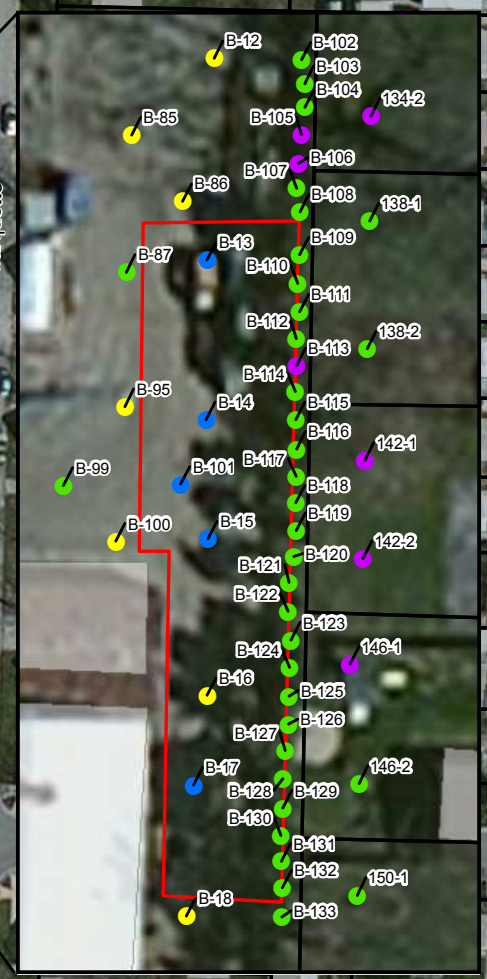

LEGEND

CONCENTRATION OF PCBs (0-2 FEET BELOW GROUND SURFACE)

- NON-DETECT
- LESS THAN OR EQUAL TO 1 mg/kg
- GREATER THAN 1 mg/kg
- GREATER THAN 50 mg/kg

PROPOSED EXCAVATION AREA

PARCELS

BUILDING FOOTPRINTS

mg/kg MILLIGRAM PER KILOGRAM
 PCBs POLYCHLORINATED BIPHENYL

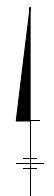
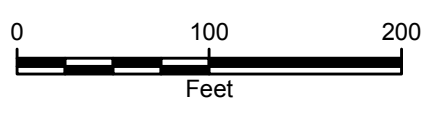

NOTES:
 1. LOCATION OF RESIDENTIAL SAMPLES ARE APPROXIMATE
 2. AERIAL IMAGERY OBTAINED FROM BING IMAGERY
 SERVICE THROUGH ESRI ONLINE MAPPING, ACCESSED 8/27/12

MADISON-KIPP
 201 WAUBESA STREET
 MADISON, WI

**PROPOSED EXCAVATION AREA
 (0-2 FEET BELOW GROUND SURFACE)**



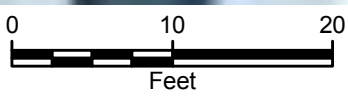

- LEGEND**
- PREVIOUS SOIL SAMPLE LOCATION
 - BASE SAMPLE LOCATION
 - SIDEWALL SAMPLE LOCATION
 - APPROXIMATE EAST EXCAVATION AREA



NOTE:
 AERIAL IMAGERY PROVIDED BY ARCGIS ONLINE USING
 ARCMAP 10 ON 4/4/2013.

MADISON-KIPP CORPORATION
 201 WAUBESA STREET
 MADISON, WISCONSIN

EAST EXCAVATION AREA





CITY: MIKE DIV\GROUP: IM DB: EH LD: CK
 MADISON-KIPP
 I:\Madison_Kipp\Madison_Kipp\2013\Fig4_WestExcavationArea.mxd

- LEGEND**
- BASE SAMPLE LOCATION
 - SIDEWALL SAMPLE LOCATION
 - APPROXIMATE WEST EXCAVATION AREA

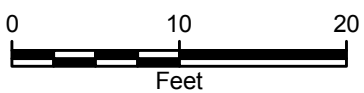

NOTES:
 1. AERIAL IMAGERY PROVIDED BY BING ARCGIS ONLINE
 USING ARCMAP 10 ON 4/3/2013.



MADISON-KIPP CORPORATION
 201 WAUBESA STREET
 MADISON, WISCONSIN

WEST EXCAVATION AREA



FIGURE
4