

04-05-385892

State of Wisconsin Substance Release Notification Form

24 Hour Emergency Hotline Number: 1-800-943-0003

LE Form

Date & Mil. Time of Incident: 12/14/2000 0950 time of discovery <i>12-13+14-00</i>		Date & Mil. Time Reported 12/14/2000 1050		Spill File # ner12142000_01	
Person Reporting/Representing: George Buttke				Phone # (920) 430-3898	
Responsible Party/Spiller Procter and Gamble Co.				Phone # ()	
Contact Name George Buttke				Phone # ()	
Address P.O. Box 8020			City, State, Zip Code Green Bay WI 54308-8020		
Substance Involved Regal Oil - Texeco Product/Mineral Oil		Amount & Units Released <i>600 gal</i> 700 gallons of (70 gallons was Regal Oil)		Amount Recovered <i>majority</i> unknown, full recovery expected	
<input type="checkbox"/> Solid <input type="checkbox"/> Semisolid <input checked="" type="checkbox"/> Liquid <input type="checkbox"/> Gas Color: milk white Odor: sweet smell <input type="checkbox"/> Solid <input type="checkbox"/> Semisolid <input checked="" type="checkbox"/> Liquid <input type="checkbox"/> Gas Color: milk white Odor: sweet smell <i>70 gallons Regal oil</i>					
Exact Location (Inc. address, facility name, mileage, bldg. #, etc) Fox River Plant 501 Eastman Ave. in crawl space of sub-basement in building 43					
City Green Bay		County Brown		Lat/Long	
DNR Region NER		___ 1/4 ___ 1/4 sec ___ NR ___ (E/W)		Weather Cond.	
Cause of Incident: Leaky drain line. Containment/cleanup has been begun by P & G personnel. A contractor (not known which one yet) will be called in to remove contaminated soil.				Action Taken by Spiller: <input type="checkbox"/> No Action Taken <input type="checkbox"/> No Action Needed <input checked="" type="checkbox"/> Monitor <input checked="" type="checkbox"/> Cleanup Method: vacuum truck <input checked="" type="checkbox"/> Waste Destination: waste water sewer then to Green Bay Met. <input checked="" type="checkbox"/> Containment <input checked="" type="checkbox"/> Contractor Hired Name: Stordeur Sanitation <input type="checkbox"/> Other:	
Spilled Substance Impact To: Check () all that apply: <input type="checkbox"/> Air <input type="checkbox"/> Potential <input checked="" type="checkbox"/> Soil <input checked="" type="checkbox"/> Potential <input type="checkbox"/> Groundwater <input checked="" type="checkbox"/> Potential <input type="checkbox"/> Surface Water <input type="checkbox"/> Potential Name: <input type="checkbox"/> Storm Sewer <input type="checkbox"/> Potential <input checked="" type="checkbox"/> Sanitary Sewer <input checked="" type="checkbox"/> Potential <input type="checkbox"/> Concrete/Asphalt <input type="checkbox"/> Potential <input type="checkbox"/> Private Well <input type="checkbox"/> Potential <input checked="" type="checkbox"/> Contained/Recovered <input type="checkbox"/> Other:		Spill Source: <input type="checkbox"/> Transportation Accident, Fuel Tank Spill <input type="checkbox"/> Transportation Accident, Load Spill <input checked="" type="checkbox"/> Industrial Facility <input type="checkbox"/> Paper Mill <input type="checkbox"/> Chemical Co. <input type="checkbox"/> Ag Coop/Facility/Food Factory/Facility <input type="checkbox"/> Gas/Service Station/Garage/Auto Dealer/Repair Shop <input type="checkbox"/> Pipeline/Terminal/Tank Farm/Oil Jobber/Wholesaler <input type="checkbox"/> Public Property (city, state, church, school, etc.) <input type="checkbox"/> Utility Co. Power Generating/Transfer Facility <input type="checkbox"/> Private Property (home/farm) <input type="checkbox"/> Construction, Evacuation, Wrecking, Quarry, Mine <input type="checkbox"/> Airport Facility <input type="checkbox"/> Railroad Facility <input type="checkbox"/> Other:			
Injuries? <input type="checkbox"/> Yes <input checked="" type="checkbox"/> No If yes how many?		Has an evacuation occurred? <input type="checkbox"/> Yes <input checked="" type="checkbox"/> No Potential? <input type="checkbox"/> Yes <input checked="" type="checkbox"/> No			
Are there any resource damages? <input type="checkbox"/> Yes <input checked="" type="checkbox"/> No <input checked="" type="checkbox"/> Potential? What kinds? Soil					
Other agencies notified (check first column if notified) check both columns if on the scene <input type="checkbox"/> Fire Department <input checked="" type="checkbox"/> Local DNR <input type="checkbox"/> EPA <input type="checkbox"/> Local Law Enforcement <input type="checkbox"/> Div. Emerg. Mgt. <input type="checkbox"/> Nat'l Resp Ctr 800-442-8802 <input type="checkbox"/> LEPC or Local Emer. Mgt. <input type="checkbox"/> Coast Guard <input type="checkbox"/> Chemtrec 800-424-9300 <input type="checkbox"/> Level A/Level B Team <input type="checkbox"/> DHFS 608-258-0099 <input type="checkbox"/> Other:				Incident Commander, if known:	
Prepared by: Tom Collier		Phone: 608-261-4939		Date: 12/14/2000	
Person Notified: Darren D. Kuhn		Phone: 920-492-5599		Date: 12/14/2000	
Investigated by: Darren D. Kuhn		Sign <i>Darren D. Kuhn</i>		Date 12/14/00	
Spill Coordinator Signoff: <i>[Signature]</i>		Date: 11-27-02		Incident Closed? <input checked="" type="checkbox"/> Yes <input type="checkbox"/> No Date: 12/14/00 NFA Letter Sent? <input type="checkbox"/> Yes <input checked="" type="checkbox"/> No Spill Packet Sent? <input checked="" type="checkbox"/> Yes <input type="checkbox"/> No To: hand delivered to George Buttke	
Transferred to: ERP <input type="checkbox"/>		DATCP <input type="checkbox"/> Date:		Case # <i>NO</i>	

☒ Additional Comments on ReverseVBH
1/2/01

Procter & Gamble

The Procter & Gamble Paper Products Company

East River Plant
P.O. Box 8010 - Green Bay, Wisconsin 54308-8010

Fox River Plant
P.O. Box 8020 - Green Bay, Wisconsin 54308-8020

December 21, 2000

Ms. Roxanne Chronert
Spill Coordinator
Wisconsin Dept. of Natural Resources
P.O. Box 10448
Green Bay, WI 54307-0448



Subject: December 14, 2000 Release at The Procter & Gamble Paper Products Co., 501 Eastman Ave., Green Bay, WI

Dear Ms. Chronert;

The following is submitted to the Department subsequent to the reporting of the above referenced release at Procter & Gamble. The material in question was a proprietary mixture referred to as emulsion. The primary constituent of this mixture, other than water, is a lightweight mineral oil, which goes by the trade name of Regal Oil.

Over the period of December 13-14, 2000, Procter & Gamble accidentally discharged an estimated 600 gallons of this mixture, containing approximately 70 gallons of regal oil into the sub-basement of one of our buildings. The source of the discharge was a floor drain which was under construction, but had not been tagged as inoperable. The drain penetrated the floor, but was not yet connected to the plant sewer system.

It is important to note that this release occurred within one of our buildings, but was reported to the Department because the sub-basement, which is essentially a crawl space, has a dirt floor. See the attached site map for a location of the release relative to our building locations and property boundary.

Upon entry into the sub-basement, Procter & Gamble discovered that the material had collected on the relatively impervious dirt floor. Stordeur Sanitation was brought in with vacuum trucks to clean up the release. All recovered material was discharged on-site to our process sewer served by the Green Bay Metropolitan Sewerage District.

At this time, Procter & Gamble has determined the area is restored to prior condition based on a visual inspection and believes no further action is warranted. Procter & Gamble would appreciate confirmation of the Department's concurrence with this assessment through a closeout letter and/or copy of the final incident report indicating no further action required.

Sincerely,

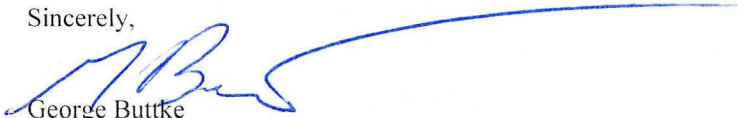
George Buttke
Site Environmental Leader
The Procter & Gamble Paper Products Co.
(920) 430-3898

enclosures

State of Wisconsin Substance Release Report (Con't)
Form 4401-91 Rev. 2-99

Date and Military Time of Incident: 12/14/00 0945 hours

Responsible Party: Procter&Gamble

Additional Comments:

On December 14, 2000, Conservation Warden Darren Kuhn was on duty patrolling Brown County, WI. Warden Kuhn was dressed in full winter uniform and on patrol in a State issued squad truck. Warden Kuhn was accompanied by student intern Nick Haese. At about 11:45am Warden Kuhn received a telephone call from the Department of Natural Resources (DNR) Spill Hotline. The hotline operator advised Warden Kuhn that Procter&Gambel Fox River Plant had experienced a spill. The operator further advised that due to a leaking drain line about 70 gallons of mineral oil had been discharged on the dirt floor of a crawl space in a sub-basement of the plant. The operator provided Warden Kuhn with George Buttke's phone number and the address of the Fox River Plant. Buttke is the Environmental Specialist at the Fox River Plant. At the time of the call Warden Kuhn was down town Green Bay, only a short distance away from the plant. Warden Kuhn responded to the spill. While en route Warden Kuhn telephoned Buttke. Warden Kuhn left a voice message for Buttke.

At about 12:02pm Warden Kuhn arrived at the Fox River Plant. Warden Kuhn entered the security building at the south gate. Warden Kuhn explained to the security guard that Warden Kuhn needed to speak with Buttke re: the spill. The security guard did not know anything about the spill. The security guard telephoned Buttke and did not get an answer. The security guard then paged Buttke. A short time later Buttke called the security guard. The security guard advised Buttke that Warden Kuhn was waiting to talk to Buttke. Buttke advised the security guard that Buttke would meet Warden Kuhn at the security station.

A short time later Buttke entered the security station. Buttke explained that the plant had experienced a discharge of mineral oil on the compacted dirt floor in a crawl space in a sub-basement. Buttke explained that the situation was under control. Warden Kuhn returned to his squad and told intern Haese to sign in at the security gate so he could observe the interview. While intern Haese signed in Warden Kuhn parked his squad in the 2-hour parking lot, gathered two pairs of safety glasses and a spill form. Warden Kuhn returned to the security station.

Buttke escorted Warden Kuhn and intern Haese into a conference room. Buttke explained that Procter&Gamble was installing a new section of drain pipe that was going to be tied into the main system. During the construction the drain pipe had been capped to prevent any use. Buttke explained that an unknown party had removed the cap and used the drain pipe resulting in the discharge of the mineral oil. The mineral oil was a Texaco product known as Regal Oil. The oil was used to aid in the removal of the paper from the rollers during production. Buttke explained that the oil was mixed with water and some other substances. In total about 700 gallons of the solution was discharged of which about 70 gallons was the oil. Buttke explained that the solution was pooled in a crawl space in a sub-basement of building 43. Buttke stated that due to the compacted dirt floor it had not appeared that any of the solution that seeped into the soil. Buttke further explained that none of the solution had escaped the crawl space. Buttke stated that Procter&Gamble had hired Stordeur Sanitation to vacuum the solution up using a vacuum truck. Buttke then explained that the solution would then be pumped into the Procter&Gamble waste water sewer and then to Green Bay Metropolitan Sewage District. Buttke explained that Procter&Gamble has a contract with Green Bay Met to discard this solution at Green Bay Met and this is how this oil solution is commonly discarded. Warden Kuhn asked to see the discharge area. Buttke explained that due to the fact that the only way for a person to enter the crawl space would be to be to put on a safety harness and be lowered down a man hole that seeing the discharge site would be a hassle. Warden Kuhn agreed and advised Buttke that Warden Kuhn did not need to see the discharge site. Buttke explained that the spill was very minor but Procter&Gamble did not want to get in trouble for not reporting the discharge. Warden Kuhn provided Buttke with a Responsible Party Spill Packet. Throughout the conversation Warden Kuhn was taking notes on a spill form. Buttke asked if Buttke could have a copy of the spill report notes. Warden Kuhn provided the notes and Buttke made a photo copy. Warden Kuhn explained that the notes were merely notes and that Warden Kuhn would be preparing a formal report when time permitted. Buttke requested a copy of the formal report. Warden Kuhn advised Buttke that Buttke could get a copy of the report from Roxanne Nelezen Chronert.

Warden Kuhn thanked Buttke for the information and reporting the discharge. At about 12:30pm Warden Kuhn and intern Haese were escorted out of the plant and cleared from Procter&Gamble.

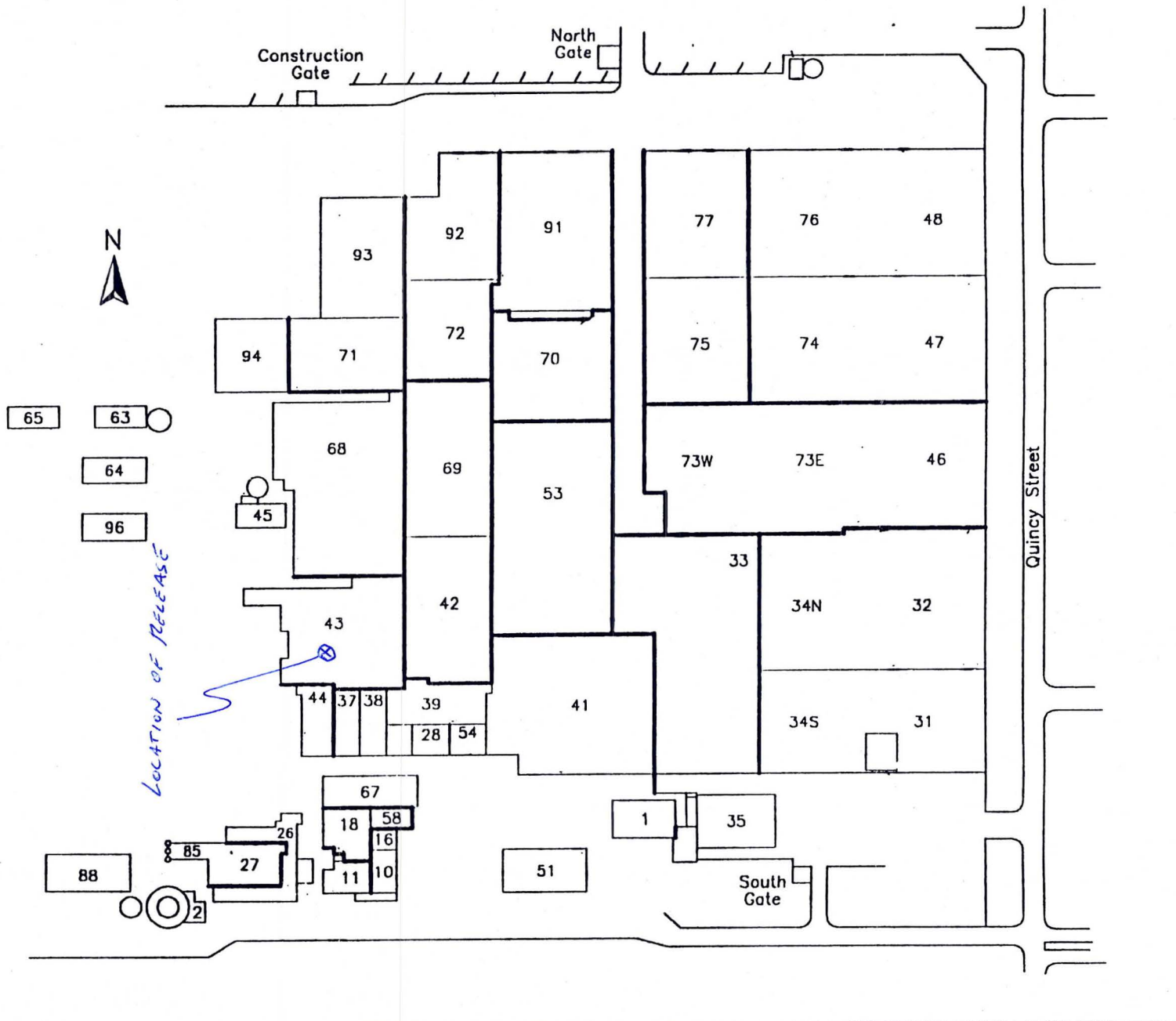

Procter & Gamble - Fox River Plant Site Plan

STORDEUR SANITATION

Commercial and Residential Liquid Waste Removal

PHONE 434-2888

1455 CORNELL RD.
GREEN BAY, WI 54313

75666

WISCONSIN
SANITARY LICENSEE
LIC. NO. 704

12-14 2001

Procter + Gamble

Fox River Plant

Green Bay WI

TERMS: NET 30 DAYS 1% SERVICE CHARGE PER MONTH AFTER 30 DAYS.
WHICH IS AN ANNUAL PERCENTAGE RATE OF 12%.

LOCATION	DESCRIPTION	AMOUNT
----------	-------------	--------

JOB LOCATION: PO# 4500775247

Post-it® Fax Note 7671		Date 12-21-00	# of pages 1
To: Ken Butke	From: STORDEUR Sanitation		
Co: Procter + Gamble	Co: Mary		
Phone #	Phone # 920-434-2888		
Fax # 920-430-2109	Fax # 920-434-8977		

✓ pump spill 1130 AM to 600 PM
in Basement
Ken Don truck #12

PLEASE SEE ATTACHMENT

\$ 904.00

Sign Here X _____

PAY FROM THIS INVOICE

Procter & Gamble
ATTN: INVOICE APPROVAL
P.O. Box 8020
Green Bay, WI 54308-8020

PO# 4500775247

Per Curt Kobielalk

Clean up spill

11:30 a.m. to 3:00 p.m.

Vac Trk # 12 w/oper (Ken)
3.50 hrs. @ \$ 104.00 per hr \$ 364.00

Laborer (Don)
3.50 hrs. @ \$ 24.00 per hr \$ 84.00

OVERTIME RATES APPLY
3:00 p.m. to 6:00 p.m.

Vac Trk # 12 w/oper (Ken)
3 hrs. @ \$ 116.00 per hr \$ 348.00

Laborer (Don)
3 hrs. @ \$ 36.00 per hr \$ 108.00

TOTAL \$ 904.00