

Klauk, Robert H - DNR

From: Brian Youngwirth <byoungwirth@generalengineering.net>
Sent: Tuesday, August 16, 2016 7:10 AM
To: Klauk, Robert H - DNR
Subject: Vandeurzen
Attachments: Subslab Vapor Testing.xls

Bob, here is a revised table for the vapor sampling at Vandeurzen. I had the indoor air standards in the initial table. Do you know when you will be reviewing the information?

Brian Youngwirth
Environmental Project Manager | General Engineering Company
916 Silver Lake Drive | PO Box 340 | Portage, WI 53901
P 608-742-2169 | Fax 608-742-2592 | C 608-697-8010
byoungwirth@generalengineering.net
www.generalengineering.net

TABLE 4
SUMMARY OF SUB-SLAB VAPOR SOIL ANALYTICAL RESULTS
VAN DEURZEN CLEANERS
2-0614-154

TABLE 1 REGIONAL SCREENING LEVEL SUMMARY												
Sample No.	Non-Residential		VP-1			VP-2			VP-4			VP-5
Sampling Date			10/06/14	03/09/15	05/19/16	10/06/14	03/09/15	05/19/16	10/06/14	03/09/15	05/19/16	05/19/16
	ppbV	ug/m3										
VOLATILE ORGANIC COMPOUNDS (VOC) (ug/m3)												
Benzene	37	120	<5.1	<1.3	0.661	3.2	0.67		2.7	<1.3	0.986	27
Chloroform	8	40	54	45	<0.930	2.0	1.2		4.5	5.4	<0.930	1.22
1,1 Dichloroethane	150	600	<6.4	<1.6	<0.685	1.1	<0.80		<0.80	<1.6	<0.685	<0.685
1,1-Dichloroethene	1700	7000	270	190	<0.646	7.5	9.5		230	230	41.9	<0.646
cis-1,2-Dichloroethene	NE	NE	440	230	6.99	38	27		240	180	207	<0.515
trans-1,2-Dichloroethene	NE	NE	33	22	0.883	19	9.1		48	26	5.24	<0.614
Ethylbenzene	83	370	<6.9	<1.7	1.33	4.0	<0.87		4.8	<1.7	3.11	12.5
Trichlorofluoromethane	NE	NE	<9.0	<2.2	2.44	2.6	1.3		2.6	<2.2	1.51	1.95
Dichlorodifluoromethane	670	3300	<7.9	2.5	1.73	1.3	2.4		1.3	2.6	1.55	1.64
Heptane	NE	NE	<6.5	<1.6	<0.855	2.7	<0.82		6.5	1.9	0.912	16.9
Methylene Chloride	6000	21000	<5.6	<1.4	14.8	1.8	<0.69		1.5	<1.4	79.5	36
Naphthalene	5.3	28	52	<6.6	<2.69	<3.3	<3.3		<3.3	<6.6	<2.69	<2.69
Tetrachloroethylene	210	1400	8800	8100	35.4	3100	1100		6000	8800	1500	410
Toluene	47000	170000	11	6.0	4.07	14	4.9		15	11	10.4	50.6
1,1,1-Trichloroethane	31000	170000	<8.7	<2.2	<1.21	1.6	<1.1		4.9	7.6	<1.21	<1.21
Trichloroethylene	13	70	1800	2000	13.1	530	320		1400	2200	355	22.9
1,2,4-Trimethylbenzene	50	240	<7.9	<2.0	7.65	3.8	1.4		6.4	2.5	8.67	21.5
1,3,5-Trimethylbenzene	NE	NE	<7.9	<2.0	1.43	1.1	<0.98		2.3	<2.0	1.52	4.46
Vinyl chloride	22	57	<4.1	1.2	<1.06	<0.51	<0.51		3.1	9.2	79.7	<0.389
m&p-Xylene	770	3300	<14	<3.5	11.1	9.1	2.3		10	4.8	11.3	399
o-Xylene	770	3300	<6.9	<1.7	2.54	4.0	<0.87		4.8	1.7	4.24	12.3
TPH (GC/MS)	NE	NE	9100	4500	--	1900	2600		3800	5400	--	--

UG/M³ Micrograms per Cubic Meter of Air

Bold indicates analytical results exceed Indoor Vapor Action Levels November 2012

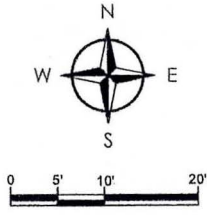

EXPLANATION	
MW-2	MONITORING WELL / SOIL BORING LOCATION
TW-9	TEMPORARY WELL / GEOPROBE LOCATION
VP-1	VAPOR TESTING LOCATIONS
SUMP	SUMP LOCATION

GEORGE ST. (CTH "G")

S. ONTARIO ST.

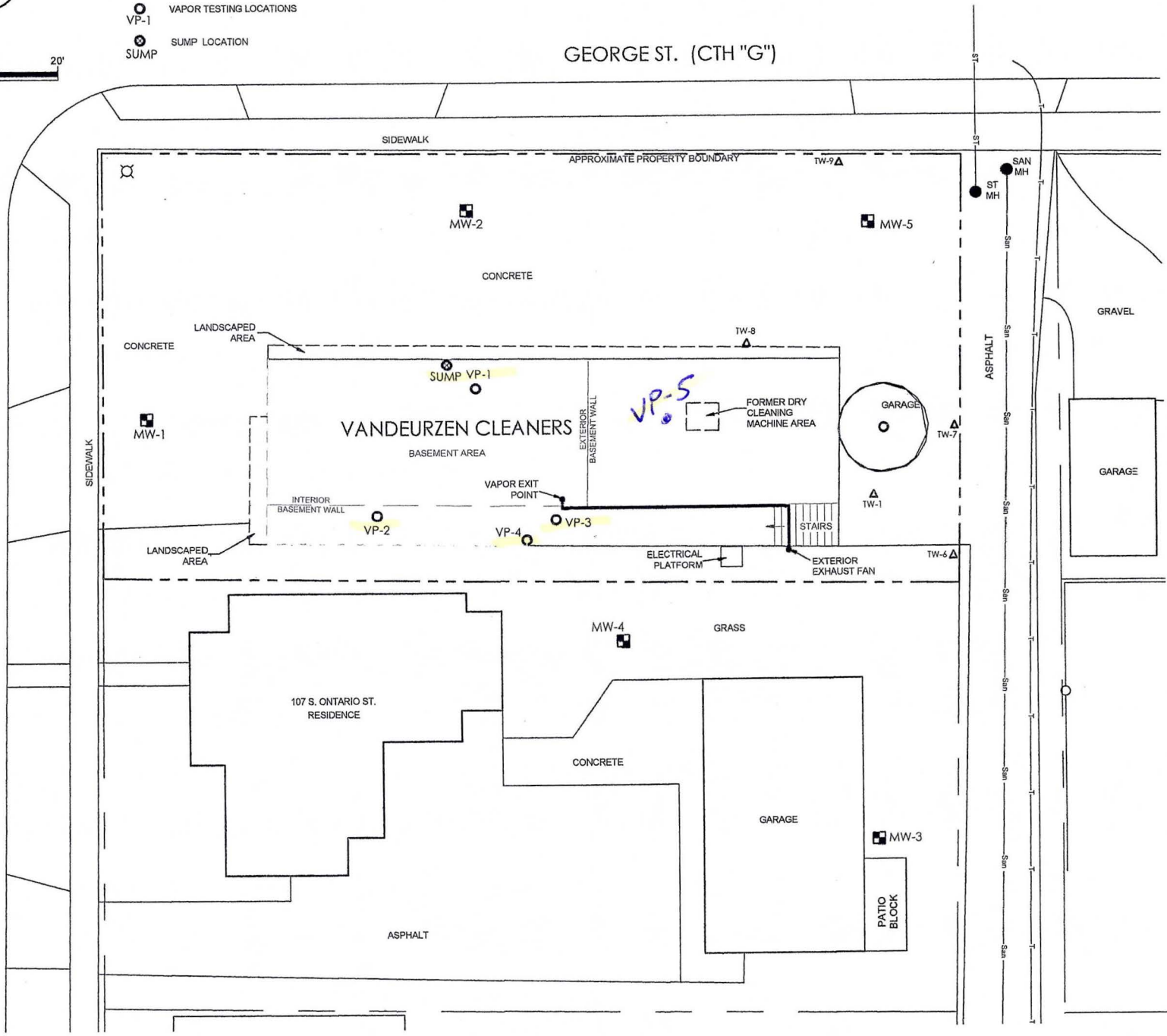

DRAWN BY	KP
DATE	9/7/15
GEC FILE NO.	2-0614-154
SHEET NO.	

SITE PLAN

VANDEURZEN CLEANERS

City of De Pere

General Engineering Company

P.O. Box 340 • 916 Silver Lake Dr. • Portage, WI 53901
 608-742-2168 (Office) • 608-742-2592 (Fax)
 www.generalengineering.net

This document contains confidential or proprietary information of General Engineering Company.

REVISIONS	NO.	BY	DATE
status update			